



97 HIGH ASH DRIVE
LEEDS, LS17 8RD

£395,000
FREEHOLD

Monroe is delighted to showcase this exceptional opportunity situated on High Ash Drive, in the heart of Alwoodley. This fantastic bungalow boasts two spacious bedrooms and a beautifully kept garden, making it an ideal choice for those looking to downsize in this highly sought-after location.

MONROE

SELLERS OF THE FINEST HOMES

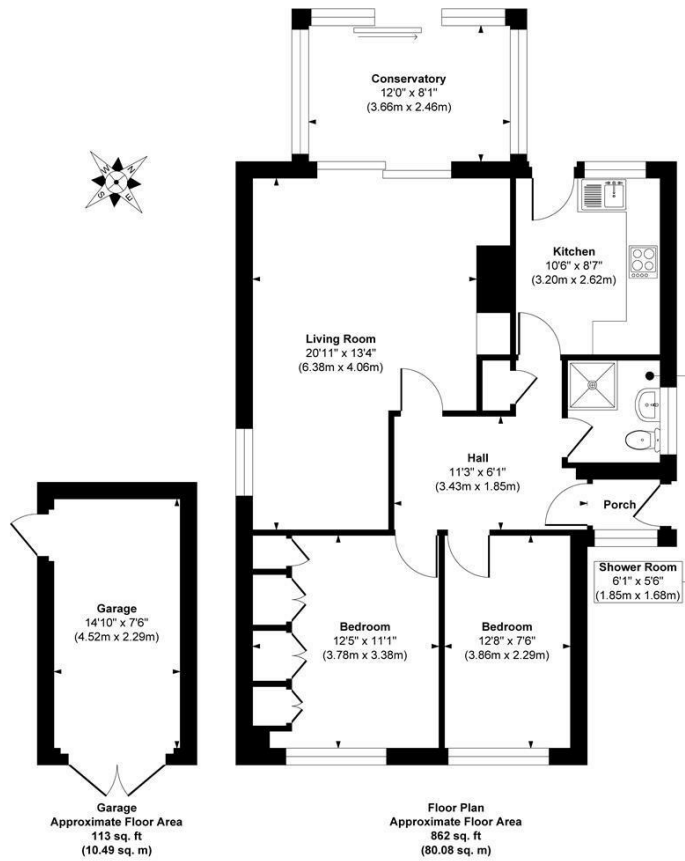

Approx. Gross Internal Floor Area 975 sq. ft / 90.57 sq. m (Including Garage)

Illustration for identification purposes only, measurements are approximate, not to scale.

Copyright © Zenith Creations.

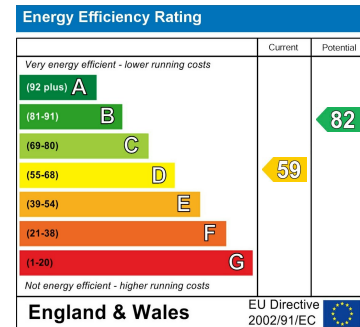

Agents Note: Whilst every care has been taken to prepare these particulars, they are for guidance purposes only. All measurements are approximate and are for general guidance purposes only and whilst every care has been taken to ensure their accuracy, they should not be relied upon and potential buyers/tenants are advised to recheck the measurements

Alwoodley Sales
1-3 The Avenue
Alwoodley
Leeds
West Yorkshire
LS17 7BD

0113 870 4443
hello@monroestateagents.com
www.monroestateagents.com

MONROE

SELLERS OF THE FINEST HOMES