



Fairview, Choppington

Guide price £185,000



Key Features

- Terraced House
- Private Garden
- 4 Bedroom
- En-Suite
- Kitchen/Diner
- Great Location
- Freehold
- Council Tax Band 2024/2025: C





Welcome to Fairview, a charming and spacious four-bedroom terrace house located in Choppington. This versatile home offers an abundance of living space, perfect for a growing family or those seeking extra room for a home office or guest bedrooms.

As you step through the front door, you are greeted by a large, welcoming hallway featuring a staircase and a convenient downstairs toilet. From this hallway, you have direct access to the generously sized living room, which boasts a beautiful bay window that floods the space with natural light, creating a warm and inviting atmosphere.

The hallway also leads to the expansive open-plan kitchen and dining area, designed for both functionality and style. This modern space features a kitchen peninsula, perfect for casual meals or entertaining guests. Double doors open onto a private garden, providing a serene outdoor space for relaxation and alfresco dining.

Upstairs, the first smaller bedroom is currently utilised as a home office, ideal for remote work or study. The main bedroom is a true retreat, complete with built-in wardrobes and a en-suite bathroom featuring a shower.

Further down the hallway, you will find two additional small bedrooms, offering flexibility for use as additional bedrooms, guest rooms, or even a hobby room. The second bedroom is spacious and also includes built-in wardrobes, ensuring ample storage space. The family bathroom is well-appointed with a bathtub and a storage cupboard, catering to all your practical needs.

Fairview, Choppington, is a wonderful family home that combines spacious living areas with versatile room configurations, allowing you to tailor the space to your lifestyle. Don't miss the opportunity to make this delightful property your new home.





Freehold

Council Tax band 2024-2025: C Approx
£2160.36 per annum

EPC: TBC

We endeavour to make our sales particulars accurate and reliable, however, they do not constitute or form part of an offer or any contract and none is to be relied upon as statements of representation or fact. Any services, systems and appliances listed in this specification have not been tested by us and no guarantee as to their operating ability or efficiency is given. All measurements have been taken as a guide to prospective buyers only, and are not precise. If you require clarification or further information on any points, please contact us, especially if you are travelling some distance to view. Fixtures and fittings other than those mentioned are to be agreed with the seller by separate negotiation.



Living Room 3.61m x 5.33m (11'10" x 17'6")

Kitchen 5.63m x 3.86m (18'6" x 12'8")

Main Bedroom 3.30m x 2.97m (10'10" x 9'8")

Bedroom 2 2.91m x 2.34m (9'6" x 7'8")

Bedroom 3 2.24m x 2.23m (7'4" x 7'4")

Bedroom 4 1.99m x 2.33m (6'6" x 7'7")

Bathroom 2.32m x 1.66m (7'7" x 5'5")



GROUND FLOOR

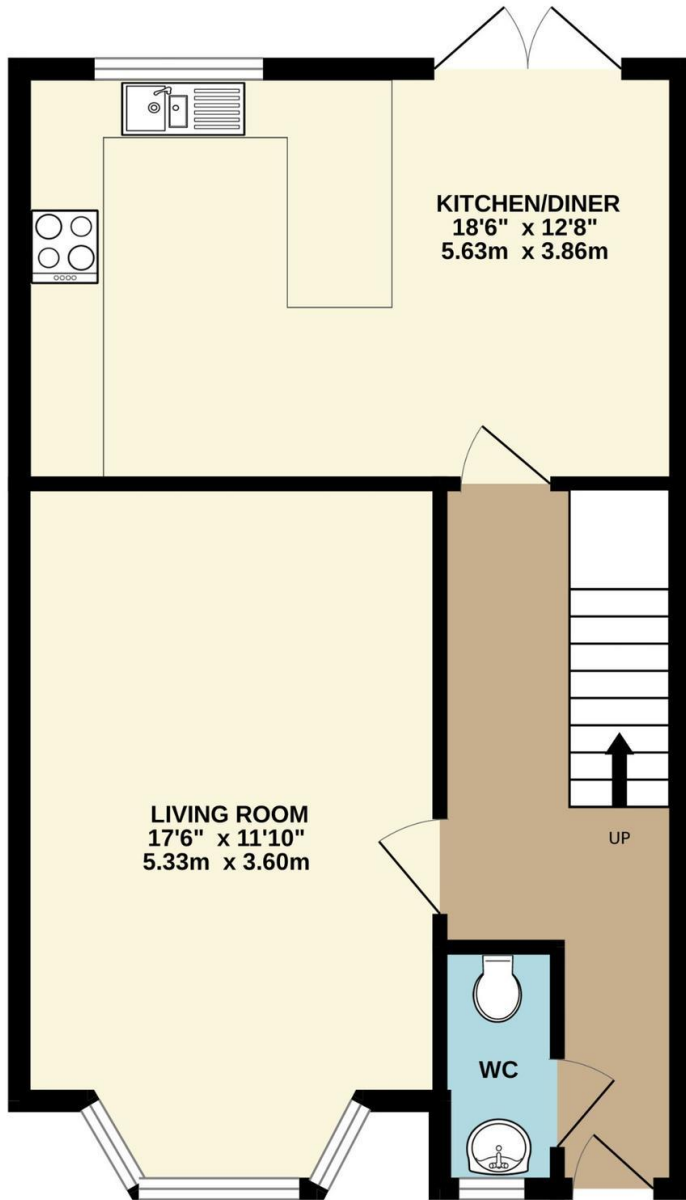

1ST FLOOR

