



Estate Agency, Letting Agency & Property Maintenance

LARN Number 1906034

T: 01563 531122 E: kilmarnock@glowhomeslettingandsales.com

37 John Finnie Street, Kilmarnock, KA1 1BL

47-49 Vernon Street, Saltcoats, KA21 5HE



WWW.GLOWHOMESLETTINGANDSALES.COM

Offers Over £125,000 Bentink Gardens, Kirkmuirhill, ML11



- Located in quiet cul-de-sac within modern estate
- Spacious Lounge
- WC & Family Bathroom
- Dining Kitchen
- 3 Bedrooms
- Ample Storage
- Private enclosed garden
- Excellent for Families or First Time Buyers
- Perfect blank canvas

Glow Homes are delighted to present 4 Bentink Gardens in Blackwood to the market for sale. This semi-detached villa provides generous accommodation over two levels and is located within a quiet cul-de-sac.

On the ground floor there is a front facing lounge with double doors leading to the

kitchen at the rear. The spacious kitchen has fitted floor and wall mounted units in a beech wood finish with a complimentary worktop and a handy breakfast bar. The kitchen includes an integrated fridge & freezer and integrated dishwasher, oven, hob & extractor hood. There is also space to accommodate a dining table and chairs with French doors leading to the back garden.

There is a handy downstairs cloakroom off the main entrance hall.

On the first floor there are three bedrooms and a bathroom. The master bedrooms benefits from having a built-in wardrobe and bedroom three has a built-in storage cupboard. The bathroom comprises of a wc, wash hand basin and bath with overhead shower and tiling to the walls surrounding the bath.

There are minimal maintenance gardens to the front and back with the back garden being fully enclosed. There is a residents parking immediately outside the villa.

Home Report available on request.

Bentink Gardens, Kirkmuirhill, ML11







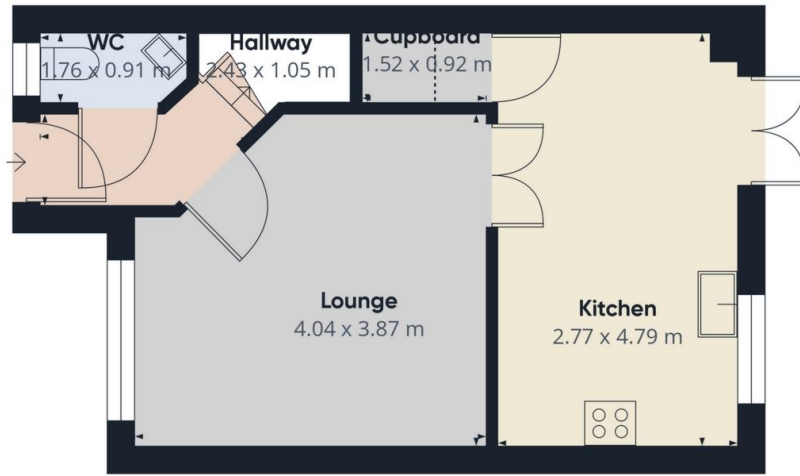

Floor 0

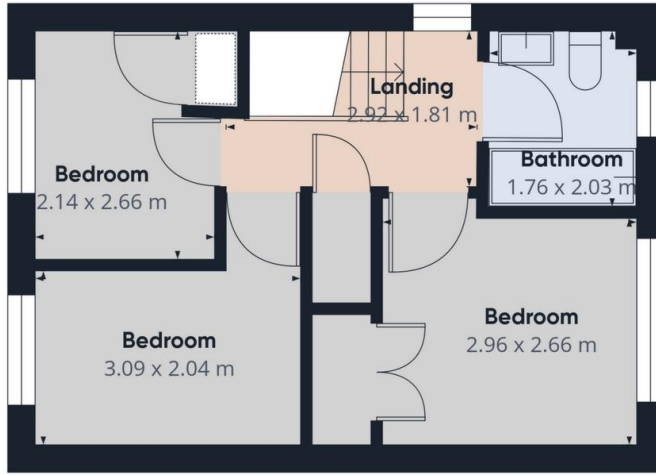

Floor 1

Approximate total area⁽¹⁾

63.79 m²

Reduced headroom

0.74 m²

(1) Excluding balconies and terraces

Reduced headroom

----- Below 1.5 m

While every attempt has been made to ensure accuracy, all measurements are approximate, not to scale. This floor plan is for illustrative purposes only.

Calculations are based on RICS IPMS 3C standard.

GIRAFFE360

Directions

Location



VIEWING BY APPOINTMENT WITH AGENTS GLOW HOMES AYRSHIRE

37 John Finnie St, Kilmarnock, KA1 1BL T: 01563 531122 E: kilmarnock@glowhomeslettingandsales.com W: <http://www.glowhomeslettingandsales.com/>

General: While we endeavour to make our sales particulars fair, accurate and reliable, they are only a general guide to the property and, accordingly, if there is any point which is of particular importance to you, please contact the office and we will be pleased to check the position for you, especially if you are contemplating travelling some distance to view the property.

Measurements: These approximate room sizes are only intended as general guidance. You must verify the dimensions carefully before ordering carpets or any built-in furniture.

Services: Please note we have not tested the services or any of the equipment or appliances in this property, accordingly we strongly advise prospective buyers to commission their own survey or service reports before finalizing their offer to purchase.

THESE PARTICULARS ARE ISSUED IN GOOD FAITH BUT DO NOT CONSTITUTE REPRESENTATIONS OF FACT OR FORM PART OF ANY OFFER OR CONTRACT. THE MATTERS REFERRED TO IN THESE PARTICULARS SHOULD BE INDEPENDENTLY VERIFIED BY PROSPECTIVE BUYERS OR TENANTS. NEITHER GLOW HOMES AYRSHIRE NOR ANY OF ITS EMPLOYEES OR AGENTS HAS ANY AUTHORITY TO MAKE OR GIVE ANY REPRESENTATION OR WARRANTY WHATEVER IN RELATION TO THIS PROPERTY.

YOUR HOME IS AT RISK IF YOU DO NOT KEEP UP REPAYMENTS ON A MORTGAGE OR OTHER LOAN SECURED ON IT.

Written quotations available on request. All loans secured on property. Life assurance is usually required.