



4 Rembrandt Close, Lowestoft
£330,000

4 Rembrandt Close

Lowestoft, Lowestoft

Nestled in a sought-after cul-de-sac in Gunton, this improved and extended three-bedroom linked-detached home offers well-proportioned living spaces for the whole family. With no onward chain, this property presents an excellent opportunity for a new owner. It features two reception rooms, a well-equipped kitchen, a conservatory, and a family bathroom. Ideally situated just off the A12, it provides easy access to local towns and transport connections for commuting. The home is conveniently close to amenities and the finest East Coast beaches, making it perfect for both business and pleasure.

Council Tax band: C

Tenure: Freehold

EPC Energy Efficiency Rating: C

EPC Environmental Impact Rating:





4 Rembrandt Close

Lowestoft, Lowestoft

Nestled in a sought-after cul-de-sac in Gunton, this improved and extended three-bedroom linked-detached home offers well-proportioned living spaces for the whole family. With no onward chain, this property presents an excellent opportunity for a new owner. It features two reception rooms, a well-equipped kitchen, a conservatory, and a family bathroom. Ideally situated just off the A12, it provides easy access to local towns and transport connections for commuting. The home is conveniently close to amenities and the finest East Coast beaches, making it perfect for both business and pleasure.

Location

Rembrandt Close is situated in Lowestoft, a coastal town in Suffolk known for its vibrant community and scenic beauty. This residential area offers a quiet, suburban setting while being conveniently close to local amenities. Nearby, you'll find a range of shops, schools, and recreational facilities. The location benefits from excellent transport links, with easy access to the A12 and A47 for travel to surrounding towns and cities. Additionally, Lowestoft's beautiful beaches and the South Beach are within a short drive, providing opportunities for leisure and outdoor activities. The town also offers various parks, including the nearby Belle Vue Park, which adds to the area's appeal.

Rembrandt Close, Lowestoft

This attractive home begins with a composite door leading into a welcoming hallway with laminate flooring and built-in storage cupboards. The



GROUND FLOOR
711 sq.ft. (66.1 sq.m.) approx.

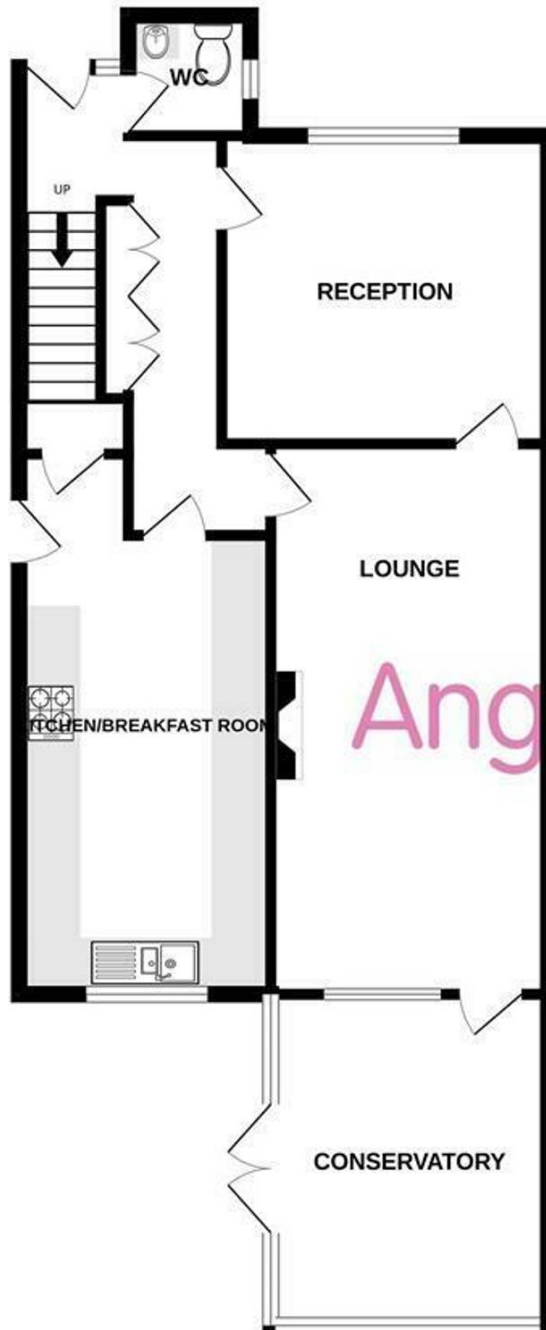

1ST FLOOR
419 sq.ft. (38.9 sq.m.) approx.

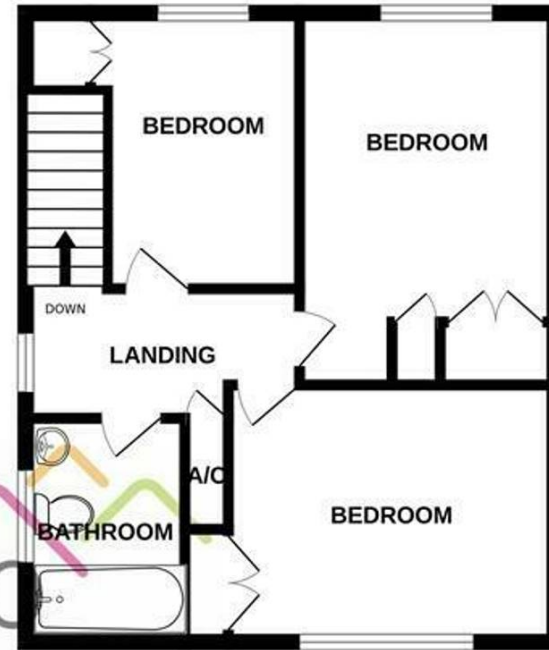

Ange & Co

REMBRANDT CLOSE, GUNTON

TOTAL FLOOR AREA: 1130 sq.ft. (105.0 sq.m.) approx.

Whilst every attempt has been made to ensure the accuracy of the floorplan contained here, measurements of doors, windows, rooms and any other items are approximate and no responsibility is taken for any error, omission or mis-statement. This plan is for illustrative purposes only and should be used as such by any prospective purchaser. The services, systems and appliances shown have not been tested and no guarantee as to their operability or efficiency can be given.
Made with Metropix ©2024

