



## 85 Glebelands Close

, London, N12 0AL

**£425,000**

Daniel Ford are pleased to offer to the market this 2 bedroom/2 bathroom flat in this popular gated development in North Finchley. There is lift, balcony and communal grounds, as well as its location close to Finchley Central Station, many shops and restaurants right on the doorstep as well as local bus routes.

Lease 136 years remaining

- 2 Double Bedrooms
- 2 Bathrooms/One Ensuite
- Gated
- Chain Free
- Parking

### Viewing

Please contact us on 020 3198 4517 if you wish to arrange a viewing appointment for this property or require further information.





## Floor Plan

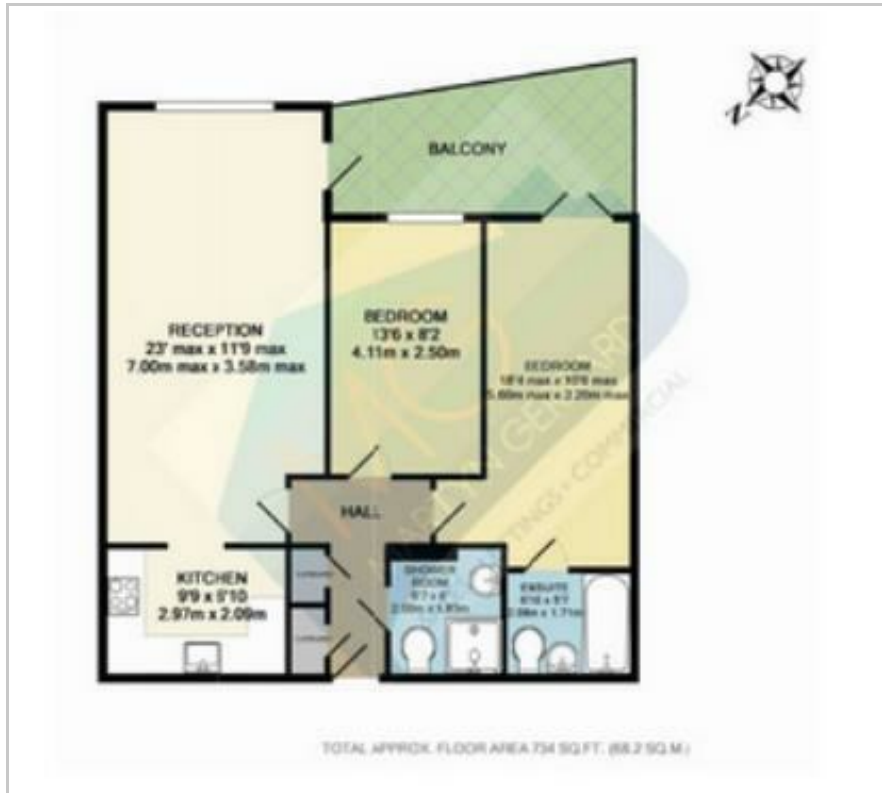

## Area Map



## Energy Efficiency Graph

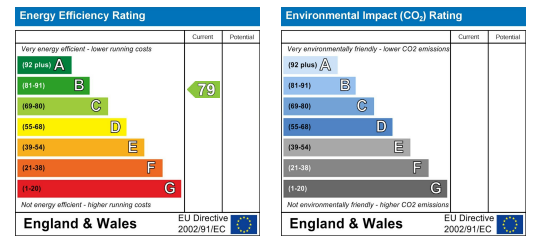

These particulars, whilst believed to be accurate are set out as a general outline only for guidance and do not constitute any part of an offer or contract. Intending purchasers should not rely on them as statements of representation of fact, but must satisfy themselves by inspection or otherwise as to their accuracy. No person in this firm's employment has the authority to make or give any representation or warranty in respect of the property.