

Flat 222 Stratosphere Tower 55 Great Eastern

, London, E15 1DU

£3,200 Per month

This modern two bedroom apartment located at a high level within the building and offers stunning views across London. The development offers residents a 24 hour concierge service, private gymnasium, Wi-Fi lounge and roof-top terrace. Stratford Station is just a short walk away and includes access to Central, Jubilee, DLR, Overground and TFL rail lines.

The property has been finished to a high specification with built in wardrobes, appliances and underfloor heating. It includes a bright and spacious living room with a fully-fitted open plan kitchen, as well as 2 double bedrooms with 1 en-suite bathroom and 1 family bathroom.

Available now on a furnished or unfurnished basis

- 2 Bedroom Apartment
- 2 Modern Bathrooms
- Fully-Fitted Kitchen
- Stunning Views
- 24 Hour Concierge & Residence Gym
- Moments Away from Stratford Station
- Furnished or Unfurnished Optional

Viewing

Please contact us on 020 3198 4517 if you wish to arrange a viewing appointment for this property or require further information.



Floor Plan

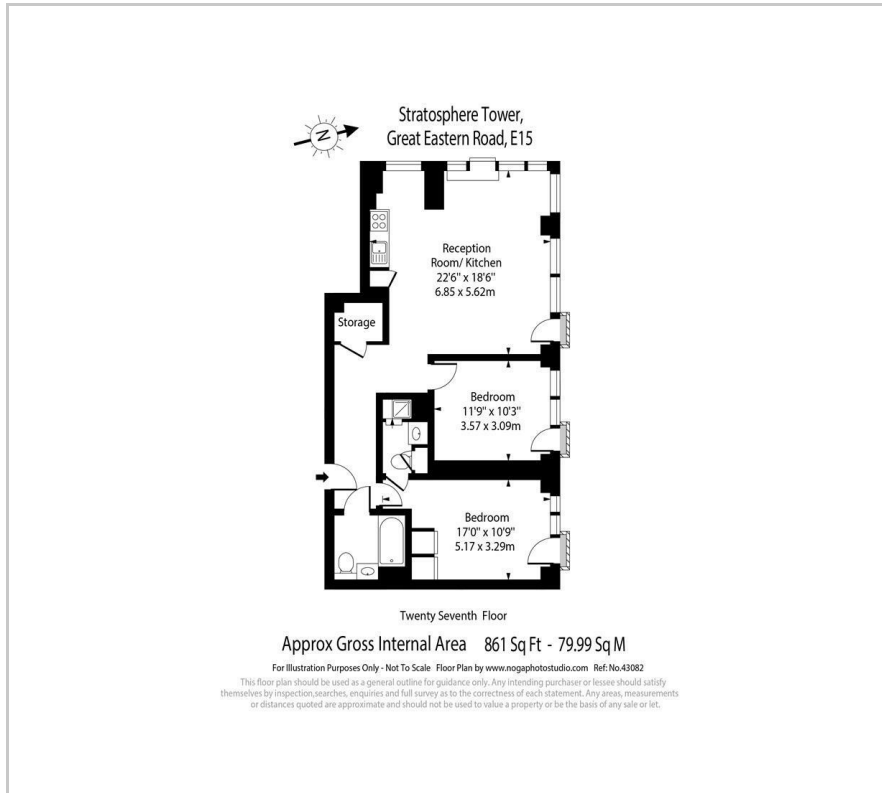

Area Map

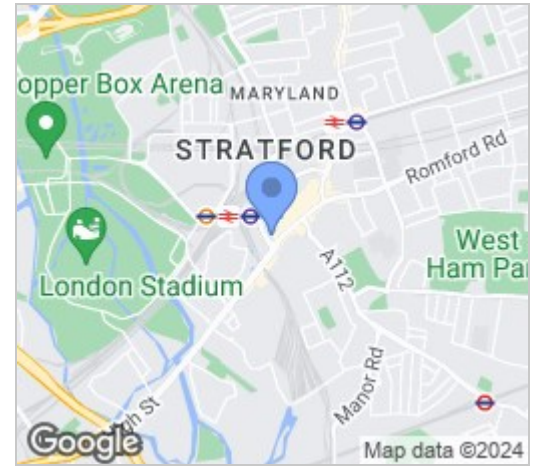

Energy Efficiency Graph

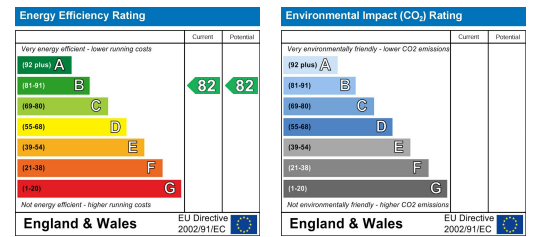

These particulars, whilst believed to be accurate are set out as a general outline only for guidance and do not constitute any part of an offer or contract. Intending purchasers should not rely on them as statements of representation of fact, but must satisfy themselves by inspection or otherwise as to their accuracy. No person in this firm's employment has the authority to make or give any representation or warranty in respect of the property.