



834 Forest Road

, London, E17 4AA

£2,400 Per month

We happy to offer this newly painted 4 bed corner house directly opposite HomeBase Semi- detached house with garden, spacious living room, separate kitchen, 3 double bedrooms, 1 single bedroom and one bathroom. It further benefits from a private garden.

- Newly Painted
- New Carpet
- Corner piece house
- Large Garden
- 3 double bedroom
- 1 single bedroom

Viewing

Please contact us on 020 3198 4517 if you wish to arrange a viewing appointment for this property or require further information.



Floor Plan

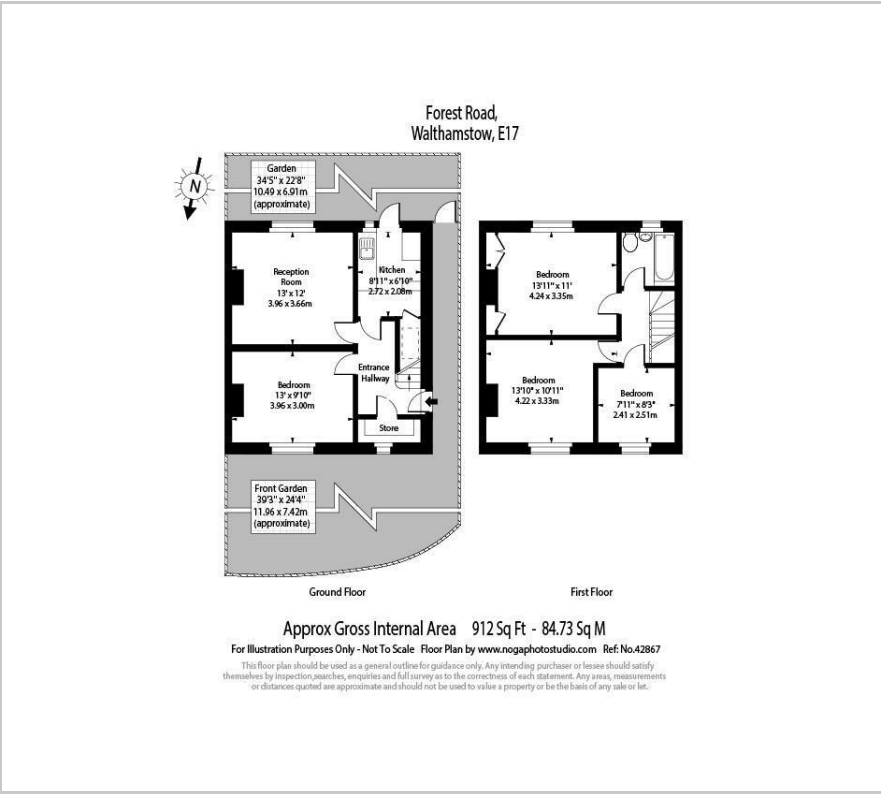

Area Map



Energy Efficiency Graph

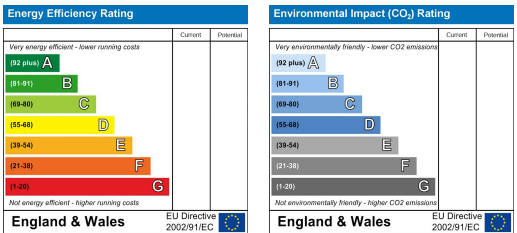

These particulars, whilst believed to be accurate are set out as a general outline only for guidance and do not constitute any part of an offer or contract. Intending purchasers should not rely on them as statements of representation of fact, but must satisfy themselves by inspection or otherwise as to their accuracy. No person in this firms employment has the authority to make or give any representation or warranty in respect of the property.