



## Flat 29 Bower House, Henshaw Parade, The Hyde , London, NW9 6GJ £650,000

Brand New Flat comprising of three bedrooms, two bathroom, in the Silkstream development. The property is set on the sixth floor with private balcony offering views over the Garden. The kitchen comes complete with integrated appliances and all bedrooms are carpeted, bedroom one has built in wardrobes and ensuite shower room.

Silkstream is a low carbon, nature rich neighbourhood in Hendon; a vibrant area of North West London that offers excellent schools, shops, cafés and restaurants. Connections to the city are easy with Hendon Station (Thameslink), Brent Cross West Station (Thameslink) and Hendon Central Station (Northern Line) within walking distance. Being on the Edgware Road; the M1, A5 and North Circular offer a choice of road links into and out of London.

- New Property
- 3 Bedrooms
- 2 Bathrooms
- Minutes to Central London
- Gym
- Park
- Concierge

### Viewing

Please contact us on 020 3198 4517 if you wish to arrange a viewing appointment for this property or require further information.





Floor Plan

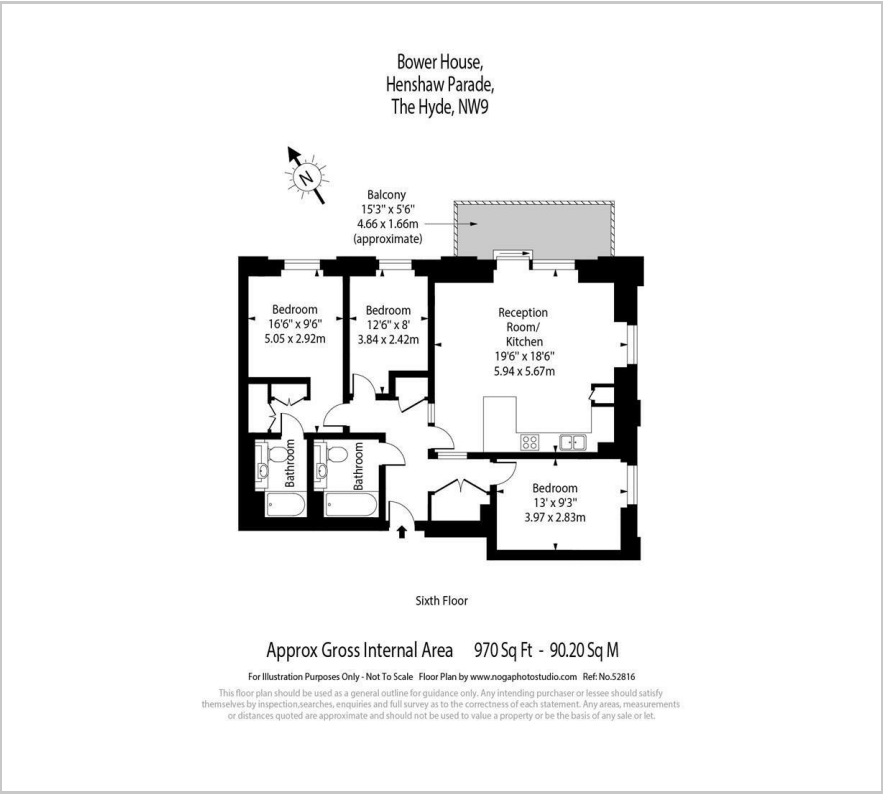

Area Map



Energy Efficiency Graph

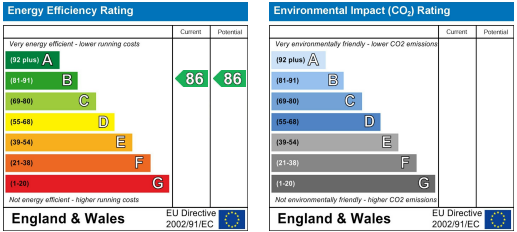

These particulars, whilst believed to be accurate are set out as a general outline only for guidance and do not constitute any part of an offer or contract. Intending purchasers should not rely on them as statements of representation of fact, but must satisfy themselves by inspection or otherwise as to their accuracy. No person in this firms employment has the authority to make or give any representation or warranty in respect of the property.