



98 Glebelands Close

, London, N12 0AL

£2,100 Per month

Welcome to this charming purpose-built flat located on Glebelands Close in the vibrant city of London. This delightful property boasts two well-proportioned bedrooms, making it an ideal choice for professionals, couples, or small families seeking a comfortable living space.

As you enter the flat, you are greeted by a spacious reception room that offers a warm and inviting atmosphere, perfect for relaxation or entertaining guests. The room is filled with natural light, enhancing the overall appeal of the home. The flat features two modern bathrooms, ensuring convenience and privacy for all residents.

One of the standout features of this property is the lovely balcony, where you can enjoy your morning coffee or unwind in the evening while taking in the views of the surrounding area. Being situated on an upper floor, the flat provides a sense of tranquillity away from the hustle and bustle of city life.

Residents will also benefit from access to a communal gym, allowing you to maintain an active lifestyle without the need for a separate membership. This added amenity is perfect for those who enjoy fitness and wish to stay healthy in the comfort of their own home.

- 2 Bedrooms
- 2 Bathrooms
- Gated Development
- Close to Local Shops and Transport Links
- Unfurnished
- Electric Heating

Viewing

Please contact us on 020 3198 4517 if you wish to arrange a viewing appointment for this property or require further information.



Floor Plan

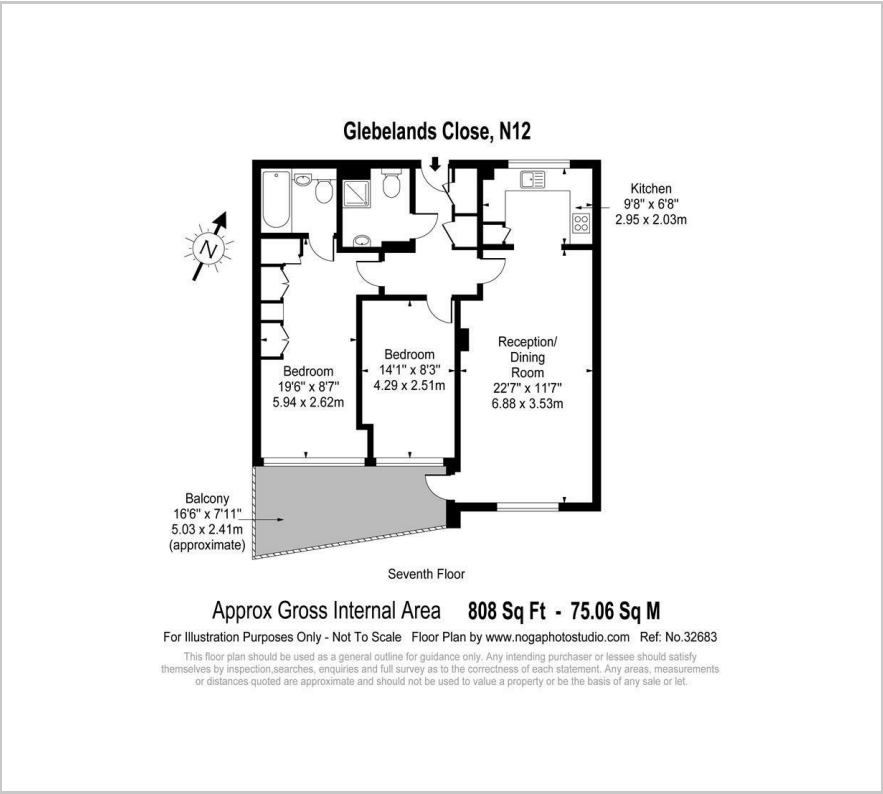

Area Map



Energy Efficiency Graph

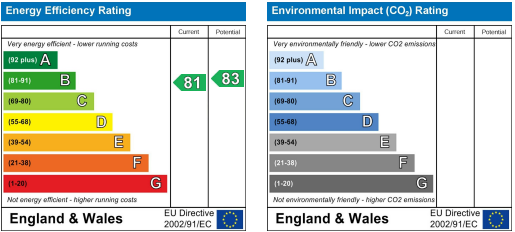

These particulars, whilst believed to be accurate are set out as a general outline only for guidance and do not constitute any part of an offer or contract. Intending purchasers should not rely on them as statements of representation of fact, but must satisfy themselves by inspection or otherwise as to their accuracy. No person in this firms employment has the authority to make or give any representation or warranty in respect of the property.