



Blore House Coleridge Gardens

, London, SW10 0RP

£3,500 Per month

We are proud to offer this lovely 2 bed with one En-Suite room on King's Road in Chelsea with other amenities include an all-weather tennis court, swimming pool, sauna, steam room and gymnasium. There is also 24-hour security and concierge service, and has great transport links to the rest of the city with Fulham Broadway Underground Station approximately 0.6 miles and Earls Court Underground Station approximately 1.0 mile away.

Viewing

Please contact us on 020 3198 4517 if you wish to arrange a viewing appointment for this property or require further information.



Floor Plan

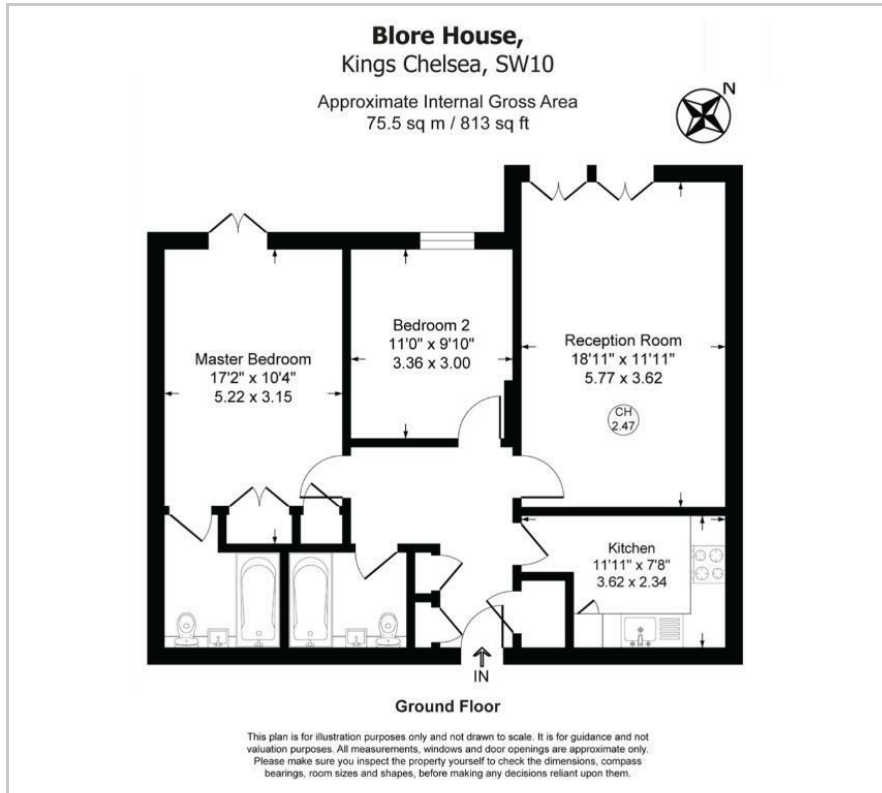

Area Map

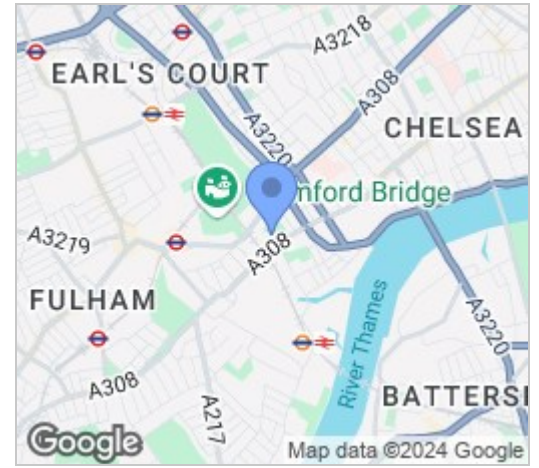

Energy Efficiency Graph

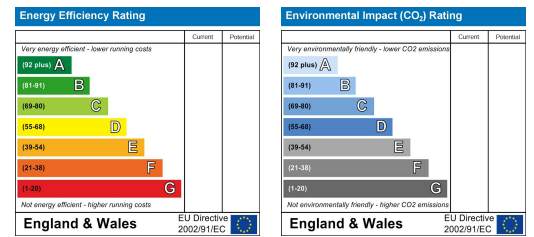

These particulars, whilst believed to be accurate are set out as a general outline only for guidance and do not constitute any part of an offer or contract. Intending purchasers should not rely on them as statements of representation of fact, but must satisfy themselves by inspection or otherwise as to their accuracy. No person in this firm's employment has the authority to make or give any representation or warranty in respect of the property.