



Bronze Building 18 Buckhold Road

Wandsworth, London, SW18 4RG

£3,900 Per month

We are proud to present this 3 Bedroom apartment on the ninth floor of the Bronze building, enviably located on Buckhold Road adjacent to the popular King George's Park. Bronze consists of just 79 apartments in a new landmark building, part 11 storey, part 18 storey, and part 20 storey.

The apartment offers 3 spacious Bedrooms, 2 Bathrooms which consist of one bath and one walk in shower respectably all finished to a high specification with air conditioning servicing the apartment and a private balcony.

Also available is a roof terrace containing a child's play area on the fourth floor and a day time concierge.

Voted one of the best places for young professionals to live in London, Wandsworth, is well connected for getting in and around the Capital, and benefits from great transport links, parks, boutique shops, restaurants cafes, and bars.

- Brand new development
- Three contemporary bathrooms
- Private Balcony
- Air Conditioning and AC
- Underfloor heating
- Private Balcony with amazing views
- Opposite of King George's Park
- Available Furnished, part-furnished or unfurnished
- Top Floor - Pent House

Viewing

Please contact us on 020 3198 4517 if you wish to arrange a viewing appointment for this property or require further information.



Floor Plan

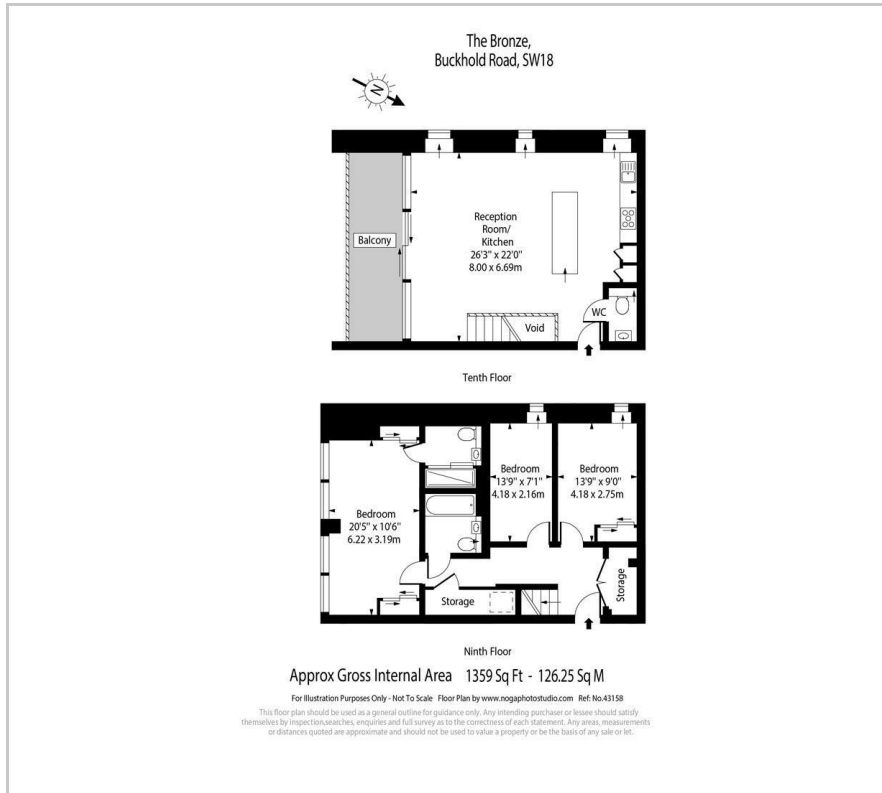

Area Map

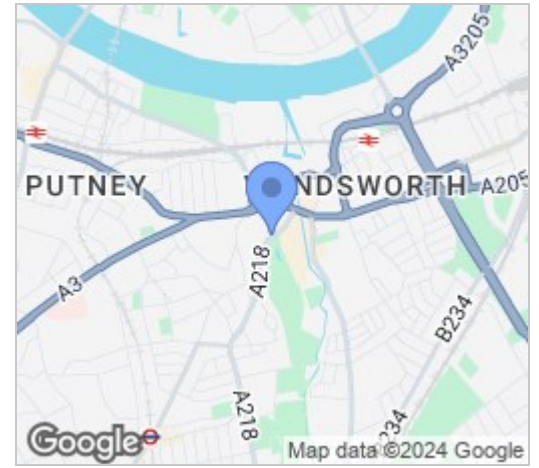

Energy Efficiency Graph

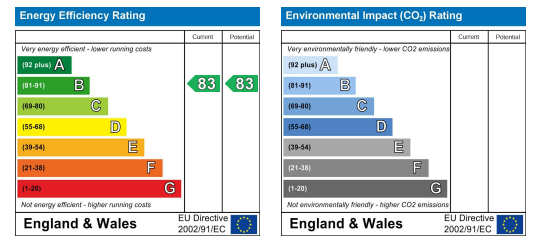

These particulars, whilst believed to be accurate are set out as a general outline only for guidance and do not constitute any part of an offer or contract. Intending purchasers should not rely on them as statements of representation of fact, but must satisfy themselves by inspection or otherwise as to their accuracy. No person in this firm's employment has the authority to make or give any representation or warranty in respect of the property.