



186 Rosendale Road

, London, SE21 8LQ

£3,250 Per month

We are proud to present this beautiful 3 bedroom house located in West Dulwich, it is briefly comprised of 3 double bedrooms of which 1 is enquire, a stand alone family sized bathroom and a seperate living kitchen area.

It is located 5 mins walk away from West Dulwich Station which provides access into Central London in under 25 minutes, also located close by are Belair and Dulwich Park.

The property is available on an unfurnished basis.

Viewing

Please contact us on 020 3198 4517 if you wish to arrange a viewing appointment for this property or require further information.



Floor Plan

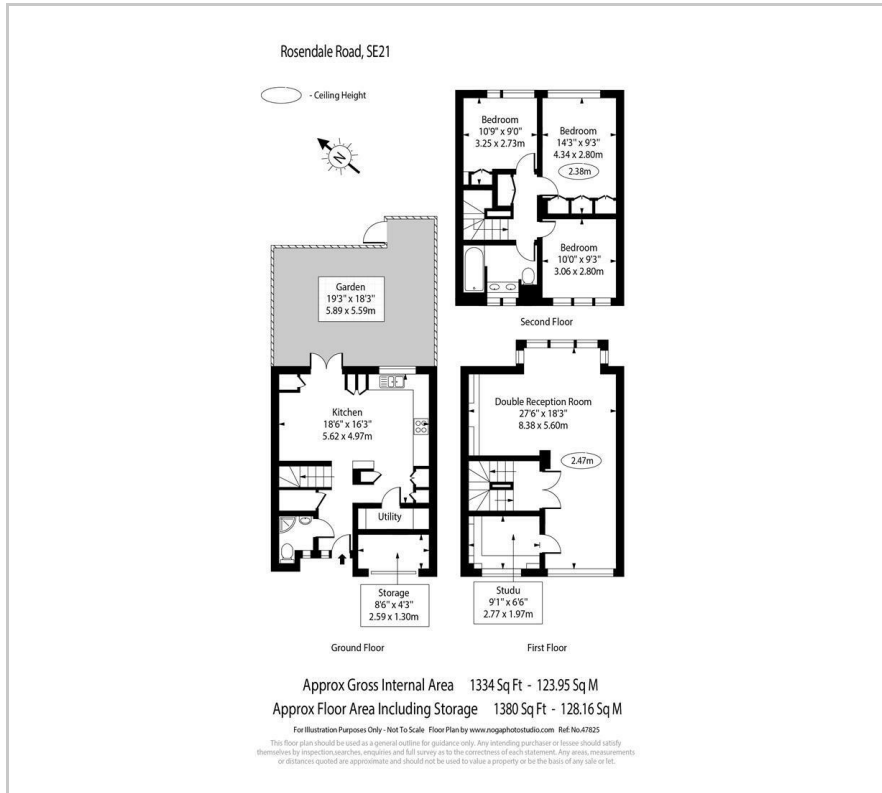

Area Map



Energy Efficiency Graph

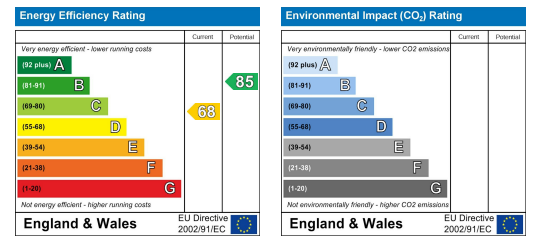

These particulars, whilst believed to be accurate are set out as a general outline only for guidance and do not constitute any part of an offer or contract. Intending purchasers should not rely on them as statements of representation of fact, but must satisfy themselves by inspection or otherwise as to their accuracy. No person in this firm's employment has the authority to make or give any representation or warranty in respect of the property.