



605 Westhorne Avenue

, London, SE9 6JX

£2,100 Per month

Daniel Ford Estates are delighted to present a 3 bedroom 2 reception house located on a desirable street and moments away from Eltham Station.

The house comprises of 2 double and 1 single bedrooms, 2 good size reception rooms, a fully tiled bathroom, separate toilet, and modern kitchen.

The property has easy access to major road links as well as public transport links.

- 3 Bedroom House
- 2 Reception Rooms
- 1 Bathroom with Separate Toilet
- Near Eltham Station
- Available Immediately

Viewing

Please contact us on 020 3198 4517 if you wish to arrange a viewing appointment for this property or require further information.



3



1



2



Floor Plan

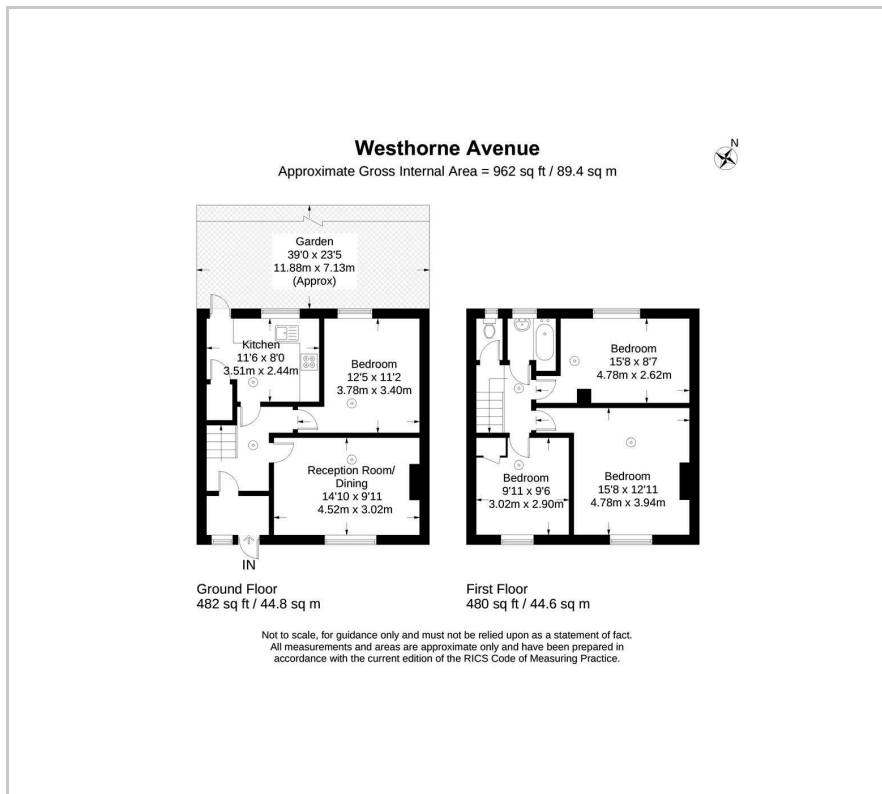

Area Map

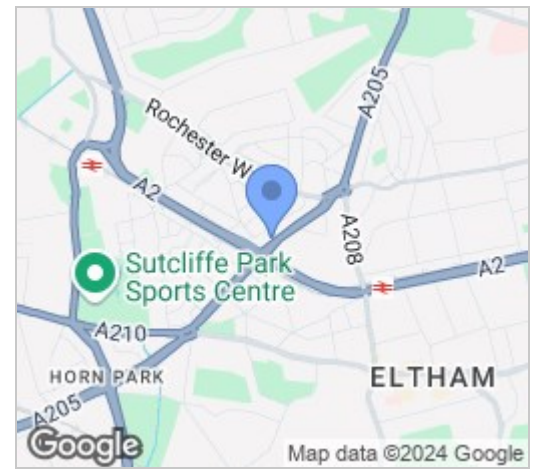

Energy Efficiency Graph

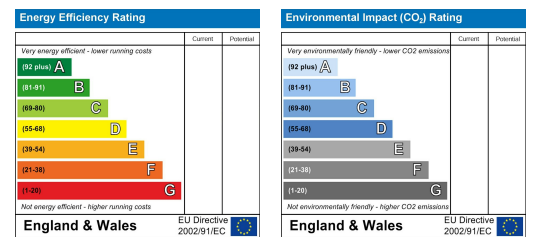

These particulars, whilst believed to be accurate are set out as a general outline only for guidance and do not constitute any part of an offer or contract. Intending purchasers should not rely on them as statements of representation of fact, but must satisfy themselves by inspection or otherwise as to their accuracy. No person in this firm's employment has the authority to make or give any representation or warranty in respect of the property.