



Chevette Court Kimpton Road

, Luton, LU2 0GU

£1,450

Daniel Ford Estates are delighted to offer a desirable two bedroom apartment within a superb new development as follows:

- Located in the heart of Luton and within an areas with fast growing regeneration for business growth
- First floor flat
- Open plan kitchen and reception area
- Fully fitted kitchen with white gloss units (and integrated appliances)
- Superb bathroom
- A few minutes walk to the station (with easy access to both Luton and 4 minutes to Luton Airport)
- Only 25 minutes to main stations such as to King's Cross, St Pancras. (Close to M1)
- Set within urban squares, high spec landscaped parklands
- Short walk to Poundland, Next, Argos, Coffee shop, an off Licence
- Cycle storage

- 2 bedrooms
- 2 bathrooms
- 1st Floor
- 24 Hours Concierge
- Roof Top Gardens
- Close to Luton Airport
- Available now
- Unfurnished

Viewing

Please contact us on 020 3198 4517 if you wish to arrange a viewing appointment for this property or require further information.



2



2



1



Floor Plan

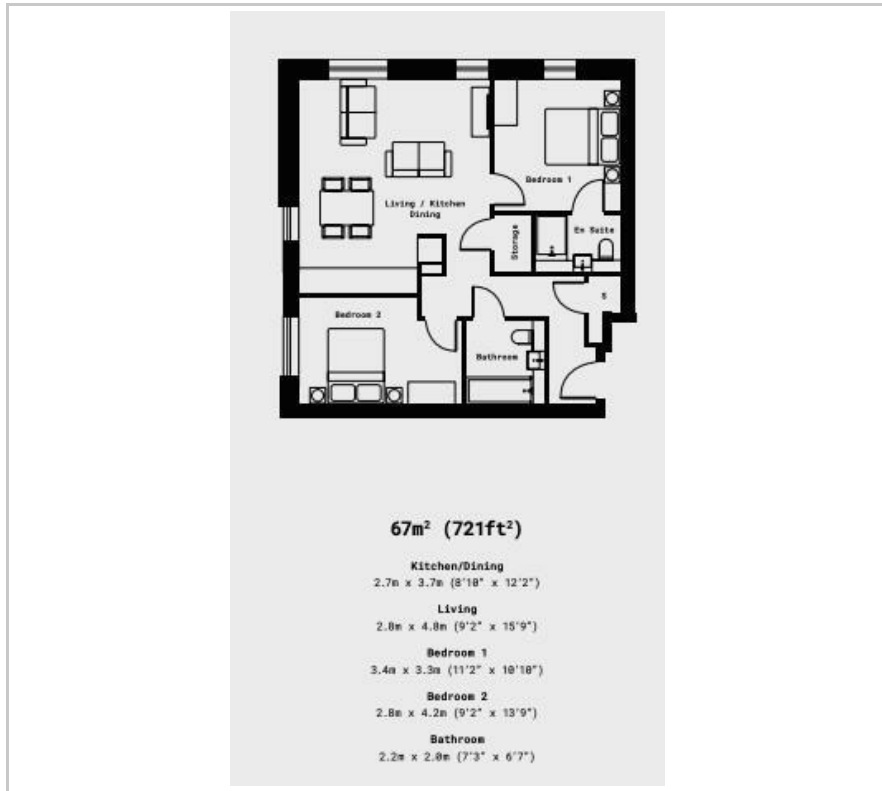

Area Map



Energy Efficiency Graph

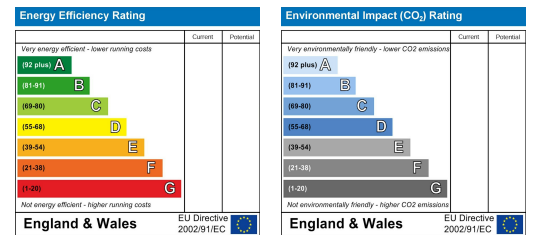

These particulars, whilst believed to be accurate are set out as a general outline only for guidance and do not constitute any part of an offer or contract. Intending purchasers should not rely on them as statements of representation of fact, but must satisfy themselves by inspection or otherwise as to their accuracy. No person in this firm's employment has the authority to make or give any representation or warranty in respect of the property.