



## 20 Abbey Road

, London, NW8 9BW

### £6,500 Per month

A spacious top floor three bedroom apartment along the famous Abbey Road which is ideally located for St Johns Wood High Street and Tube Station (Jubilee Line). The accommodation comprises of two spacious double bedrooms with an additional double bedroom which can be also use as a study. Further benefits include a large reception and dining room, a bathroom and plenty of storage in the hallway. The property will be ideally suited for a small family or professionals looking for an easy commute into central London. The property is furnished to a high standard including ceiling heating. The apartment got an underground, swimming-pool and 24 hours concierge. The property has to be viewed to be fully appreciated.

- Top floor apartment
- 3 bedrooms
- 2 bathrooms
- Generously sized balcony
- Spacious Living-room
- 24 hours concierge
- Swimming-pool
- Parking
- Lift
- Abbey Road

### Viewing

Please contact us on 020 3198 4517 if you wish to arrange a viewing appointment for this property or require further information.

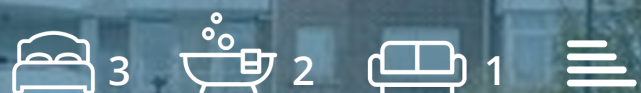

# Floor Plan

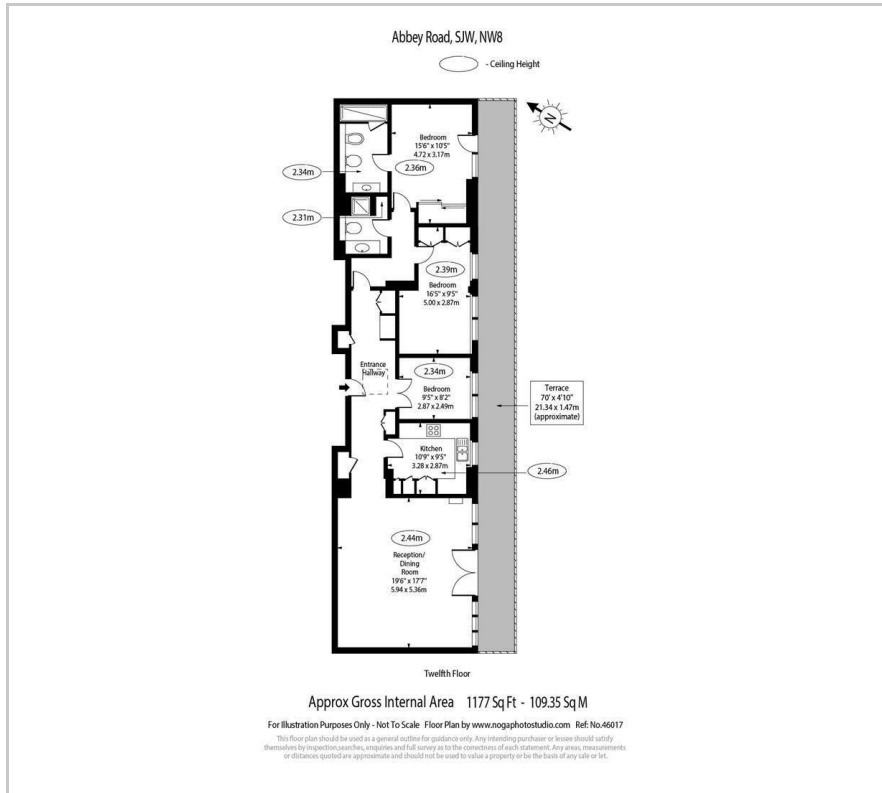

# Area Map

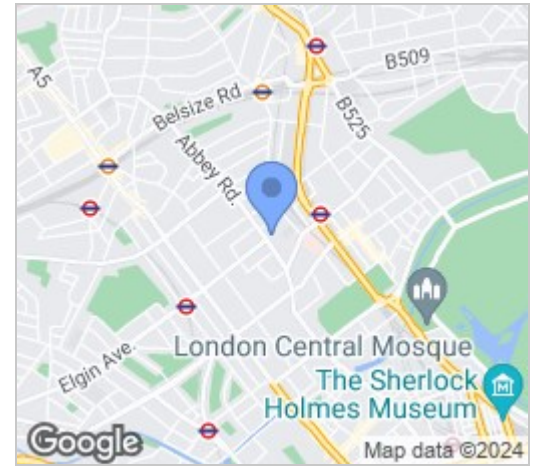

# Energy Efficiency Graph



These particulars, whilst believed to be accurate are set out as a general outline only for guidance and do not constitute any part of an offer or contract. Intending purchasers should not rely on them as statements of representation of fact, but must satisfy themselves by inspection or otherwise as to their accuracy. No person in this firm's employment has the authority to make or give any representation or warranty in respect of the property.