



Flat 6, Queens Court 4-8 Finchley Road

, London, NW8 6DR

£925,000

Discover the comfort of contemporary living in this recently updated two-bedroom apartment within the Queens Court block. Enjoy the spaciousness and natural light provided by its design, featuring a sizable reception area, a fully equipped kitchen, two double bedrooms, and a family bathroom.

Benefit from the convenience of a dedicated concierge service, ensuring your needs are met with ease. Positioned just moments away from St John's Wood Underground Station (Jubilee Line) and the local amenities along St John's Wood High Street, this apartment offers a practical yet comfortable lifestyle.

Viewing

Please contact us on 020 3198 4517 if you wish to arrange a viewing appointment for this property or require further information.



2



1



1



Floor Plan

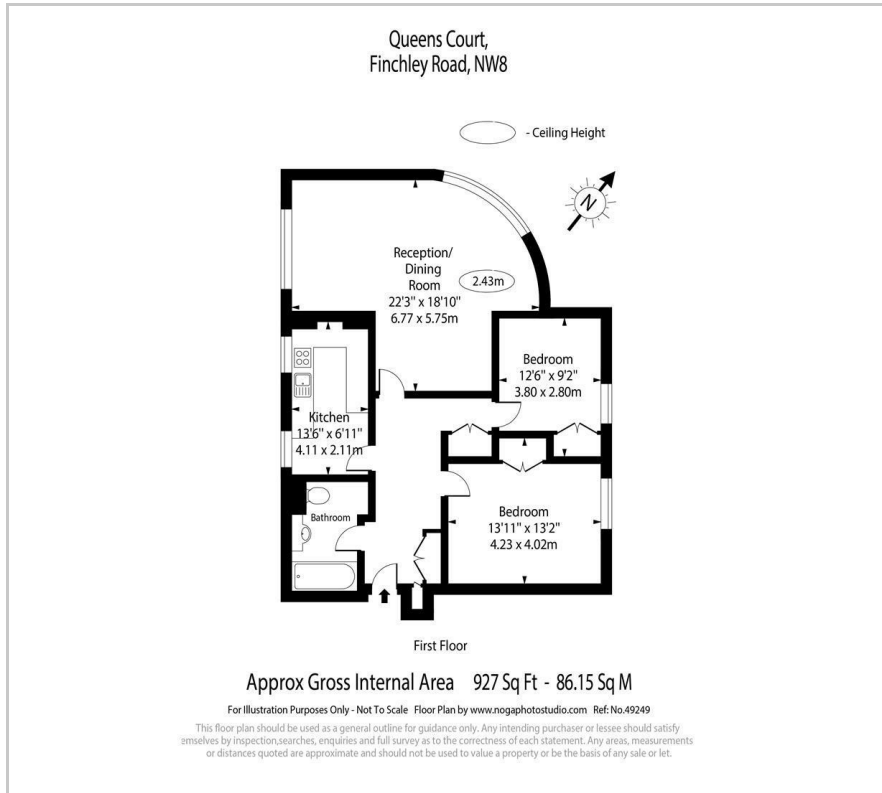

Area Map



Energy Efficiency Graph

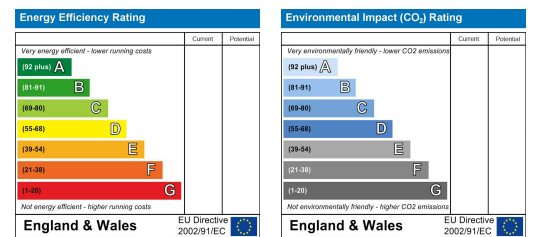

These particulars, whilst believed to be accurate are set out as a general outline only for guidance and do not constitute any part of an offer or contract. Intending purchasers should not rely on them as statements of representation of fact, but must satisfy themselves by inspection or otherwise as to their accuracy. No person in this firm's employment has the authority to make or give any representation or warranty in respect of the property.