

  
**Natasha Howarth**  
ESTATE AGENTS



**19 Wilkins Road, Bridgwater, TA6 4ED**

**£1,150 Per month**

Natasha Howarth Estate Agents would like to offer to rent this fine example of a three bedroom terraced house situated on the edge of the popular Bower Manor development on the Eastern outskirts of Bridgwater. The living/ dining room is well-proportioned and has patio doors to the garden. In addition there is a low maintenance rear garden with timber shed and off road parking for two vehicles to the front.

The accommodation briefly comprises entrance hall, living room/ dining room and kitchen to the ground floor. Upstairs there are three good size bedrooms and a family bathroom.

The property is ideally placed to benefit from the local amenities including Tesco Express, shops, doctors surgery, pharmacy, takeaways and Bridgwater Community Hospital.

For more information or an appointment to view please contact the vendors sole agent.



# Floor Plan

GROUND FLOOR

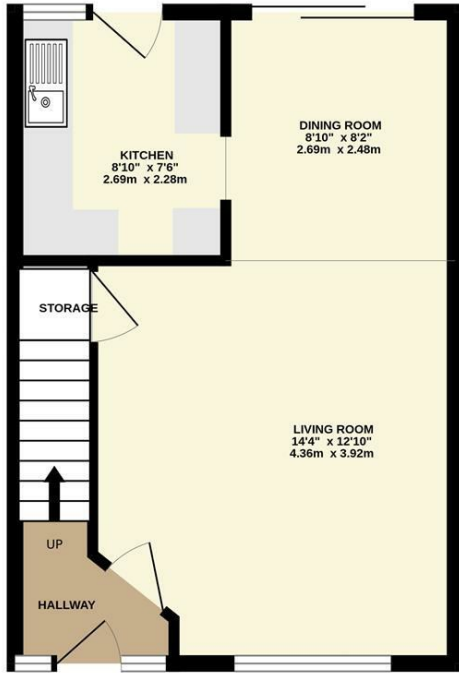

1ST FLOOR

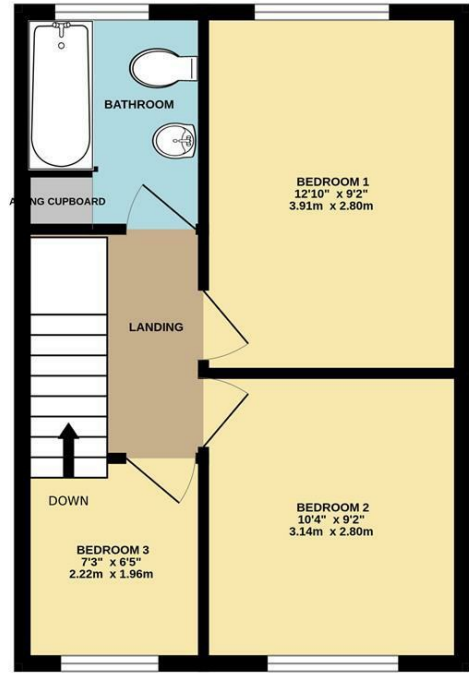

Whilst every attempt has been made to ensure the accuracy of the floorplan contained here, measurements of doors, windows, rooms and any other items are approximate and no responsibility is taken for any error, omission or mis-statement. This plan is for illustrative purposes only and should be used as such by any prospective purchaser. The services, systems and appliances shown have not been tested and no guarantee as to their operability or efficiency can be given.  
Made with Metropix ©2024

## Area Map

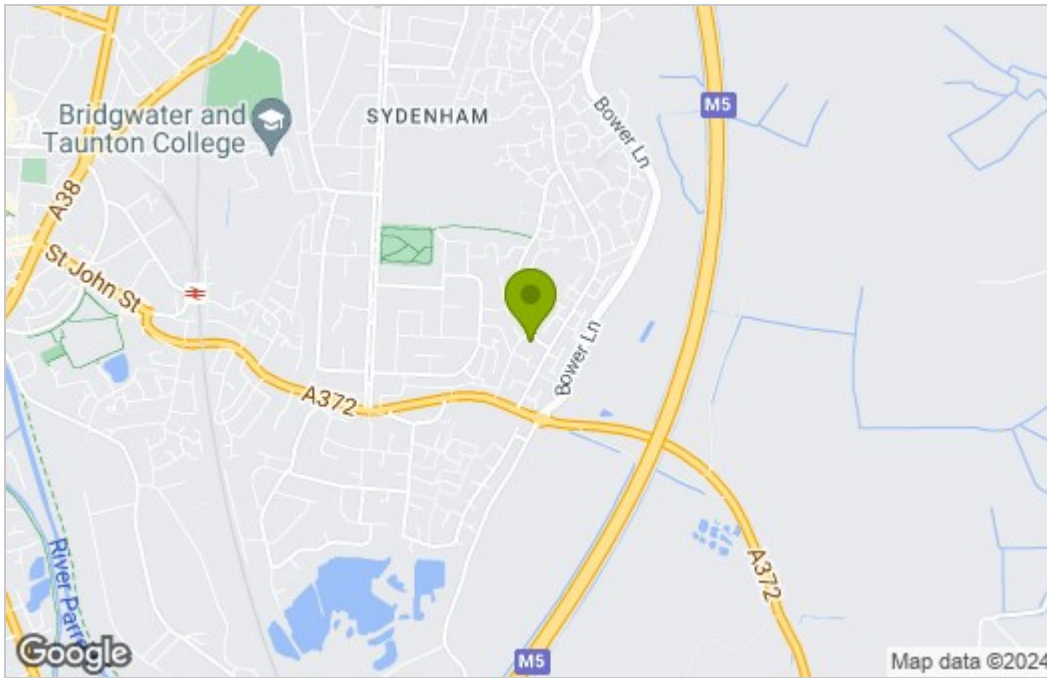

## Energy Efficiency Graph

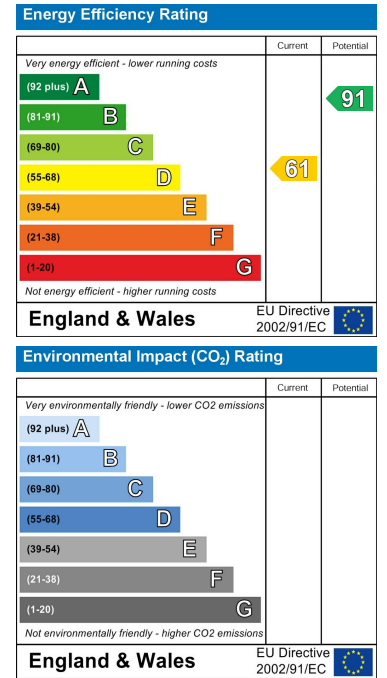

For clarification we wish to inform prospective purchasers that we have prepared these sales particulars as a general guide. The agent has not tested any appliances or services, heating systems etc so cannot verify if they are in working order, nor have we carried out a survey. Room sizes should not be relied upon for carpets and furnishings, if there are important matters which are likely to affect your decision to buy, please contact us or obtain verification from your Solicitor or Surveyor.  
References to the Tenure of a Property are based on information supplied by the Seller.