

  
**Natasha Howarth**  
ESTATE AGENTS



6 Caradon Place, Bridgwater, TA6 3TW

**£1,150 Per month**

Natasha Howarth Estate Agents have available to let this well-presented, three bedroom semi-detached house with garage and parking on The Cloisters development, just off the NDR.

The property benefits from being fully double glazed and served by gas central heating in part. Bedrooms two and three have wall mounted electric heaters. There are also solar panels that will help with the bills. Externally there is a well proportioned and private rear garden, a garage and off road parking.

Set in a small and quiet cul de sac within the favoured 'Cloisters' development there are good local amenities as well as a gym with swimming pool at nearby Chilton Trinity School. HPC pick up points close by and links to the M5 for commuters.



# Floor Plan

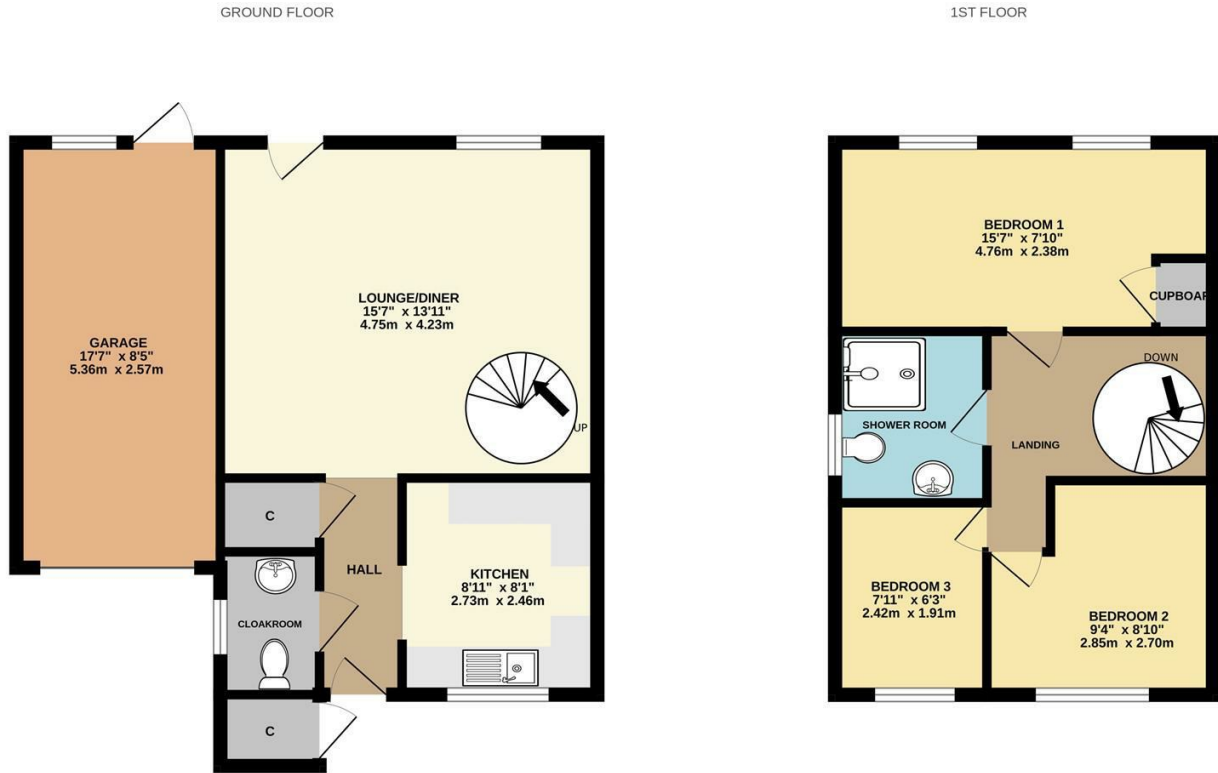

Whilst every attempt has been made to ensure the accuracy of the floorplan contained here, measurements of doors, windows, rooms and any other items are approximate and no responsibility is taken for any error, omission or mis-statement. This plan is for illustrative purposes only and should be used as such by any prospective purchaser. The services, systems and appliances shown have not been tested and no guarantee as to their operability or efficiency can be given.  
Made with Metropix ©2024

# Area Map



# Energy Efficiency Graph

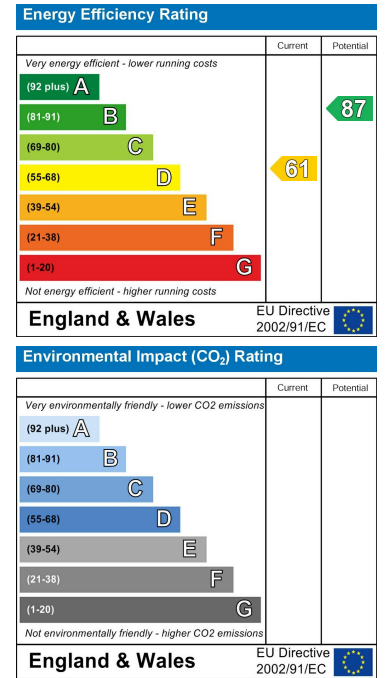

For clarification we wish to inform prospective purchasers that we have prepared these sales particulars as a general guide. The agent has not tested any appliances or services, heating systems etc so cannot verify if they are in working order, nor have we carried out a survey. Room sizes should not be relied upon for carpets and furnishings, if there are important matters which are likely to affect your decision to buy, please contact us or obtain verification from your Solicitor or Surveyor.  
References to the Tenure of a Property are based on information supplied by the Seller.



01278 574562 07710 392220  
sales@nhowarthestateagents.co.uk  
www.natashowarthestateagents.co.uk

