

oakheart

£270,000

Guide Price
Nayland Road, Mile End



Guide Price: £270,000 - £280,000.

A distinctive and well-presented two bedroom detached house, ideally situated in the ever-popular Mile End area to the North of Colchester. This charming home provides excellent access to a range of local amenities including highly regarded schools, shops, and Colchester General Hospital. Commuters will appreciate the convenient links to the A12 and the nearby North Station, offering direct mainline services to London Liverpool

Street.

The property boasts a unique layout, with the ground floor comprising a spacious open-plan living and dining area, complemented by a convenient cloakroom. A striking spiral staircase leads to the first floor, where you will find two well-proportioned bedrooms, a modern fitted kitchen, and a contemporary family bathroom.

Externally, the home is further enhanced by a fully enclosed rear garden, featuring a patio area, well-maintained lawn, and a raised stoned section—perfect for outdoor entertaining. There is also rear access into the garage. To the front of the property, additional front access to the garage.

This unique property offers a rare opportunity to acquire a detached home in a prime location and would make an ideal first-time purchase, downsize or investment.









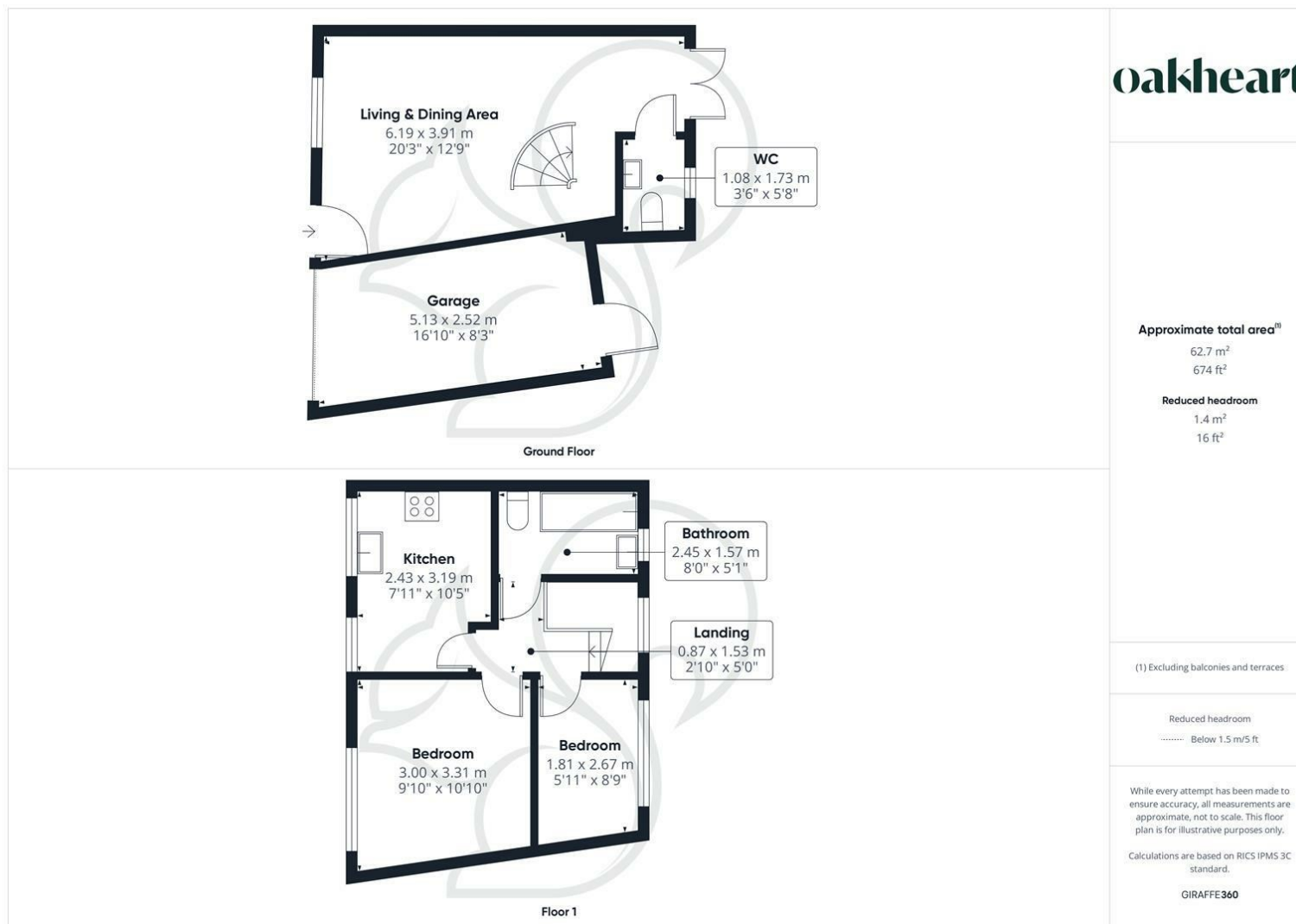

Local Authority:
Colchester

Tenure:
Freehold

Council Tax Band:
C

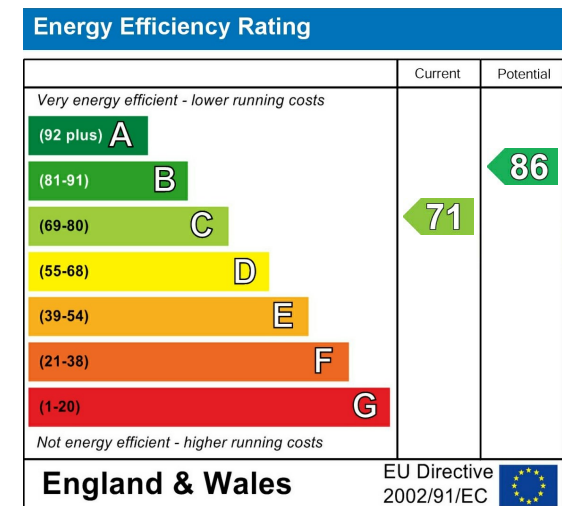

Agents Note: Whilst every care has been taken to prepare these particulars, they are for guidance purposes only. All measurements are approximate and are for general guidance purposes only and whilst every care has been taken to ensure their accuracy, they should not be relied upon.

Oakheart Colchester
01206 803 308
colchester@oakheart.co.uk
2b Cotman Road, Colchester, Essex, CO3 4QJ

oakheart