

oakheart



£1,200 Per Month

Per Month

Victoria Esplanade, West Mersea

This stunning two double-bedroom first-floor apartment offers captivating panoramic views of the estuary. Boasting a balcony, this recently refurbished residence exudes modernity and comfort.

The refurbishment includes double glazing throughout, ensuring insulation and noise reduction while maximising natural light. The interior has been tastefully decorated, presenting a fresh and inviting

ambience. Additionally, new electric radiators have been installed, providing efficient heating solutions.

This spacious apartment comprises two double bedrooms, offering ample space for relaxation and rest. The principal bedroom features an ensuite, enhancing privacy and convenience for the occupants.

Convenience is further emphasised by the inclusion of a

carport, providing secure parking for residents.

Overall, this property offers a blend of contemporary living, breathtaking views, and practical amenities, making it an ideal choice for those seeking comfort and style in the charming locale of West Mersea, Essex.

Offered either furnished or unfurnished and available towards the end of July. Call the Oakheart lettings team for further information.









GROUND FLOOR
704 sq.ft. (65.4 sq.m.) approx.

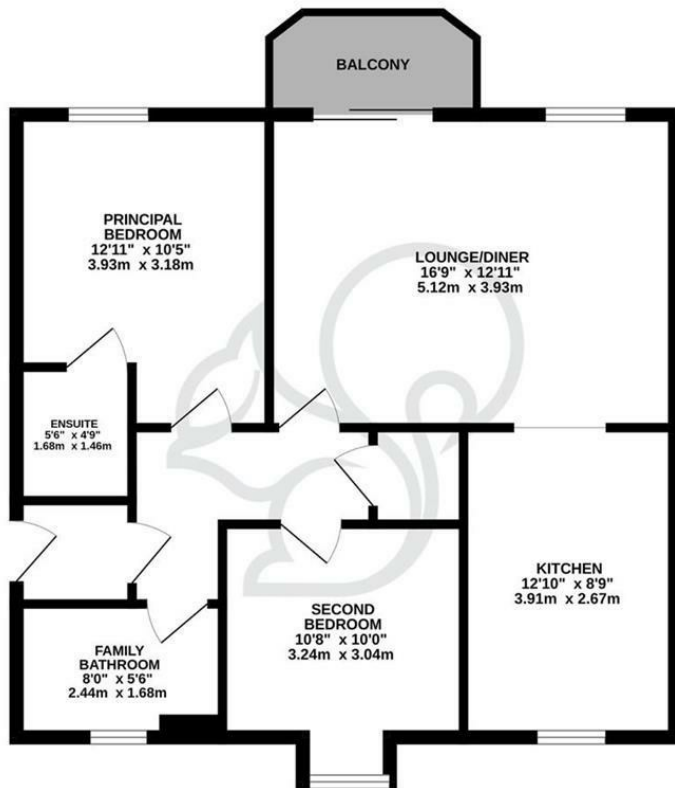

TOTAL FLOOR AREA: 704 sq.ft. (65.4 sq.m.) approx.

Whilst every attempt has been made to ensure the accuracy of the floorplan contained here, measurements of doors, windows, rooms and any other items are approximate and no responsibility is taken for any error, omission or mis-statement. This plan is for illustrative purposes only and should be used as such by any prospective purchaser. The services, systems and appliances shown have not been tested and no guarantee as to their operability or efficiency can be given.
Made with Metropix ©2024

Local Authority:
Colchester

Tenure:

Council Tax Band:
B

Energy Efficiency Rating

	Current	Potential
<i>Very energy efficient - lower running costs</i>		
(92 plus) A		
(81-91) B		
(69-80) C		
(55-68) D	62	67
(39-54) E		
(21-38) F		
(1-20) G		
<i>Not energy efficient - higher running costs</i>		
England & Wales	EU Directive 2002/91/EC	

Agents Note: Whilst every care has been taken to prepare these particulars, they are for guidance purposes only. All measurements are approximate and are for general guidance purposes only and whilst every care has been taken to ensure their accuracy, they should not be relied upon.

Oakheart Lettings - Colchester
01206 803 303
lettings@oakheartproperty.co.uk
2b Cotman Road, Colchester, Essex, CO3 4QJ

oakheart