

oakheart



£600,000

Offers In Excess Of
Baxter Chase, Elmstead

Discover the epitome of luxury living in this stunning five-bedroom, three-bathroom double-fronted detached home, nestled within the charming countryside village of Elmstead Market. Immaculately designed, this residence not only offers exceptional living spaces but also provides a haven for entertainment and relaxation. Its strategic location ensures the convenience of proximity to high-performing schools, local amenities, the A120, and the Alresford & Wivenhoe Train Station.









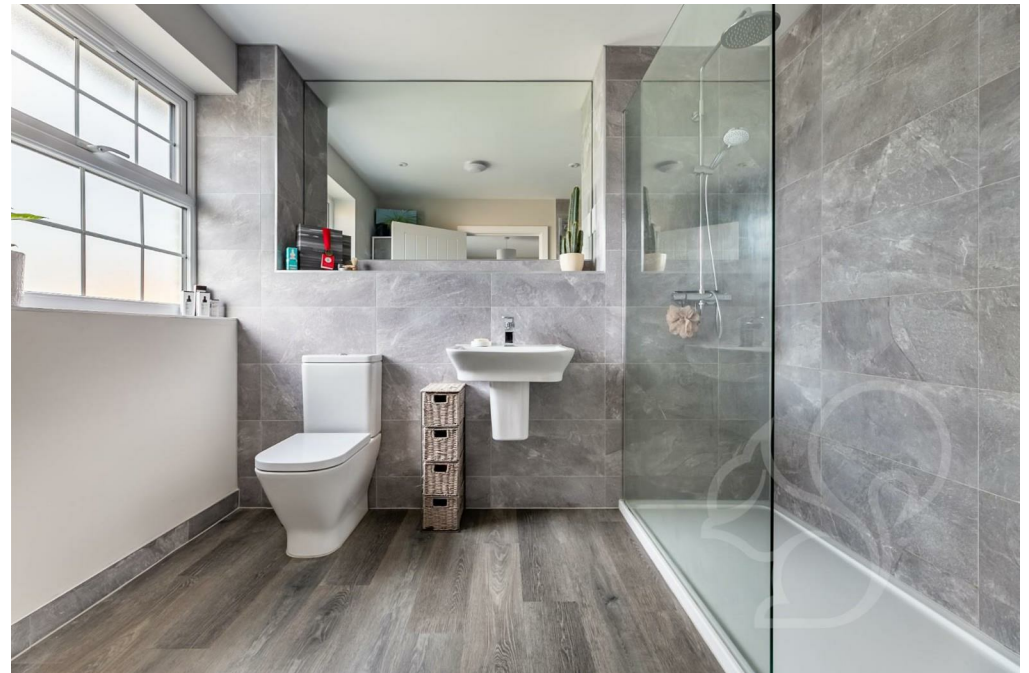







GROUND FLOOR
1020 sq.ft. (94.8 sq.m.) approx.

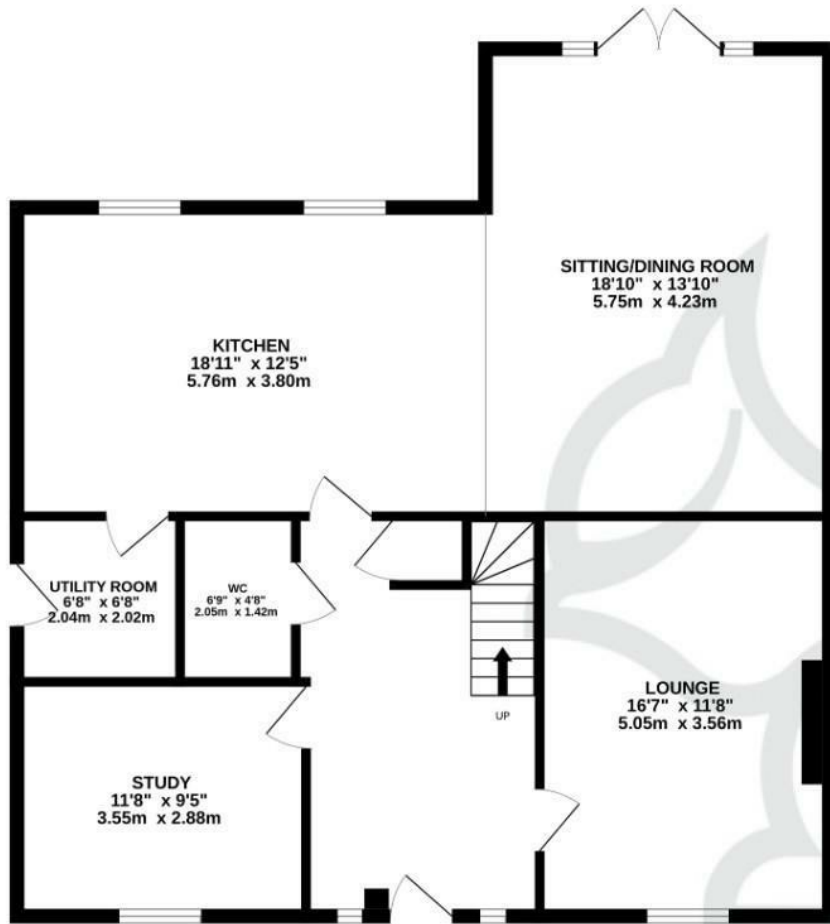

FIRST FLOOR
1003 sq.ft. (93.2 sq.m.) approx.

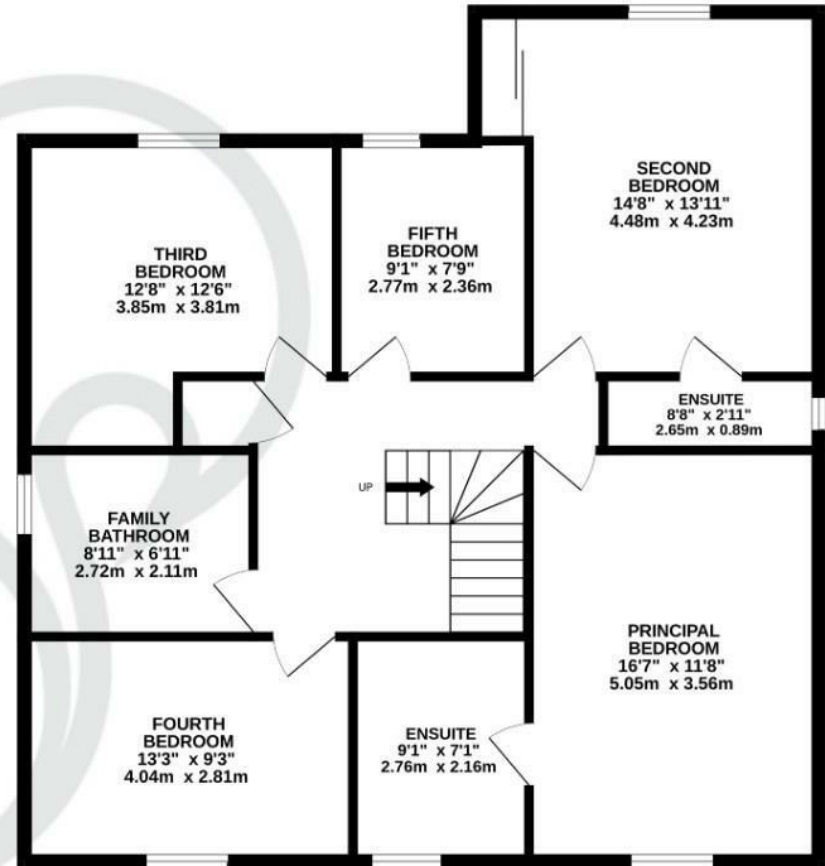

TOTAL FLOOR AREA : 2023 sq.ft. (188.0 sq.m.) approx.

Whilst every attempt has been made to ensure the accuracy of the floorplan contained here, measurements of doors, windows, rooms and any other items are approximate and no responsibility is taken for any error, omission or mis-statement. This plan is for illustrative purposes only and should be used as such by any prospective purchaser. The services, systems and appliances shown have not been tested and no guarantee as to their operability or efficiency can be given.

Made with Metropix ©2023

Local Authority:
Tendring

Tenure:
Freehold

Council Tax Band:
G



Energy Efficiency Rating

	Current	Potential
<i>Very energy efficient - lower running costs</i>		
(92 plus) A		93
(81-91) B	86	
(69-80) C		
(55-68) D		
(39-54) E		
(21-38) F		
(1-20) G		
<i>Not energy efficient - higher running costs</i>		
England & Wales	EU Directive 2002/91/EC	

Agents Note: Whilst every care has been taken to prepare these particulars, they are for guidance purposes only. All measurements are approximate and are for general guidance purposes only and whilst every care has been taken to ensure their accuracy, they should not be relied upon.

oakheart

Oakheart Colchester

01206 803 308

colchester@oakheartproperty.co.uk

2b Cotman Road, Colchester, Essex, CO3 4QJ