

ANWYL  
thoughtful homes



## the lymm

4 bed detached with garage

A *spacious* 4-bedroom detached home. The Lymm is thoughtfully designed to make the most of the space available, providing a well-planned open plan living space and a separate lounge in which to relax. Boasting 4 generously sized bedrooms, integral garage, lovely high ceilings and a roofed porch the lymm is designed for today's family.

[www.anwylhomes.co.uk](http://www.anwylhomes.co.uk)

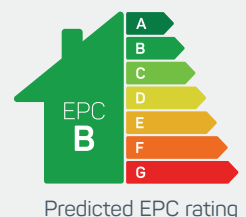

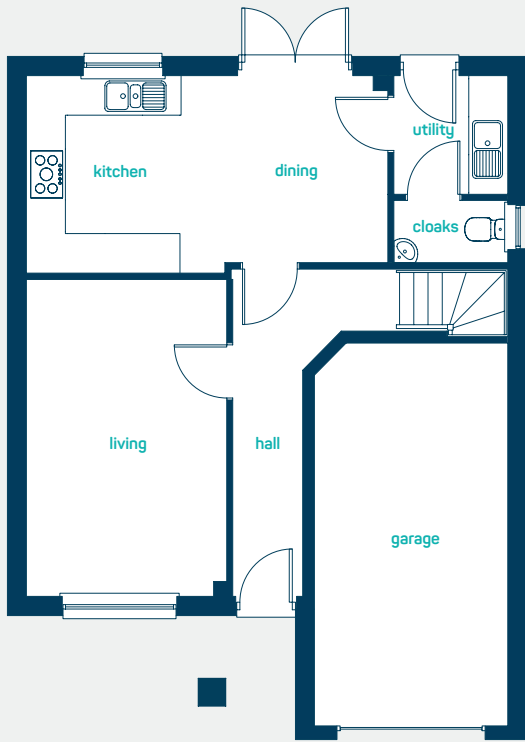

large open plan  
*kitchen diner*

### ground floor

kitchen/dining	18'11" x 10'1"
utility	5'11" x 6'1"
living room	10'5" x 16'3"
cloaks	5'11" x 3'2"

kitchen/dining	5.76m x 3.07m
utility	1.80m x 1.85m
living room	3.18m x 4.96m
cloaks	1.80m x 0.96m

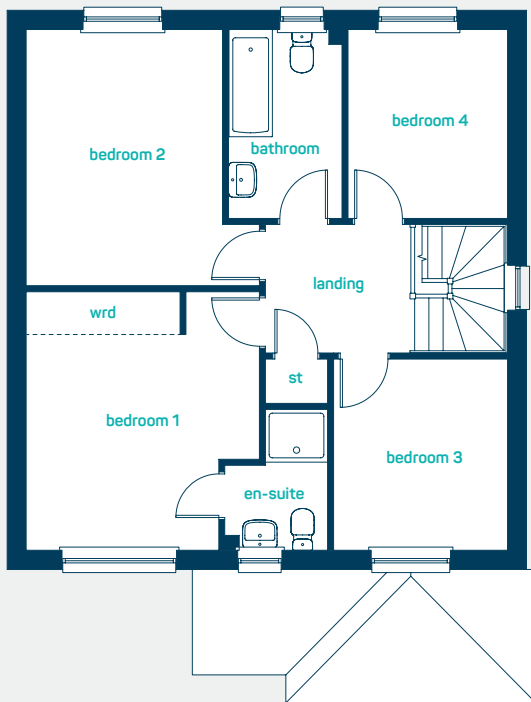

### first floor

bedroom 1	12'2" x 13'4"
en-suite	5'5" x 7'3"
bedroom 2	12'2" x 13'2"
bedroom 3	9'1" x 9'10"
bedroom 4	8'4" x 9'9"
bathroom	6'0" x 9'9"

bedroom 1	3.71m x 4.06m
en-suite	1.65m x 2.20m
bedroom 2	3.71m x 4.02m
bedroom 3	2.76m x 3.00m
bedroom 4	2.53m x 2.96m
bathroom	1.82m x 2.96m

**the lymm**  
4 bed detached with garage

**ANWYL**  
thoughtful homes

**NEW HOMES QUALITY CODE**

**NEW HOMES OMBUDSMAN SERVICE**

[www.anwylhomes.co.uk](http://www.anwylhomes.co.uk)

Anwyl Homes is a Registered Developer with the NHQB. This is a computer-generated image of the lymm, elevation treatment may vary. Room sizes are approximate, dimensions are taken from the longest room point (please consult homes advisor for measurement points). Plots may be handed and any garages may be single or double. Kitchen and bathroom layouts are indicative. These plans are correct at the time of going to press, but may be subject to change during construction. Please ensure that you check for specific plot details. 18/07/23 (grand version).

*everything considered.*