



Oakridge Road, Ushaw Moor, DH7

£190,000



EPC rating: D

- 2 Bedroom Detached Bungalow
- Single Garage With Driveway

- For Sale With No Onward Chain

Description

Offered for sale with no onward chain, we are proud to bring to market this uniquely designed detached bungalow, located in a highly desirable estate in Ushaw Moor. While the property requires some cosmetic modernizing, it presents a fantastic opportunity for buyers to renovate to their liking.

The generous layout includes a large open foyer, generously sized lounge / living room, bespoke kitchen, two well-proportioned double bedrooms, a shower room and a rear lobby perfect for storage.

Nestled in a quiet and quaint estate, the property offers a great balance of tranquility with urban convenience. Set in a peaceful and picturesque location, the home is only a stone's throw away from Durham City which itself boasts a wide range of shops, restaurants and bars. Excellent schools are located nearby, along with convenient local amenities. The property is also easily accessible to the A690 highway, offering great travel routes for commuting to both northern and southern destinations. The location of the bungalow, coupled with both the beautiful surroundings and strong transport links, make the property an attractive choice for professionals, families or investors.

Externally the property enjoys a large rear garden which provide sweeping views of the landscape as well as a single integral garage.

We highly recommend a viewing to fully appreciate the potential of this property.

Floorplan

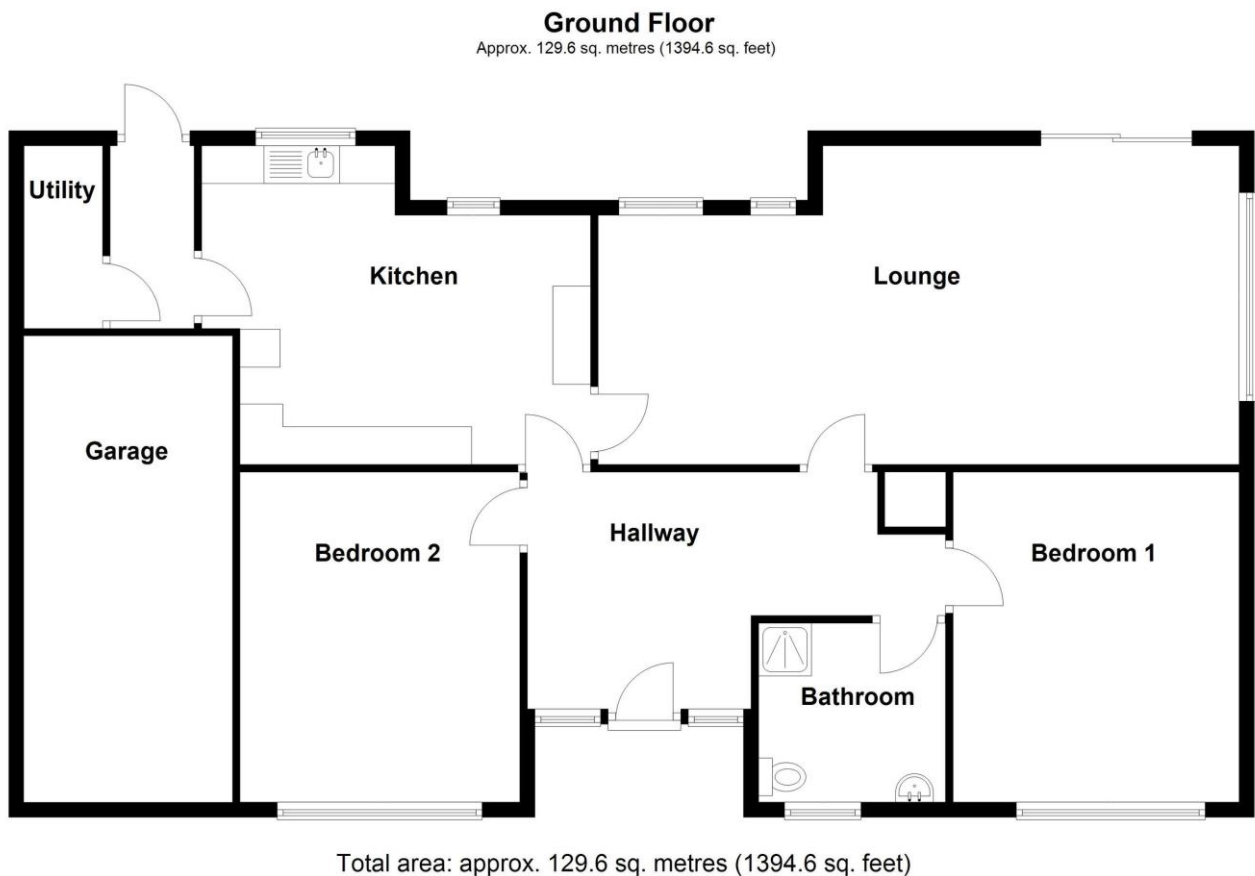

Photographs



Map

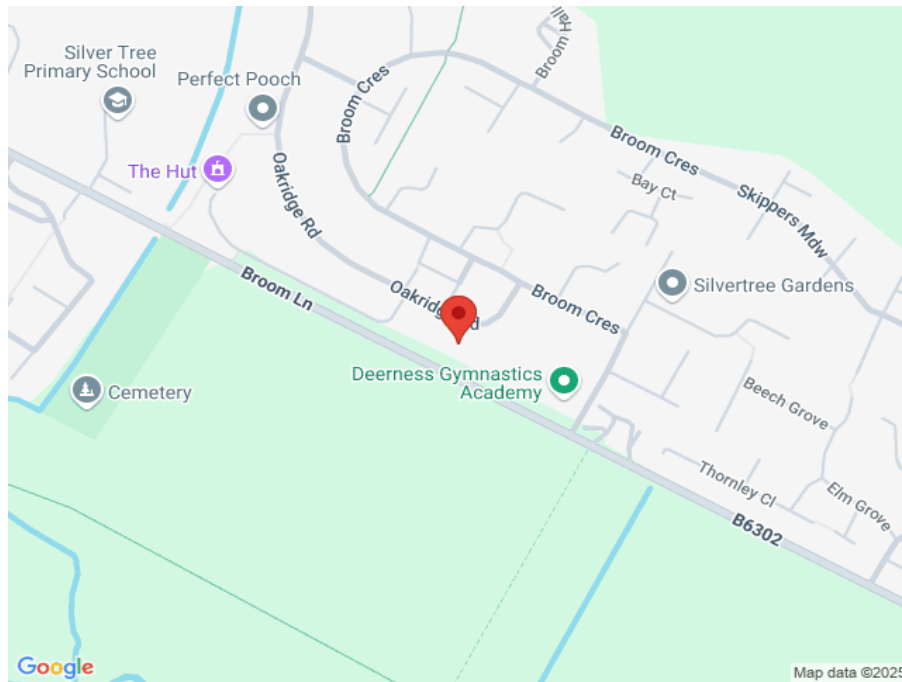

Notes