



Dan Thomas
— & Co. —



Caxton Park, Northfleet, Gravesend, Kent, DA11 8GA

Gravesend

£375,000

Bedrooms: 2 | Bathrooms: 1 | Receptions: 1

Situated within the popular Springhead Park development, this stylish two-bedroom end-of-terrace home offers contemporary living in an excellent location, ideal for commuters, families, and first-time buyers alike.

The ground floor welcomes you with a generous entrance hallway, offering space for practical storage for coats and shoes, along with a convenient downstairs toilet. The ultra-modern kitchen is a real focal point of the home, featuring a central breakfast bar that lends itself perfectly to entertaining and social gatherings. This flows seamlessly into the expansive open-plan living area, where an abundance of natural light floods in through double doors and Velux windows, enhancing the sense of space and comfort.

Leading out from the living area is a private rear garden, a true sun trap providing the ideal setting to relax, unwind, or enjoy outdoor dining.

Upstairs, the property features two well-proportioned double bedrooms, both finished to a high standard, with bedroom one benefiting from fitted wardrobes, alongside a sleek and contemporary family bathroom.

Externally, the home benefits from a garage nearby, providing secure parking as well as additional storage. A children's play park is conveniently located close by, along with access to excellent local schools, making this an ideal home for families.

For commuters, Ebbsfleet International Station is within walking distance, offering high-speed services into London St Pancras within 19-minutes. The A2 and M25 are easily accessible, while Bluewater Shopping Centre is just a 10-minute drive, offering a wide selection of shops, restaurants, and leisure facilities.

This property presents an excellent opportunity as a first-time purchase, family home, or investment, set within a well-connected and highly desirable neighbourhood.

Tenure: Freehold

Council Tax Band: C









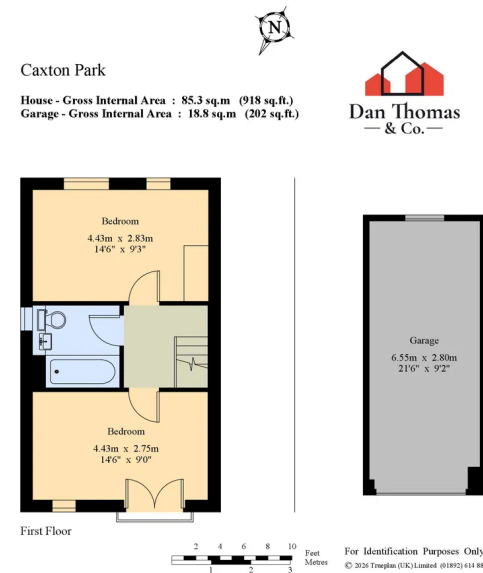
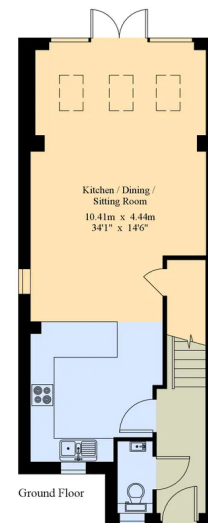
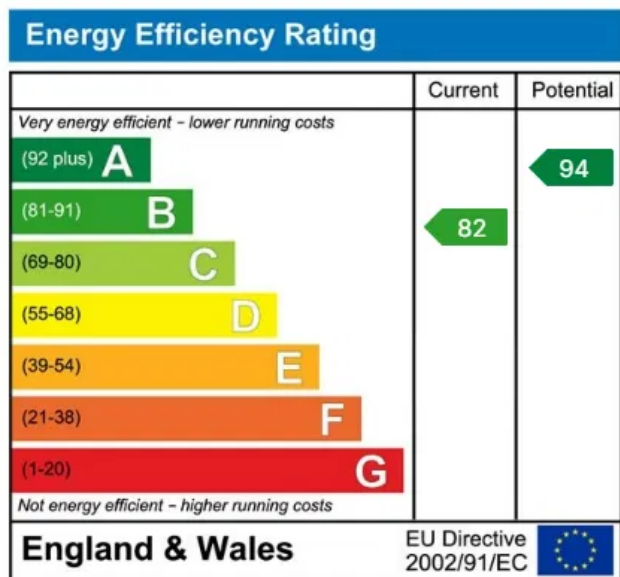

Dan Thomas & Co
8A Station Road
Longfield
Kent
DA3 7QD

Dan Thomas & Co Ltd. Registered in England and Wales - 12734131
Registered Office: 8A Station Road, Longfield, Kent, DA3 7QD



T: 01474 636300
E: info@danthomasandco.co.uk
www.danthomasandco.co.uk