



APX PROPERTIES
LOCAL | TRUSTED | EXPERTS



Carters Hill Close, London - SE9 4RS

£1,600 PCM

London



Welcome to this charming 2-bedroom maisonette located on a quiet cul-de-sac, offering a perfect retreat for a small family. Situated on the 1st floor and spanning over two levels, this home boasts fantastic living space that is both cosy and inviting. The property features a private balcony, ideal for enjoying your morning coffee or unwinding after a long day.

The interior is designed with comfort in mind, with a well-appointed kitchen, a convenient downstairs W.C, and an upstairs family bathroom. This home is perfect for those seeking a balance between convenience and tranquillity.

Council Tax band: C

Tenure: Leasehold

EPC Energy Efficiency Rating: C

EPC Environmental Impact Rating: D

- *1st Floor Maisonette
- *Fantastic Living Space
- *Set Over Two Floors
- *Private Balcony
- *Upstairs Family Bathroom
- *Downstairs Separate W.C
- *Good Size Kitchen
- *Set on a Quiet Cul-De-Sac
- *Perfect for a Small Family



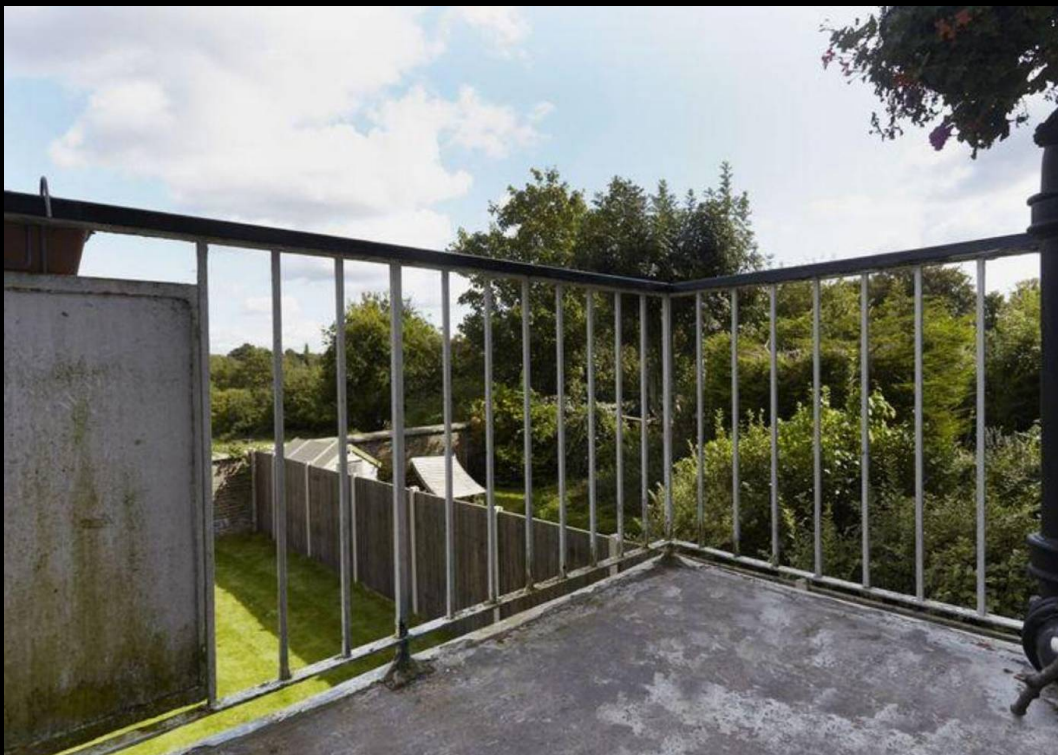

First Floor

Approx. 32.6 sq.metres (350.4 sq.feet)

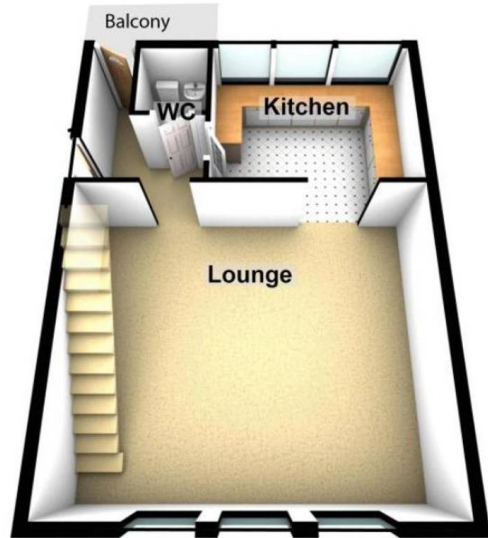

Second Floor

Approx. 37.4 sq.metres (403.0 sq.feet)

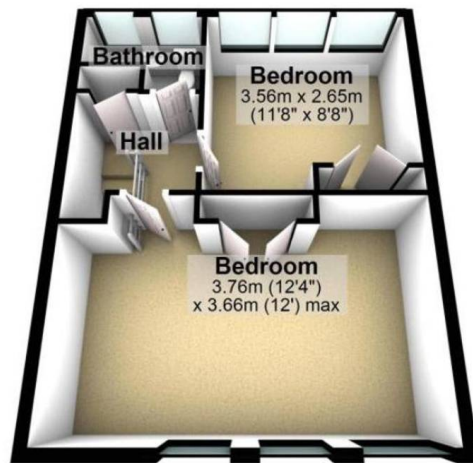

First Floor

Approx. 32.6 sq.metres (350.4 sq.feet)

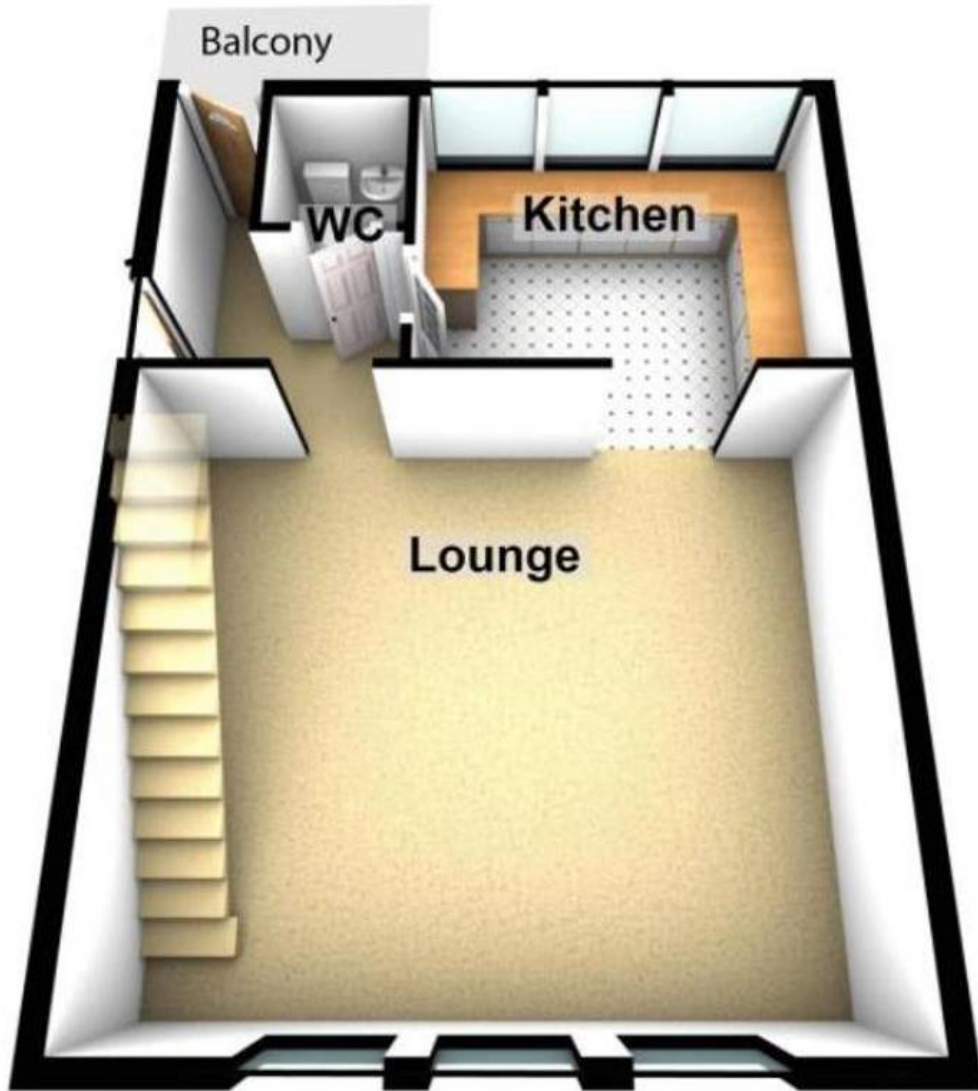

Second Floor

Approx. 37.4 sq.metres (403.0 sq.feet)

