



APX PROPERTIES

LOCAL | TRUSTED | EXPERTS



Hatfield Close, London, SE14 5DW

£300,000



Hatfield Close, London, SE14 5DW

£300,000

Guide Price £300,000 - £325,000

This purpose-built flat on the 12th floor offers a fantastic opportunity for both investors and first-time buyers alike.

Upon entering, you are greeted by a spacious living room, perfect for relaxing or entertaining guests. The property boasts two cosy bedrooms, ideal for a small family or as a guest room/home office combination. The bathroom is well-maintained, ensuring your comfort and convenience with a separate W.C.

One of the highlights of this flat is the great kitchen with a dining area, providing the perfect space to whip up delicious meals and enjoy them with loved ones. The entire property is in great condition, meaning you can move in hassle-free and start enjoying your new home right away.

Whether you are looking to invest in the bustling London property market or searching for your first home, this flat offers the perfect blend of comfort and convenience. Don't miss out on this opportunity to own a piece of London living at its finest!

- *Great Condition
- *117 Years Remaining Lease
- *£1,618.31 Annual Service Charge
- *Peppercorn Ground Rent
- *Two Double Bedrooms
- *Fantastic Living Space
- *Bathroom and Separate W.C
- *Kitchen / Dining Room
- *12th Floor
- *Ideal for First Time Buyers and Buy to Let Investors



Floor Plans

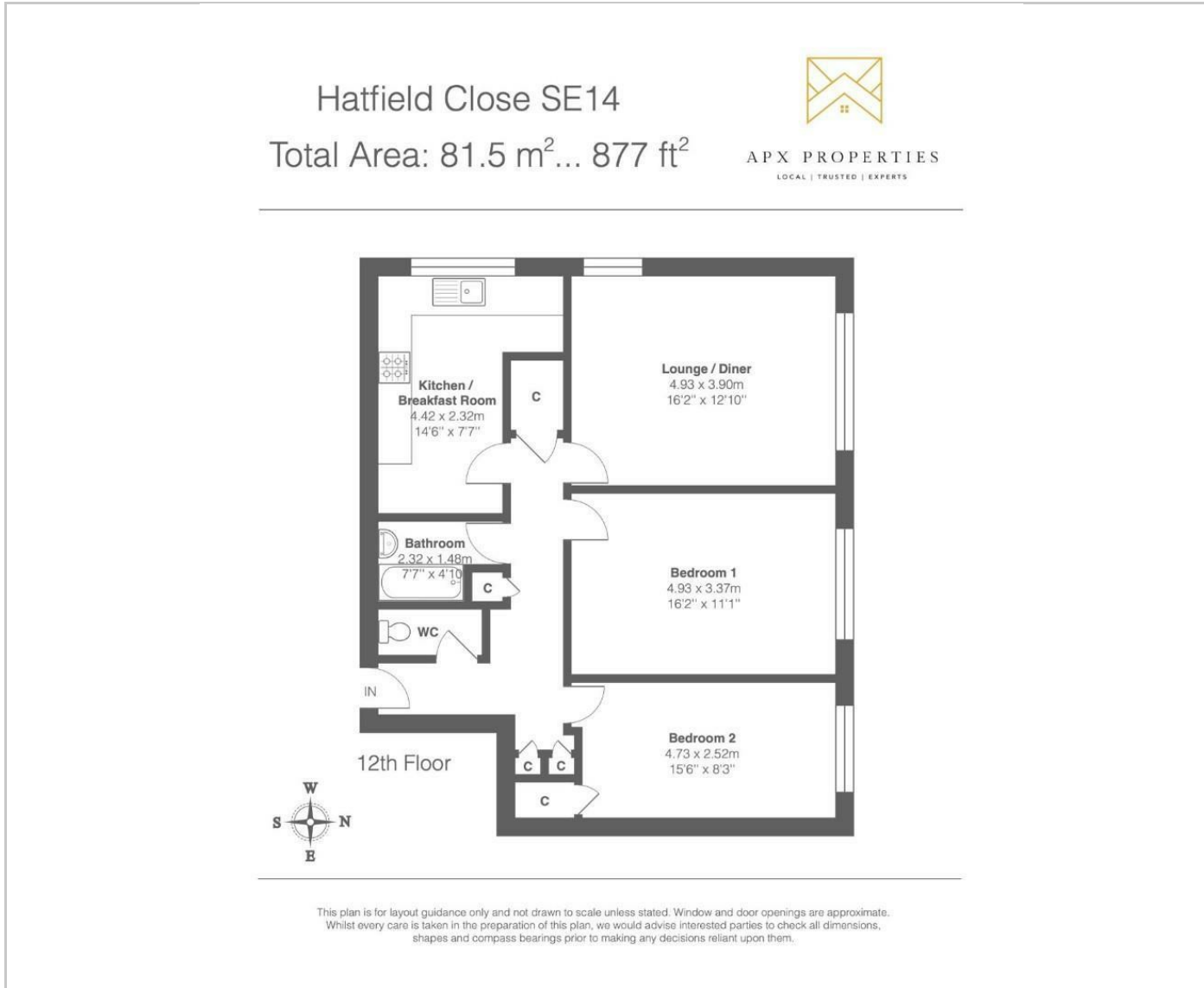

Area Map

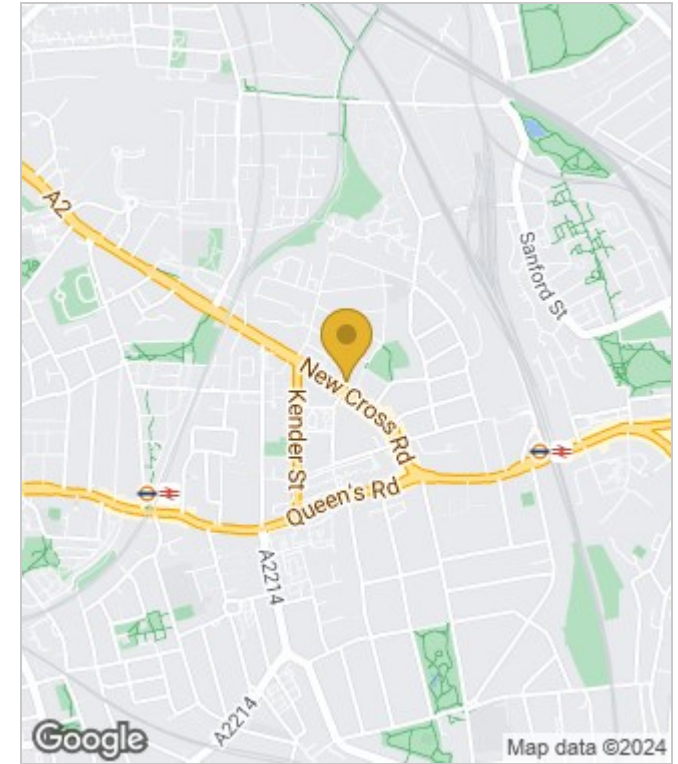

Energy Performance Graph

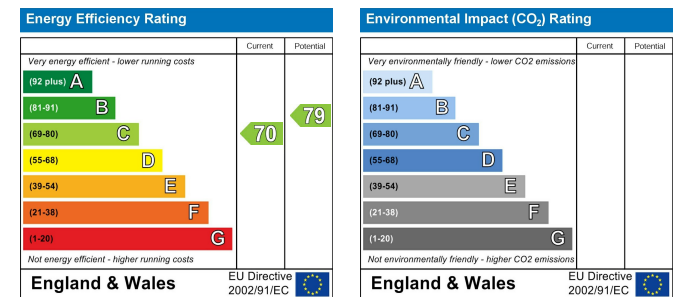

These particulars, whilst believed to be accurate are set out as a general outline only for guidance and do not constitute any part of an offer or contract. Intending purchasers should not rely on them as statements of representation of fact, but must satisfy themselves by inspection or otherwise as to their accuracy. No person in this firm's employment has the authority to make or give any representation or warranty in respect of the property.

SALES 0203 7450 811

LETTINGS 0203 7450 812

MORTGAGES 0203 7450 815

E info@apxproperties.co.uk

W www.apxproperties.co.uk

424 Downham Way
Bromley, Kent, BR1 5HR

APX ESTATE AGENTS LTD is trading as APX Properties. Registered in England no: 11596814.

Registered Office : 424 Downham Way, Bromley, Kent, BR1 5HR

