



challenger burgess
ESTATE AGENTS

Phoenix Way, Portishead, Bristol, BS20 7JX

Guide Price £550,000

🛏️ 4 🚿 2 🚗 2



- Detached Town House
- Four Double Bedrooms
- Open Plan Kitchen / Dining / Family Room
- Utility Room
- Stylish Upgraded Bathrooms
- Single Garage & Parking
- Freehold
- Council Tax Band



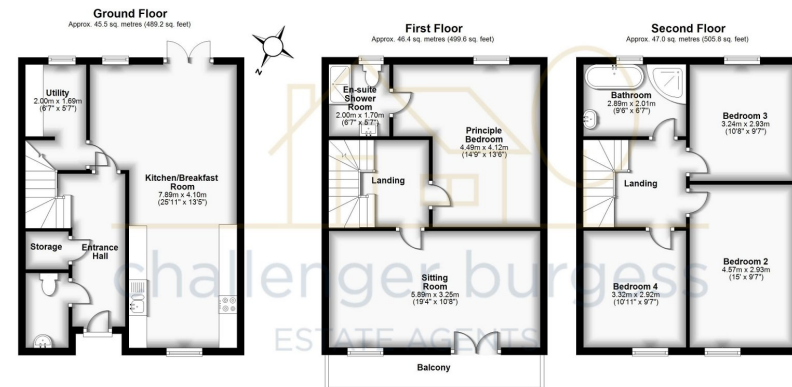

Total area: approx. 138.9 sq. metres (1494.6 sq. feet)

Situated on the desirable tree lined Phoenix Way is this substantial, well proportioned detached four bedroom family home. Located within a stones throw from the Nature Reserve, Portishead's Vibrant Marina, Sainsbury's and Waitrose supermarkets and within catchment of Trinity Primary & Gordano School.

Score	Energy rating	Current	Potential
92+	A		
81-91	B		84 B
69-80	C	76 C	
55-68	D		
39-54	E		
21-38	F		
1-20	G		