



75 LOCKSIDE MARINA

ESSEX, CM2 6HF

£260,000
LEASEHOLD

Nestled within the popular Lockside Marina in Chelmsford, this modern apartment offers a delightful blend of comfort and convenience. Spanning an impressive 640 square feet, the property features two well-appointed bedrooms, making it an ideal choice for couples, small families, or professionals seeking a peaceful and serene environment.

Upon entering the apartment, you are welcomed into a spacious reception room that provides a perfect setting for relaxation or entertaining guests. The contemporary design is complemented by ample natural light, creating a warm and inviting atmosphere throughout the home and also extends to a large, private balcony. The apartment boasts two stylish bathrooms, and has an allocated parking space for one vehicle.

DouglasPryce

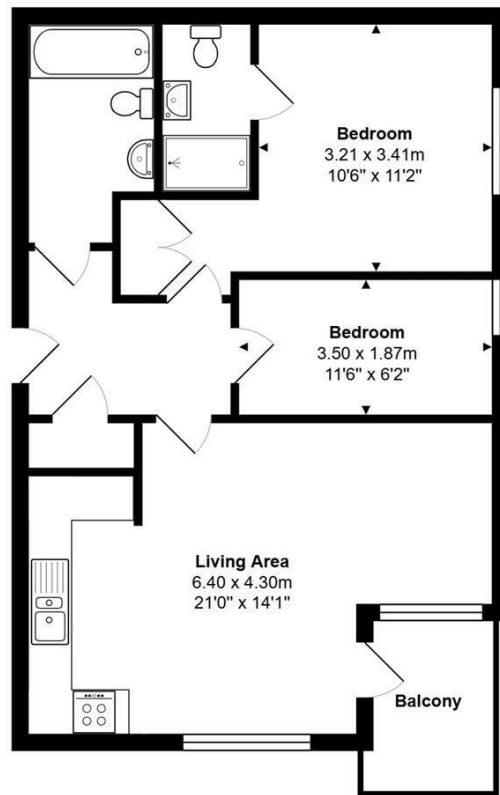

Total Area: 59.5 m² ... 640 ft² (excluding balcony)

Measurements are approximate for illustrative purposes only and may have been taken from the widest area
 Floorplan Copyright The Estate Agents Photographer
www.theestatesagentsphotographer.co.uk



Energy Efficiency Rating		
	Current	Potential
Very energy efficient - lower running costs		
(92 plus) A		
(81-91) B	81	81
(69-80) C		
(55-68) D		
(39-54) E		
(21-38) F		
(1-20) G		
Not energy efficient - higher running costs		
England & Wales	EU Directive 2002/91/EC	

Agents Note: Whilst every care has been taken to prepare these particulars, they are for guidance purposes only. All measurements are approximate and are for general guidance purposes only and whilst every care has been taken to ensure their accuracy, they should not be relied upon and potential buyers/tenants are advised to recheck the measurements

Sales
 Verdant Lane
 London
 SE6 1LF

07887933642
glenn@douglaspryce.co.uk
www.douglaspryce.co.uk

DouglasPryce