



65 HONOR OAK RISE

LONDON, SE23 3RA

£399,995
LEASEHOLD

Situated between Forest Hill, Peckham Rye and Brockley comes this two bedroom property, which is set on the 5th floor of a charming residential block. With far reaching views of South East London and beyond, the property consists of two good-sized bedrooms, a family bathroom and an open plan kitchen/living room.

The property is close to a selection of train stations, with Honor Oak Park (0.3mi), Forest Hill (0.8mi) and Brockley (0.8mi) all nearby and providing services in to Central London.

DouglasPryce

Honor Oak Rise, SE23

Approximate Area = 711 sq ft / 66.1 sq m

For identification only - Not to scale

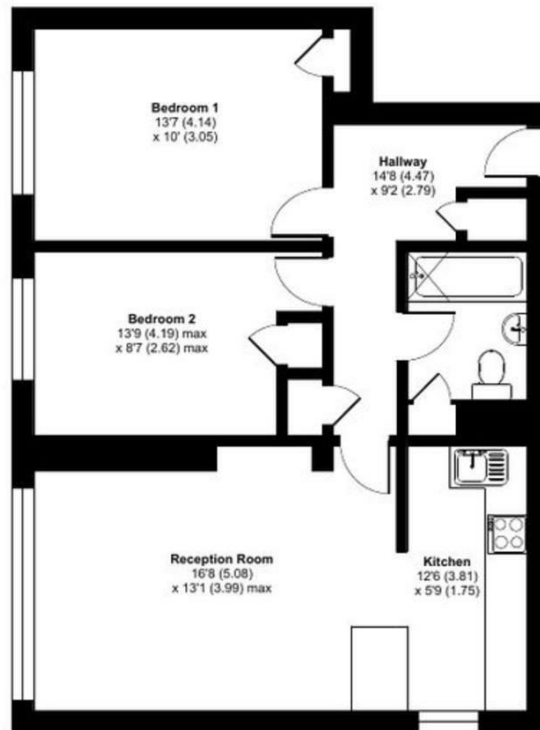

Energy Efficiency Rating		
	Current	Potential
Very energy efficient - lower running costs		
(92 plus) A		
(81-91) B		
(69-80) C		
(55-68) D		
(39-54) E		
(21-38) F		
(1-20) G		
Not energy efficient - higher running costs		
England & Wales	EU Directive 2002/91/EC	

Agents Note: Whilst every care has been taken to prepare these particulars, they are for guidance purposes only. All measurements are approximate and are for general guidance purposes only and whilst every care has been taken to ensure their accuracy, they should not be relied upon and potential buyers/tenants are advised to recheck the measurements

Sales
Verdant Lane
London
SE6 1LF

07887933642
glenn@douglaspryce.co.uk
www.douglaspryce.co.uk

DouglasPryce