

7 Carr Green Lane,
Mapplewell S75 6DY

OFFERS AROUND
£250,000



****NO ONWARD CHAIN** THIS STUNNING THREE BEDROOM SEMI-DETACHED PROPERTY HAS BEEN TASTEFULLY DECORATED THROUGHOUT AND IS JUST READY TO MOVE INTO, IT BOASTS A FANTASTIC OPEN PLAN LIVING DINING KITCHEN, LOW MAINTENANCE GARDEN, A GARAGE AND DRIVEWAY PARKING. FREEHOLD / COUNCIL TAX BAND B / ENERGY RATING C**

PAISLEY
PROPERTIES

LOUNGE 13'8" x 16'11" max

You enter the property through a composite door into the spacious lounge which is positioned to the front with a window looking out onto the street. Practical light wood herringbone effect LVT flooring runs underfoot and continues into the dining kitchen. Cupboards under the stairs provide a fabulous storage space for household items. Neutrally decorate and with an air of luxury, there is an abundance of space for lounge furniture. A striking carpeted staircase in a combination of timber and black metal ascends to the first floor and a large square opening leads to the dining kitchen.



DINING KITCHEN 17'0" x 8'9" max

This spacious dining kitchen spans the rear of the property and is flooded with natural light from a window and a glazed door to the garden as well as an exterior door which leads to the driveway. The kitchen is fitted with a striking blend of matt black units and white marble effect slimline worktops and upstands with a black composite sink and drainer with a satin chrome mixer tap. Cooking facilities comprise of an electric fan oven, an integrated microwave and an induction hob with a black canopy hood extractor fan over. Integrated appliances include a dishwasher, washing machine and fridge freezer. A large built in cupboard houses the boiler and has space for storing household items. Light wood effect herringbone LVT flooring continues underfoot from the lounge.





FIRST FLOOR LANDING 6'7" x 9'6" max

A beautiful wood and metal staircase ascends to the first floor landing which is light and spacious. A side facing window allows natural light to enter and a hatch gives access to the loft. Doors lead to the three bedrooms and house bathroom.

BEDROOM ONE 11'5" x 10'1" max

Positioned to the rear of the property with a window overlooking the garden, this generous double bedroom benefits from mirror sliding wardrobes to one wall which reflect the light beautifully and provide an excellent amount of storage. There is ample space for freestanding bedroom furniture. A door leads to the landing.



BEDROOM TWO 11'1" x 11'1" max

This gorgeous double bedroom is neutrally decorated and benefits from mirror wardrobes for storage. It has a beautiful deep bay window with a varnished timber sill which looks out onto the street and floods the room with light. There is plenty of space for bedroom furniture. A door leads to the hallway.



BEDROOM THREE 7'6" x 7'1" max

Utilised as a dressing room by the current owner, this third bedroom would accommodate a single bed and is night and light courtesy of a front facing window. A highly polished varnished wood floor sets the room off nicely and the window sill has been matched to it, as have the built in storage units attached to a large built in wardrobe. A door leads to the landing.



HOUSE BATHROOM 6'6" x 5'5" max

This contemporary house bathroom is beautifully presented and fitted with a three piece white suite comprising of a low level W.C., a round pedestal wash basin with mixer tap and a bath with mixer taps. The bath is equipped with a thermostatic mixer shower over and a striking black framed glass shower screen. The room is fully tiled with white tiles and there are contrasting dark iridescent ceramic tiles underfoot. A central spotlight fitting and a chrome heated towel rail completes the room. An obscure window allows natural light to enter and a door leads onto the landing.



FRONT, PARKING & GARAGE

To the front of the property is a low maintenance garden area which leads to a driveway running down the side of the property to a single detached garage which has an electric roller shutter door, light, power and a side window and personnel door which allows access from and to the garden.

REAR GARDEN

To the rear of the property is an enclosed garden which has been planned to be low maintenance with a large decked area adjacent to the house perfect for garden furniture and al fresco dining. The rest of the space is laid to gravel with a large decorative paved stone circle adding interest.



~ Agent Notes ~

Please note information within our sales particulars has been provided by the vendors. Paisley Properties have not had sight of the title documents and therefore the buyer is advised to obtain verification from their solicitor. References to the Tenure of the property are based upon information provided by the vendor and again the buyer should obtain verification from their solicitor.

All measurements are approximate and quoted in metric with imperial equivalents and for general guidance only and whilst every attempt has been made to ensure accuracy, they must not be relied on. We advise you take your own measurements prior to ordering any fixtures, fittings or furnishings.

The fixtures, fittings and appliances referred to have not been tested and therefore no guarantee can be given that they are in working order.

Internal photographs are produced for general information and it must not be inferred that any item shown is included with the property.

You are advised to check availability and book a viewing appointment prior to travelling to view.

~ Paisley Properties ~

We are available to do appointments up until 8pm Monday to Friday and up until 4pm Saturday and Sunday so please contact the office if you would like to arrange a viewing. We also offer a competitive sales and letting service, please contact us if you would like to arrange an appointment to discuss marketing your property through Paisley, we would love to help.

~ Paisley Mortgages ~

Mandy Weatherhead at our sister company, Paisley Mortgages, is available to offer clear, honest whole of market mortgage advice. We also run a first time buyer academy to help you prepare in advance for your first mortgage, home-mover and re-mortgage advice. If you would like to speak to Mandy, please contact us on 01484 444188 / 07534 847380 to arrange an appointment.

*Your home may be repossessed if you do not keep up repayments on your mortgage. *

~ Paisley Surveyors ~

We work alongside Michael Kelly at Paisley Surveyors, who can assist you with any survey requirements on your purchase. We offer 3 levels of survey and can be contacted on 01484 501072 / office@paisley-surveyors.co.uk for a free, no obligation quote or for more information.

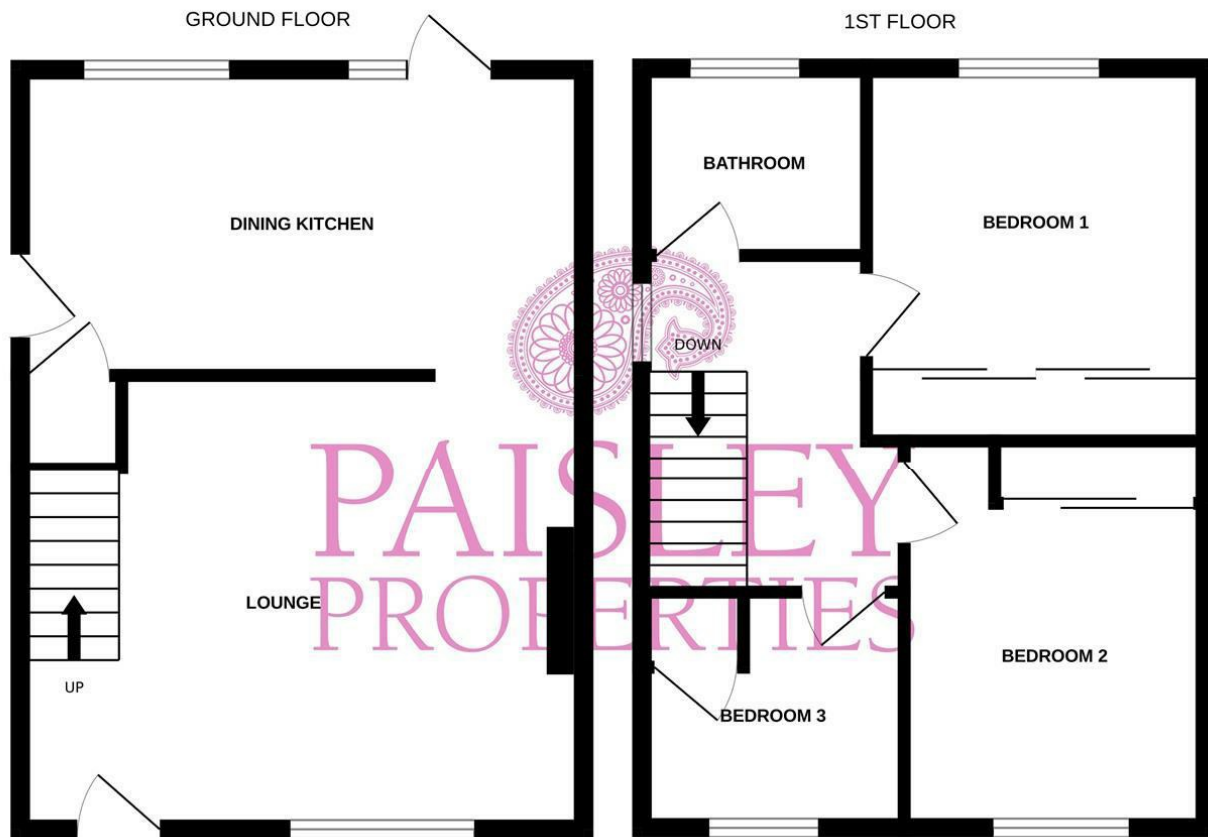

Whilst every attempt has been made to ensure the accuracy of the floorplan contained here, measurements of doors, windows, rooms and any other items are approximate and no responsibility is taken for any error, omission or mis-statement. This plan is for illustrative purposes only and should be used as such by any prospective purchaser. The services, systems and appliances shown have not been tested and no guarantee as to their operability or efficiency can be given.
Made with Metropix ©2024

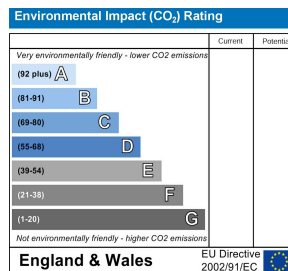
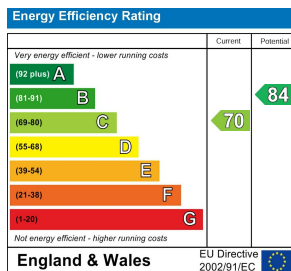

www.paisleyproperties.co.uk

Skelmanthorpe Office:
17 Commercial Road,
Skelmanthorpe, HD8 9DA
t: 01484 443893

Almondbury Office:
75-77 Northgate,
Almondbury, HD5 8RX
t: 01484 443922

Mapplewell Office:
4 Blacker Road,
Mapplewell, S75 6BW
t: 01226 395404

