

**BADEN**  
PLACE  
LONDON SE1



# IN THE HEART OF SOUTHBANK

Baden Place is situated within an attractive courtyard complex on the west side of Crosby Row.

Originally built in the mid-1980s, the property was comprehensively refurbished in 2017, with the accommodation having been maintained to a high standard.

The 13 suites are situated over ground and three upper floors and comprises a U-shaped floor plate.

The available offices, provide a mixture of open plan offices, meeting rooms and break out facilities.

The courtyard has capacity for 6 car parking spaces located in the undercroft, available by separate negotiation, which also comprises cycle storage within this space.

The property benefits from extensive views north towards London Bridge, the Shard and City of London, whilst the courtyard can be utilised for occupier functions and collaboration with neighbouring tenants.

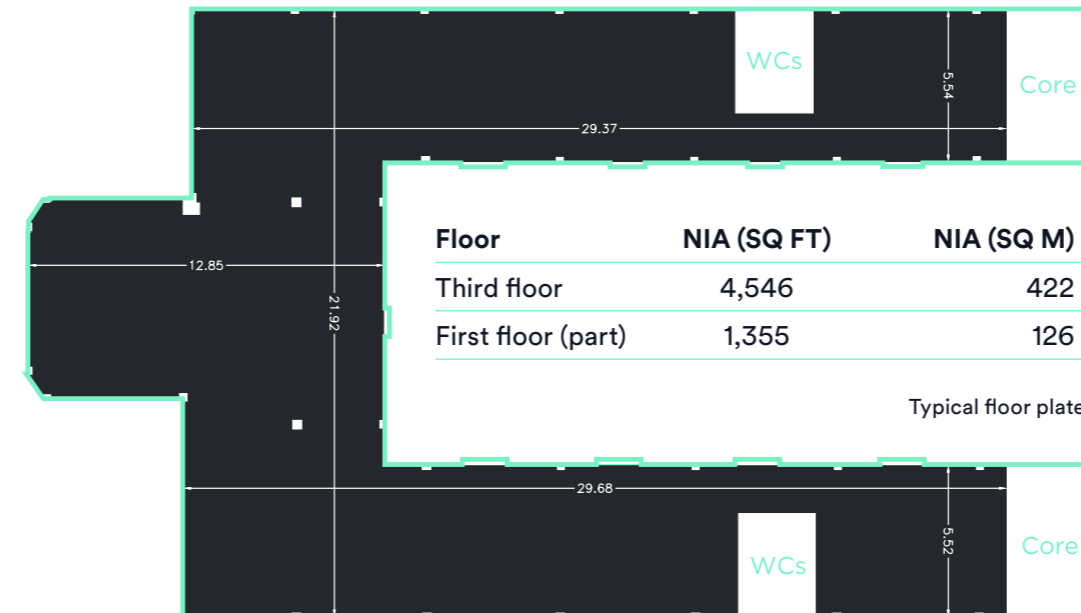

- Excellent natural light
- Attractive courtyard
- Cycle storage
- Flexible lease terms
- Passenger lift servicing all floors
- Demised WCs
- Exposed ceilings
- Fan coil air conditioning system
- Perimeter trunking

Rent £47.50 psf  
 Business Rates circa. £16 psf (payable for the year 2023/24)  
 Service charge circa. £6 psf





# CONNECTIVITY

Baden Place benefits from excellent transport links across Central London and onwards to national destinations, it is also located in close proximity to London Bridge station (northern, jubilee and national rail lines) and Borough station (northern line).

London Bridge station has benefited from an extensive £1 billion redevelopment and upgrade of the station. This has included two new entrances; a larger ground floor concourse, providing an additional 92,000 sq ft of retail space and step free access to every platform - all of which have been widened and lengthened to accommodate Thameslink trains. Owing to these works, potential capacity has been increased by 65% to 90 million passengers a year.

Additionally the River Thames Clipper boat service runs from Bankside Pier and connects west to Westminster in 17 minutes and east to Canary Wharf in 10 minutes.

Stations (London Bridge)	Time
Bank	1 Minute
Waterloo	3 Minutes
Canary Wharf	8 Minutes
Green Park	8 Minutes
Bond Street	9 Minutes
Liverpool Street	10 Minutes
Euston	15 Minutes
King's Cross & St Pancras Int.	17 Minutes

Airports (London Bridge)	Time
City Airport	19 Minutes
Gatwick	28 Minutes
Heathrow	35 Minutes
Stansted	60 Minutes

For further information or to arrange an inspection please contact the letting agents, Gerald Eve.



**Chris Wright**  
07884 865 261  
cwright@geraldeve.com

**Viviana Thurstan**  
07385 409 535  
vthurstan@geraldeve.com

**Amy Bryant**  
07551 172 931  
abryant@geraldeve.com



**Ben Locke**  
020 7234 9639  
benlocke@fieldandsons.co.uk

**Nigel Gouldsmith**  
020 7234 9639  
nigelgouldsmith@fieldandsons.co.uk

Conditions under which these particulars are issued: Gerald Eve LLP is obliged by law to carry out customer due diligence procedures in connection with property transactions. Any prospective purchaser or lessee may be requested to provide information in connection with Gerald Eve LLP's obligations under the Money Laundering, Terrorist Financing and Transfer of Funds (Information on the Payer) Regulations 2017, including as regards - verifying the identity of the Purchaser or Lessee and its beneficial owners, identifying the source of wealth for the transaction, understanding the purpose of the transaction, and, assessing the level of risk that the transaction poses. All details in these particulars are given in good faith, but Gerald Eve LLP for themselves and the Vendors/Lessors of this property for whom they act give notice that: 1. These particulars do not and shall not constitute, in whole or in part, an offer or a contract or part thereof, and Gerald Eve LLP have no authority to make or enter into any such offer or contract. 2. All statements contained in these particulars are made without acceptance any liability in negligence or otherwise by Gerald Eve LLP, for themselves or for the Vendors/Lessors. 3. None of the statements contained in these particulars is to be relied on as a statement or representation of fact or warranty on any matter whatsoever, and intending purchasers must satisfy themselves by whatever means as to the correctness of any statements made within these particulars. 4. The Vendors/Lessors do not make, give or imply, nor do Gerald Eve LLP or any person in their employment have any authority to make, give or imply, whether in these particulars or otherwise, any representation or warranty whatsoever in relation to the property. Misrepresentation Act 1967: Gerald Eve LLP for themselves and for the Vendor(s) or Lessor(s) of this property whose agents they are, give notice that: these particulars do not constitute, nor constitute any part of an offer or contract. The statement does not affect any potential liability under the Consumer Protection from Unfair Trading Regulations 2008 (CPRs) and Business Protection from Misleading Market Regulations 2008 (BPMRs). Particulars issued May 2024. Gerald Eve LLP is a Limited Liability Partnership registered in England and Wales with registered number OC339470 and its registered office at One Fitzroy, 6 Mortimer Street, London, W1T 3JJ. Designed by CORMACK - cormackadvertising.com