



Geoffrey Close

Offers In Region Of £375,000

edwards & gray

Geoffrey Close

Edwards and Gray are delighted to present this fantastic 3-bedroom link detached property, located on a quiet neighbourhood in Walmley, Sutton Coldfield. This property is perfect for both first time buyers and families and benefits from two reception rooms, three bedrooms, a kitchen, a downstairs w.c, a garage and utility room, a garden, and a driveway.







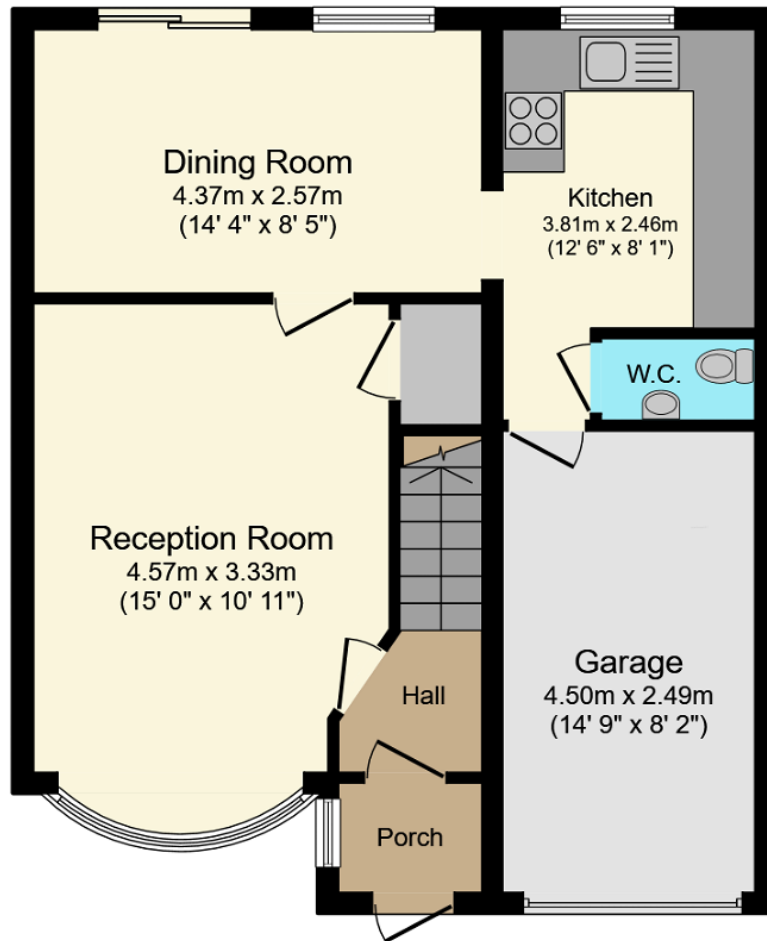

Ground Floor

Floor area 56.7 m² (611 sq.ft.)

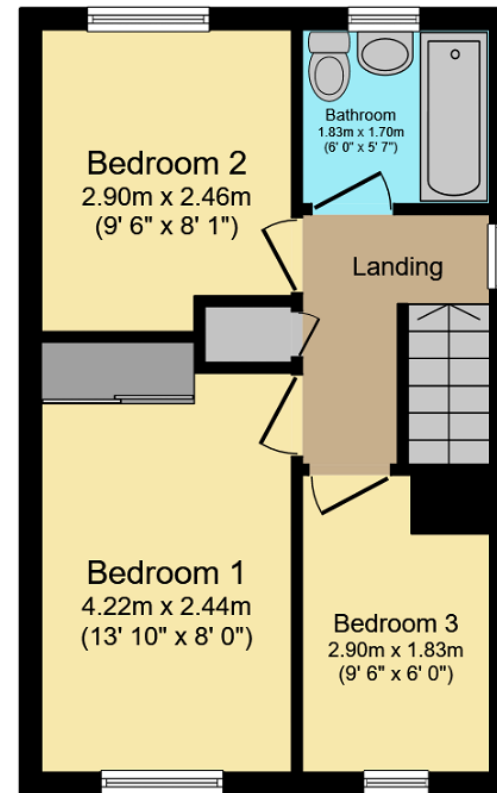

First Floor

Floor area 31.6 m² (340 sq.ft.)

TOTAL: 88.4 m² (951 sq.ft.)

This floor plan is for illustrative purposes only. It is not drawn to scale. Any measurements, floor areas (including any total floor area), openings and orientations are approximate. No details are guaranteed, they cannot be relied upon for any purpose and do not form any part of any agreement. No liability is taken for any error, omission or misstatement. A party must rely upon its own inspection(s). Powered by www.Propertybox.io