



Watkins Court, Old Mill Close,  
Hereford HR4 0AQ  
£795 Per Calendar Month

TO LET



PROPERTY SUMMARY

**\*\* OVER 60's ONLY \*\*** A well presented purpose built 2nd floor retirement apartment situated in Watkins Court which is an exclusive development enjoying a community atmosphere in a convenient location to the west of the city centre. The property comprises entrance hall, bathroom with a shower over the bath, living room with double glazed doors leading to a Juliet balcony facing West., kitchen with electric oven, double bedroom with fitted wardrobe, electric heating throughout, double glazing and communal gardens and car park. The development consists of 53 retirement properties and benefits from a residents' lounge, camera entry system with a controlled entry door and further features include a house manager, guest suite and laundry room. There is lift access to each floor together with two staircases.

**THE GROUND FLOOR:**  
A controlled entrance lobby gives access to the House Manager's Office, communal lounge, laundry, guest suite, communal kitchen area and leads to the corridors, stairs and lifts that serve the apartments.

RENT INCLUDES ELECTRIC HEATING AND WATER

NOTES & COMMENTS

DIRECTIONS

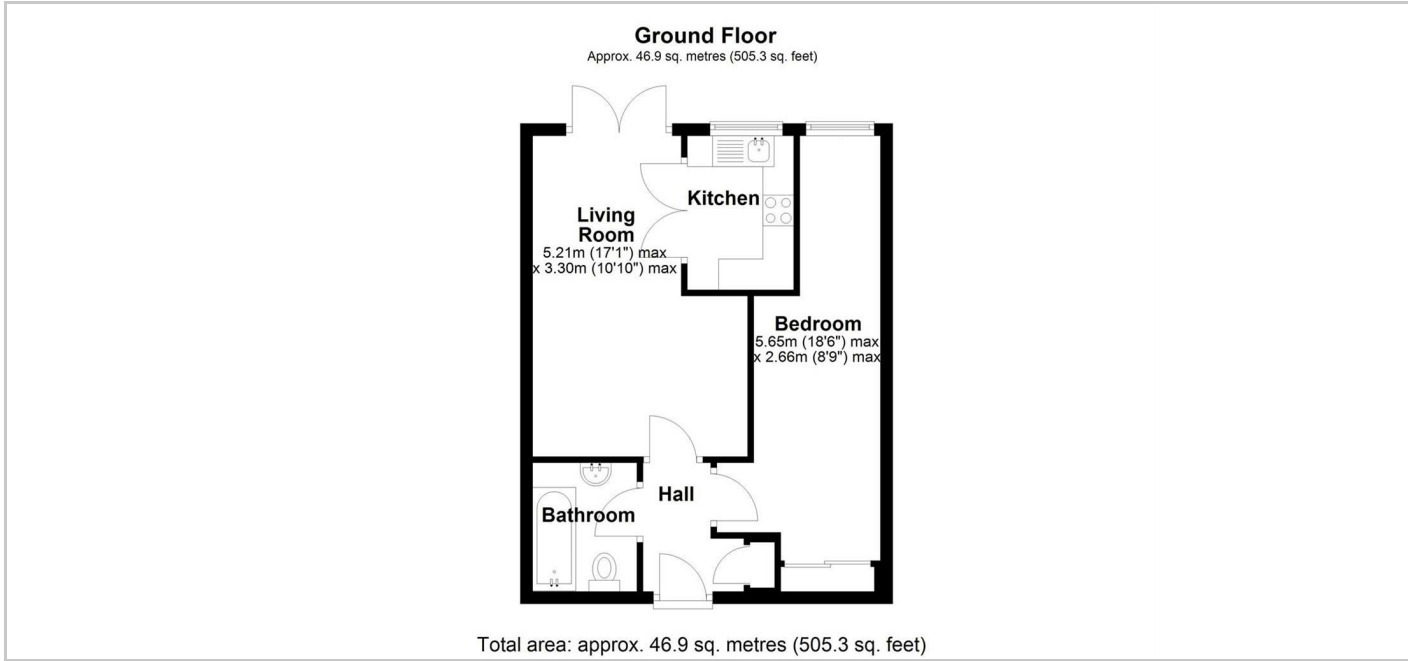

FEES

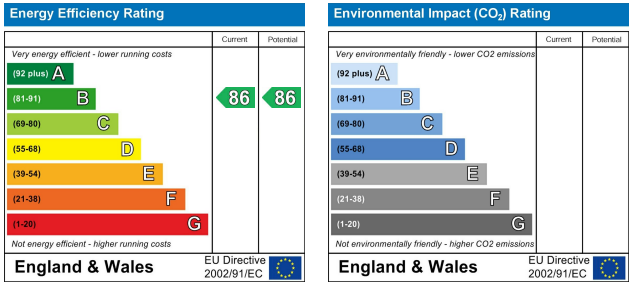

Brookes Bliss

These particulars are offered on the understanding that all negotiations are conducted through this company. Neither these particulars, nor oral representations, form part of any offer or contract, and their accuracy cannot be guaranteed.

46 Bridge Street, Hereford, Herefordshire HR4 9DG  
Tel: 01432 343800  
Lettings@brookes.bliss.co.uk

brookesbliss.co.uk

