



Longmeadow, Vowchurch Common,  
Vowchurch HR2 0RL  
£1,600 Per Calendar Month

TO LET





PROPERTY SUMMARY

\*Must be viewed\* A beautifully renovated 3/4 bedroom country property occupying an elevated position with extensive views. Lovingly restored and extended, the property comprises a large open plan kitchen/diner with a luxury bespoke kitchen, range cooker, integrated dishwasher and windows and french doors offering extensive south west views across the black mountains and Golden Valley, utility area, cloakroom, walk in pantry, seating area, lounge/snug, bedroom three, bedroom four/office and to the first floor is the second bedroom, family bathroom and en-suite master bedroom with fitted cupboards. Fully double glazed and oil central heating (underfloor heating downstairs). Outside there is a large patio area, extensive garden, small wood, parking area, garage and small field/paddock.

NOTES & COMMENTS

DIRECTIONS

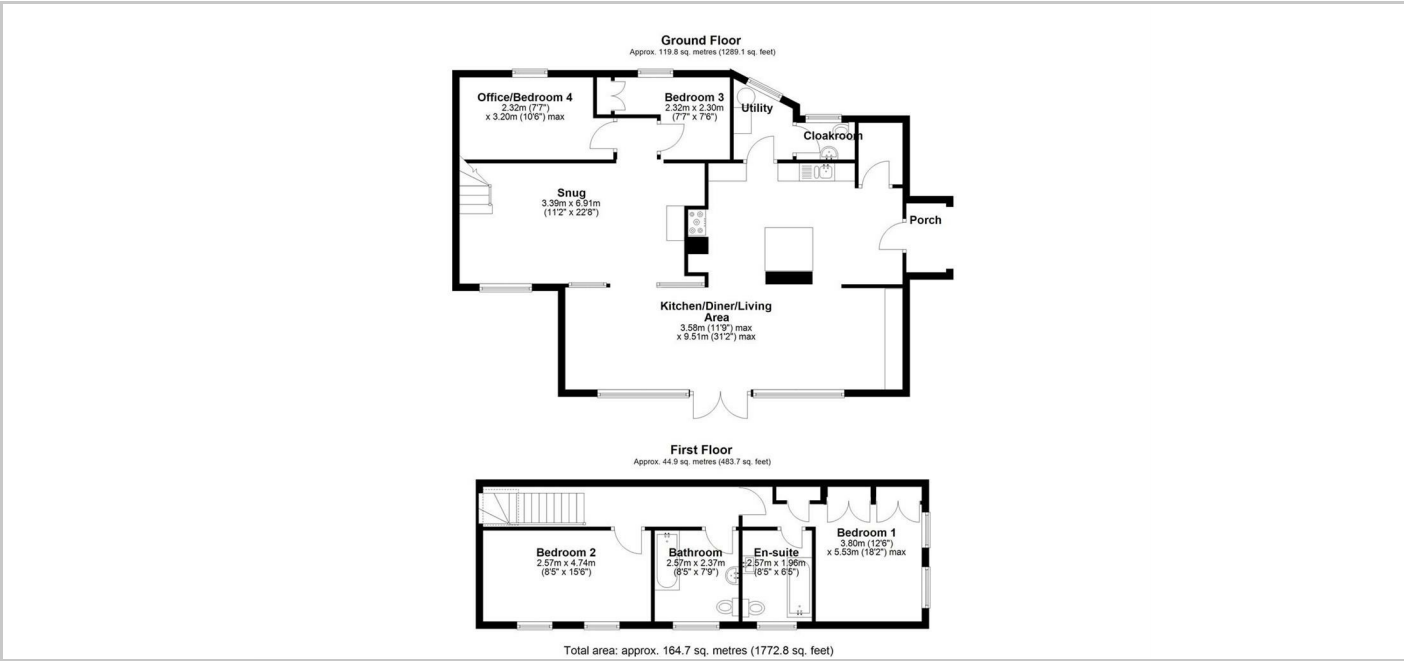

FEES

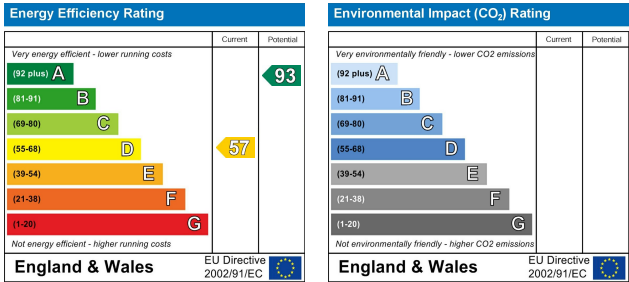

Brookes Bliss

These particulars are offered on the understanding that all negotiations are conducted through this company. Neither these particulars, nor oral representations, form part of any offer or contract, and their accuracy cannot be guaranteed.

46 Bridge Street, Hereford, Herefordshire HR4 9DG  
Tel: 01432 343800  
Lettings@brookes.bliss.co.uk

brookesbliss.co.uk

