

HUNTERS®

HERE TO GET *you* THERE



HUNTERS®

SALES & LETTINGS



Neville Close

South Kirkby, Pontefract, WF9 3RU

£695 Per Month

2 1 1 C

Council Tax: A

Floor Plan

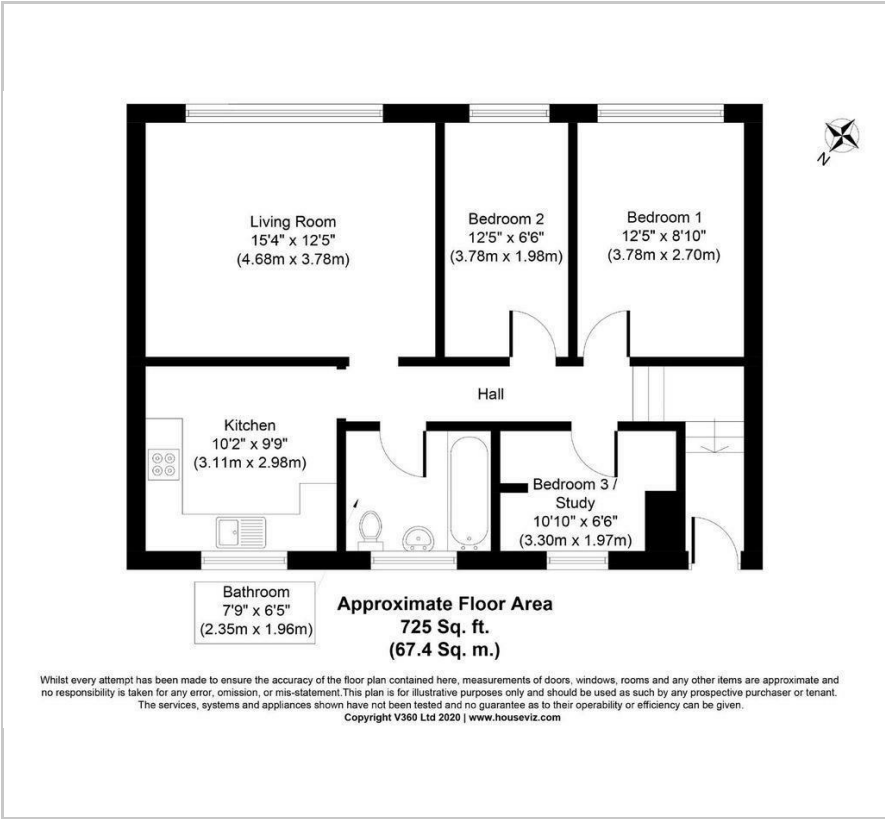

Area Map



Energy Efficiency Graph

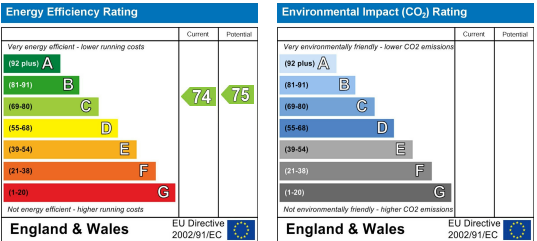

Viewing

Please contact our Hunters Castleford Lettings Office on 01977604600 if you wish to arrange a viewing appointment for this property or require further information.

- GOOD LOCAGTION
- MODERN THROUGHOUT
- OUTBUILDING STORAGE
- EPC: C
- DEPOSIT: £801 or FLATFAIR
- IDEAL LONG TERM LET
- EFFICIENT TO RUN
- 1st FLOOR
- COUNCIL TAX BAND: A



IDEAL LONG TERM LET - MODERN THROUGHOUT - WALK IN WARDROBE - 2 BEDROOMS - BATH WITH SHOWER - OUTBUILDING STORAGE - EFFICIENT TO RUN - FLATFAIR DEPOSIT OPTION

Viewings strongly advised to appreciate the high standard of the apartment!

Hunters are proud to offer this 2 bedroom apartment situated in South Kirkby.

The property comprises of its own private entrance with an outbuilding to the side for external storage. Leading up the stairs onto the hallway, there is a large 'walk in wardrobe' offering plenty of storage space. Opposite is bedroom 1 which is a double bedroom. Bedroom 2 to the side of this. Then a 3 piece modern family suite bathroom. Open plan kitchen diner to the end of the hall with lots of storage space, large window offering more than enough day light. Then a large living room with a nice view to the street surrounded by trees and grass areas.

The property is unfurnished or part furnished.

Please call our lettings team today to arrange a viewing!

These particulars are intended to give a fair and reliable description of the property but no responsibility for any inaccuracy or error can be accepted and do not constitute an offer or contract. We have not tested any services or appliances (including central heating if fitted) referred to in these particulars and the purchasers are advised to satisfy themselves as to the working order and condition. If a property is unoccupied at any time there may be reconnection charges for any switched off/disconnected or drained services or appliances - All measurements are approximate. **THINKING OF SELLING?** If you are thinking of selling your home or just curious to discover the value of your property, Hunters would be pleased to provide free, no obligation sales and marketing advice. Even if your home is outside the area covered by our local offices we can arrange a Market Appraisal through our national network of Hunters estate agents.

6 Bank Street, Castleford, WF10 1HZ
Tel: 01977604600 Email: castlefordlettings@hunters.com <https://www.hunters.com>

MATERIAL INFORMATION

- Tenure:
- Lease Years Remaining:
- Annual Ground Rent:
- Review Period:
- Review Increase:
- Service Charge:
- Shared Ownership:
- Ownership Share: