

**Livv**  
homes

Two bedroom home

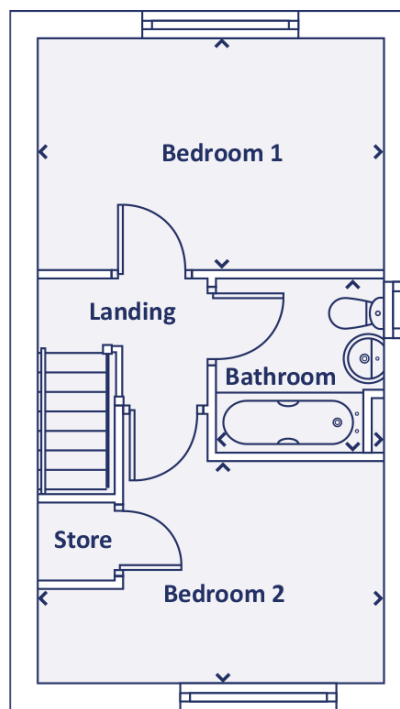

**The Haxby**  
at Canterbury Park

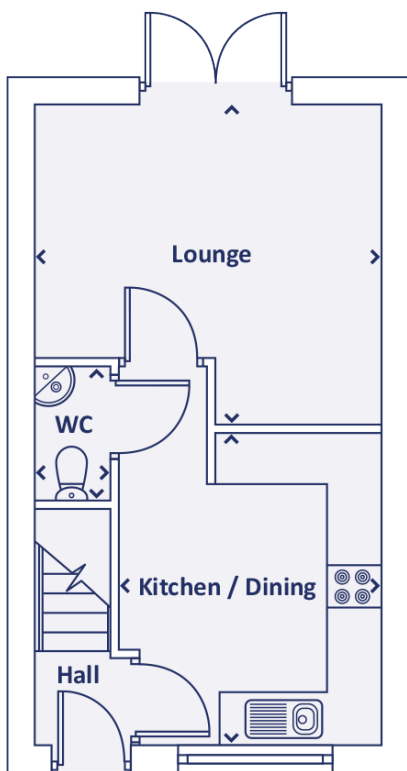

## Ground floor

Kitchen / Dining room	3.63m x 3.03m   11'9" x 9'9"
Living room	3.72m x 3.99m   12'2" x 13'1"
WC	1.56m x 0.86m   5'1" x 2'8"

## First floor

Master Bedroom	3.99m x 2.67m   13'1" x 8'8"
Bedroom 2	3.99m x 2.56m   13'1" x 8'4"
Bathroom	2.02m x 1.94m   6'6" x 6'4"

 0151 290 7891

 [info@livvhomes.com](mailto:info@livvhomes.com)

 [livvhomes.com](http://livvhomes.com)



Computer generated images and floor plans are for illustrative purposes only. They depict a typical layout and style of the individual plot, and do not constitute a contract, part of a contract or warranty. Features and finishes vary from plot to plot. For exact plot specifications please contact our sales team. All dimensions are approximate and you should undertake your own measurements before ordering any flooring, fixtures, fittings or furniture.

