

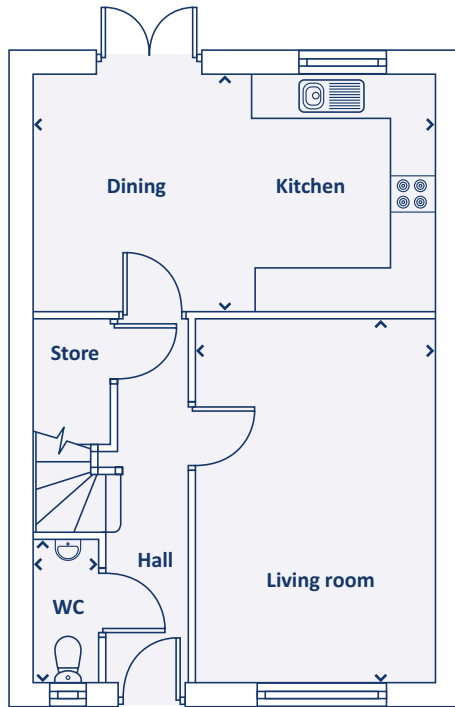

Four bedroom home



The Clifton
at Canterbury Park



Ground floor

Kitchen / Dining room	5.55m x 3.29m 18'2" x 10'8"
Living room	5.07m x 3.33m 16'6" x 10'9"
W.C.	2.91m x 0.91m 6'6" x 3'0"

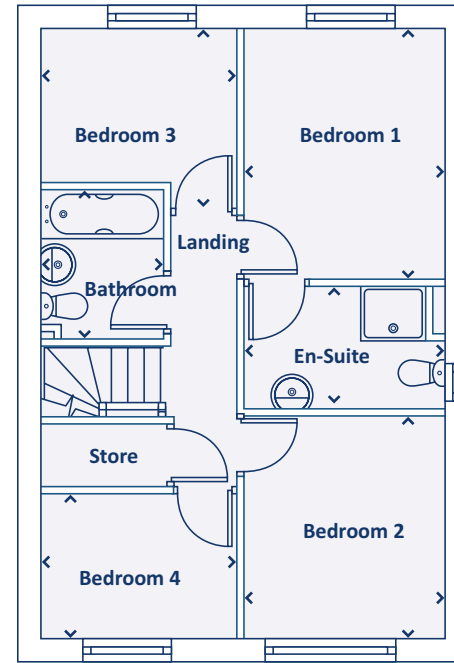

First floor

Bedroom 1	3.47m x 2.76m 11'4" x 9'1"
Bedroom 2	3.15m x 2.76m 10'3" x 9'1"
Bedroom 3	2.71m x 2.49m 8'9" x 8'2"
Bedroom 4	2.71m x 2.01m 9'9" x 6'6"
Bathroom	2.09m x 1.70m 6'9" x 5'6"
En-suite	2.76m x 1.64m 9'1" x 5'4"

 0151 290 7891

 info@livvhomes.com

 livvhomes.com



Computer generated images and floor plans are for illustrative purposes only. They depict a typical layout and style of the individual plot, and do not constitute a contract, part of a contract or warranty. Features and finishes vary from plot to plot. For exact plot specifications please contact our sales team. All dimensions are approximate and you should undertake your own measurements before ordering any flooring, fixtures, fittings or furniture.

