



01947 601301

5 MOORLAND CLOSE, WHITBY

4 BED TOWN HOUSE



WWW.HOPEANDBRAIMESTATEAGENTS.CO.UK



PROPERTY FEATURES

- Stunning Townhouse in a Prime Coastal Location
- Newly Refurbished to an Exceptional Standard
- Open Plan Living with Contemporary Interiors
- Bespoke Kitchen with Breakfast Bar & Integrated Appliances
- Living Room with Patio Doors onto an Outdoor Terrace
- 4 Bedrooms & 4 Luxurious Bathrooms
- Underfloor Heating & Double-Glazing Throughout
- Roof Top Terrace with Panoramic Sea Views

Type: **TOWN HOUSE**

Availability: **FOR SALE**

Bedrooms: **4**

Bathrooms: **4**

Reception Rooms: **1**

Parking: **ALLOCATED PARKING**

Outside Space: **TERRACE**

Tenure: **FREEHOLD**

01947 601301

www.hopeandbraimstateagents.co.uk



5 MOORLAND CLOSE, WHITBY- 4 bed Town House -£795,000



Hope & Braim are delighted to present Number 5 Moorland Close—a residence of exceptional distinction occupying one of the most enviable positions on Whitby's Promenade. Moorland Close stands as a defining landmark along this celebrated coastline. Conceived by Mulgrave Estates and completed in 2013 on the site of the former Moorland Hotel, these eight striking townhouses pioneered the renaissance of luxury living on the Westcliff. Here is architecture that commands attention, married to sea views of breathtaking scope. Newly renovated to an exacting standard, Number 5 presents interiors of contemporary sophistication. The open-plan living space flows with effortless grace, where a bespoke kitchen—complete with breakfast bar and integrated appliances—anchors a light-filled environment designed for modern life. Patio doors dissolve the boundary between inside and out, opening onto a private terrace where land meets sea in spectacular fashion. Four generously proportioned bedrooms, each accompanied by its own luxurious bathroom, offer accommodation of genuine substance. These are spaces that understand comfort, privacy, and the art of refined living. Underfloor heating provides whisper-quiet warmth throughout, whilst double-glazing ensures year-round comfort. Yet it is the rooftop terrace that truly distinguishes this property—a private eyrie commanding panoramic sea views that stretch across the bay to the horizon at the front, whilst to the rear is Whitby's Cricket Field. Here, the drama of Whitby's coastline unfolds in ever-changing light. Whether sought as a permanent residence of considerable stature or a coastal retreat of the highest order, Number 5 Moorland Close represents an opportunity seldom encountered. This is property that transcends the ordinary and is in show home condition with all items being brand new and unused, due to a change of circumstances of the current owners. Private parking completes the picture.



5 MOORLAND CLOSE, WHITBY- 4 bed Town House -£795,000



Floor 0

Floor 1

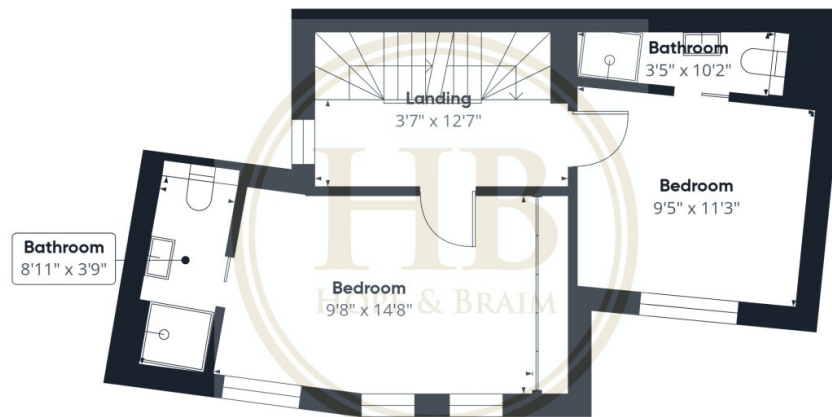

Floor 2

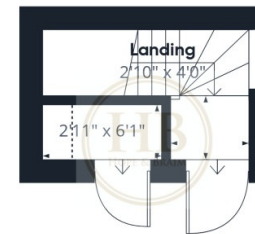

Floor 3



Approximate total area⁽¹⁾

1214 ft²

Reduced headroom

4 ft²

(1) Excluding balconies and terraces

Reduced headroom

..... Below 5 ft

Calculations reference the RICS IPMS 3C standard. Measurements are approximate and not to scale. This floor plan is intended for illustration only.

GIRAFFE360

Disclaimer: This brochure and property details are a representation of the property offered for sale or rent, as a guide only.

Brochure content must not be relied upon as fact and does not form any part of a contract. Measurements are approximate.

No fixtures or fittings, heating system or appliances have been tested, nor are they warranted by Hope & Braim or any staff member in any way as being functional or regulation compliant.

Hope & Braim do not accept any liability for any loss that may be caused directly or indirectly by the brochure content, all interested parties must rely on their own, their surveyor's or solicitor's findings.

We advise all interested parties to check with the local planning office for details of any application or decisions that may be consequential to your decision to purchase or rent any property.

Any floor plans provided should be used for illustrative purposes only and should be used as such by any interested party.

