



01947 601301



47 HIGHFIELD
ROAD, WHITBY
3 BED END OF TERRACE HOUSE



WWW.HOPEANDBRAIMESTATEAGENTS.CO.UK



PROPERTY FEATURES

- Modern End of Terrace House with Parking
- Open Plan Kitchen/Lounge/Diner with Patio Doors to the Garden
- Fully Fitted Kitchen with Integrated Appliances
- 3 Double Bedrooms & House Bathroom
- Gas Central Heating & Double-Glazing Throughout
- South Facing Garden With Stone-Flagged Patio Area
- Spacious Driveway For 3 Vehicles

Type: **END OF TERRACE HOUSE**

Availability: **FOR SALE**

Bedrooms: **3**

Bathrooms: **1**

Reception Rooms: **1**

Parking: **DRIVEWAY**

Outside Space: **GARDEN**

Tenure: **FREEHOLD**

01947 601301

www.hopeandbraimstateagents.co.uk



47 HIGHFIELD ROAD, WHITBY- 3 bed End of Terrace House -£279,950



Hope & Braim are delighted to present 47 Highfield Road in Whitby to the market. This modern, energy-efficient end of terrace house was built in 2019 and has stylish accommodation over three floors, whilst outside there are gardens and parking, making this home the complete package. Downstairs there is a open plan kitchen, fully fitted with cabinets and integrated appliances at the front that leads to the lounge/diner at the rear with patio doors to the garden. There is also a downstairs WC which is essential for harmonious family life. On the first floor there are two bedrooms and a family bathroom that is fully tiled and has a three-piece bathroom suite with a shower. On the upper floor is a large third bedroom with Velux windows to the front and rear, and eaves storage areas. There is also an additional storage cupboard in the bedroom. The property also benefits from having plenty of storage throughout. Outside, there is a south-facing garden with stone-flagged patio, ideal for outdoor entertaining. To the front of the house is the private driveway that can accommodate two cars comfortably. This has been a much-loved first home with the owners now ready for their next move, so comes as a turnkey property ideal for those seeking a modern home in a quiet residential cul-de-sac, close to the coast.



47 HIGHFIELD ROAD, WHITBY- 3 bed End of Terrace House -£279,950

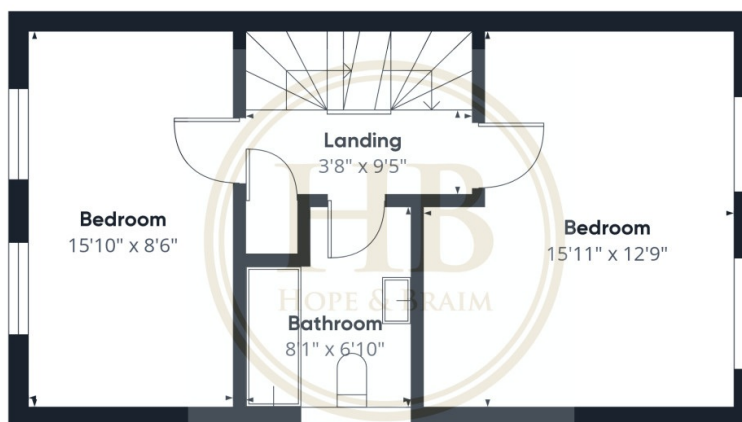
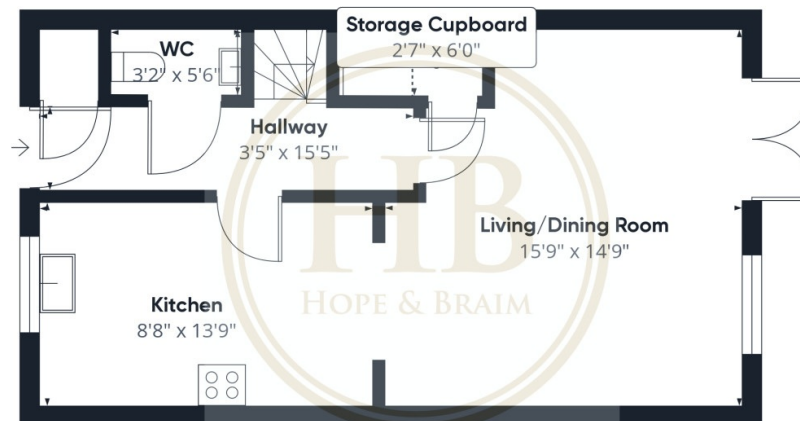

Approximate total area⁽¹⁾
1061 ft²

Reduced headroom
7.68 ft²

(1) Excluding balconies and terraces

Reduced headroom
..... Below 5 ft

While every attempt has been made to ensure accuracy, all measurements are approximate, not to scale. This floor plan is for illustrative purposes only.

Calculations are based on RICS IPMS 3C standard.

GIRAFFE360

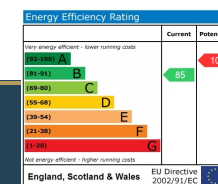

Disclaimer: This brochure and property details are a representation of the property offered for sale or rent, as a guide only. Brochure content must not be relied upon as fact and does not form any part of a contract. Measurements are approximate. No fixtures or fittings, heating system or appliances have been tested, nor are they warranted by Hope & Braim or any staff member in any way as being functional or regulation compliant. Hope & Braim do not accept any liability for any loss that may be caused directly or indirectly by the brochure content, all interested parties must rely on their own, their surveyor's or solicitor's findings. We advise all interested parties to check with the local planning office for details of any application or decisions that may be consequential to your decision to purchase or rent any property. Any floor plans provided should be used for illustrative purposes only and should be used as such by any interested party.

