



01947 601301



## RIDGEWOOD, SANDSEND

4 BED END OF TERRACE HOUSE



[WWW.HOPEANDBRAIMESTATEAGENTS.CO.UK](http://WWW.HOPEANDBRAIMESTATEAGENTS.CO.UK)



## PROPERTY FEATURES

- End of Terrace House close to the Coast
- Victorian Period with High Ceilings & Fireplaces
- 2 Reception Rooms & South-Facing Conservatory
- Breakfast Kitchen, Utility & Downstairs WC
- 4 Bedrooms, 2 Bathrooms & Separate WC
- Gas Central Heating & Double-Glazing Throughout
- Lawned Garden & South Facing Terrace
- Garage/Workshop & Gated Driveway

Type: **END OF TERRACE HOUSE**  
Availability: **FOR SALE**  
Bedrooms: **4**  
Bathrooms: **2**  
Reception Rooms: **2**  
Parking: **DRIVEWAY, GARAGE**  
Outside Space: **GARDEN, SOUTH FACING GARDEN**  
Tenure: **FREEHOLD**

01947 601301

[www.hopeandbraimstateagents.co.uk](http://www.hopeandbraimstateagents.co.uk)



RIDGEWOOD, SANDSEND - 4 bed End of Terrace House - £775,000



Hope & Braim are delighted to present Ridgewood in Sandsend to the market. This Victorian end of terrace house is just yards away from the beach and close to village amenities including a pub and fish restaurant. The property has been extended to the rear with a conservatory and has accommodation over three floors with a loft conversion and the benefit of gas central heating and double-glazing throughout. There is a spacious entrance hall with doors off to the two reception rooms and a breakfast kitchen with a staircase up to the bedrooms. The front room is currently a dining room and has a fireplace and a large bay window that floods the room with natural light and gives a glimpse of the sea between the homes on the front. The back room has a more modern look and is the lounge with double doors that open into the conservatory. The kitchen has an AGA cooker and space for a small table with seating. Adjoining the kitchen is a utility and a downstairs WC. Upstairs there are three bedrooms comprising two doubles and a single, plus there are two bathrooms and a separate WC. Stairs lead up to the loft conversion which is used as a fourth bedroom and has a Velux window. Outside there is a lawned garden to the front whilst to the rear there is a south-facing terrace that has been landscaped with a water-feature, plus there is an outbuilding, a gated driveway, and a garage/workshop.



RIDGEWOOD, SANDSEND - 4 bed End of Terrace House - £775,000

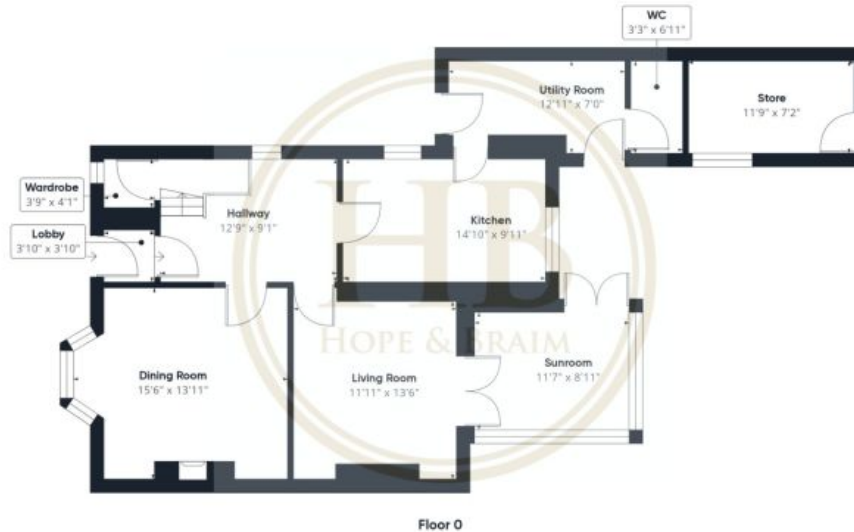

Floor 0



Floor 2

Floor 1



Approximate total area<sup>(1)</sup>  
1730.77 ft<sup>2</sup>

Reduced headroom  
74.07 ft<sup>2</sup>

(1) Excluding balconies and terraces

☐ Reduced headroom:  
(below 1.5m/4.92ft)

While every attempt has been made to ensure accuracy, all measurements are approximate, not to scale. This floor plan is for illustrative purposes only.

GIRAFFE360



Disclaimer: This brochure and property details are a representation of the property offered for sale or rent, as a guide only. Brochure content must not be relied upon as fact and does not form any part of a contract. Measurements are approximate. No fixtures or fittings, heating system or appliances have been tested, nor are they warranted by Hope & Braim or any staff member in any way as being functional or regulation compliant. Hope & Braim do not accept any liability for any loss that may be caused directly or indirectly by the brochure content, all interested parties must rely on their own, their surveyor's or solicitor's findings. We advise all interested parties to check with the local planning office for details of any application or decisions that may be consequential to your decision to purchase or rent any property. Any floor plans provided should be used for illustrative purposes only and should be used as such by any interested party.