



01947 601301



4 OYSTONS YARD, WHITBY

2 BED COTTAGE



WWW.HOPEANDBRAIMESTATEAGENTS.CO.UK



PROPERTY FEATURES

- Period Cottage tucked away in an Historic Yard
- Beamed Ceilings and Original Panelling
- Open Plan Lounge/Kitchen with Integrated Appliances
- 2 Double Bedrooms & House Bathroom
- Traditional Timber Double-Glazing & Electric Heating
- Open Outlook with Views across to the Abbey Headland

Type: COTTAGE
Availability: FOR SALE
Bedrooms: 2
Bathrooms: 1
Reception Rooms: 1
Tenure: FREEHOLD

01947 601301

www.hopeandbraimestateagents.co.uk



4 OYSTONS YARD, WHITBY - 2 bed Cottage - £250,000



Hope & Braim are delighted to present 4 Oystons Yard off Flowergate in Whitby to the market. Tucked away in an historic yard off Flowergate is this charming cottage that enjoys an open aspect with views across to Whitby's Abbey. This period property has a wealth of features including beamed ceilings, original paneling and a corkscrew staircase that blend with more modern features such as hard wood double-glazing and electric heating. There are three floors of accommodation with an open plan reception room downstairs that has a fitted kitchen with integrated appliances on the back wall, a beamed ceiling and a fireplace which could potentially be recommissioned to create a cosy open fire. The corkscrew staircase takes you up to the first floor where there is a double bedroom that has two built in wardrobes either side of the chimney breast and a modern bathroom with a three-piece bathroom suite and houses the electric water heater. Within the roof space there is a second double bedroom that has a vaulted ceiling with two Velux windows and a dormer window that looks out onto the rooftops of the Old Town and across to Whitby's Abbey. The cottage was formerly a holiday let known as the "Captains Rest" but is currently a private holiday home that will come fully furnished.



4 OYSTONS YARD, WHITBY - 2 bed Cottage - £250,000

GROUND FLOOR
239 sq.ft. (22.2 sq.m.) approx.



1ST FLOOR
241 sq.ft. (22.4 sq.m.) approx.

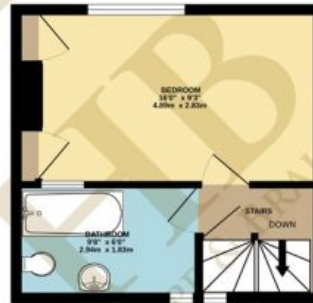

2ND FLOOR
181 sq.ft. (16.8 sq.m.) approx.



TOTAL FLOOR AREA: 661 sq.ft. (61.4 sq.m.) approx.

Whilst every attempt has been made to ensure the accuracy of the floorplan contained here, measurements of doors, windows, rooms and any other items are approximate and no responsibility is taken for any error, omission or mis-statement. This plan is for illustrative purposes only and should be used as such by any prospective purchaser. The services, systems and appliances shown have not been tested and no guarantee as to their operability or efficiency can be given.
Made with Metropix ©2023



Disclaimer: This brochure and property details are a representation of the property offered for sale or rent, as a guide only.

Brochure content must not be relied upon as fact and does not form any part of a contract. Measurements are approximate.

No fixtures or fittings, heating system or appliances have been tested, nor are they warranted by Hope & Braim or any staff member in any way as being functional or regulation compliant.

Hope & Braim do not accept any liability for any loss that may be caused directly or indirectly by the brochure content, all interested parties must rely on their own, their surveyor's or solicitor's findings.

We advise all interested parties to check with the local planning office for details of any application or decisions that may be consequential to your decision to purchase or rent any property.

Any floor plans provided should be used for illustrative purposes only and should be used as such by any interested party.