

5 St. Clements Terrace,

Offers In Region Of £300,000

🛏 2 🚿 1 🛋 1



- Impeccably presented Two well-appointed bedroomed character cottage with stunning Cathedral and city views
- Open-plan kitchen and dining area
- Beautiful character period features throughout
- Landscaped, south-facing garden with sun terrace and leisure area
- Cosy sitting room with woodburner
- Private off-road parking
- Stylish, modern family shower room
- NO ONWARD CHAIN
- Rear courtyard - with electrics
- Incredible cathedral and cityscape views

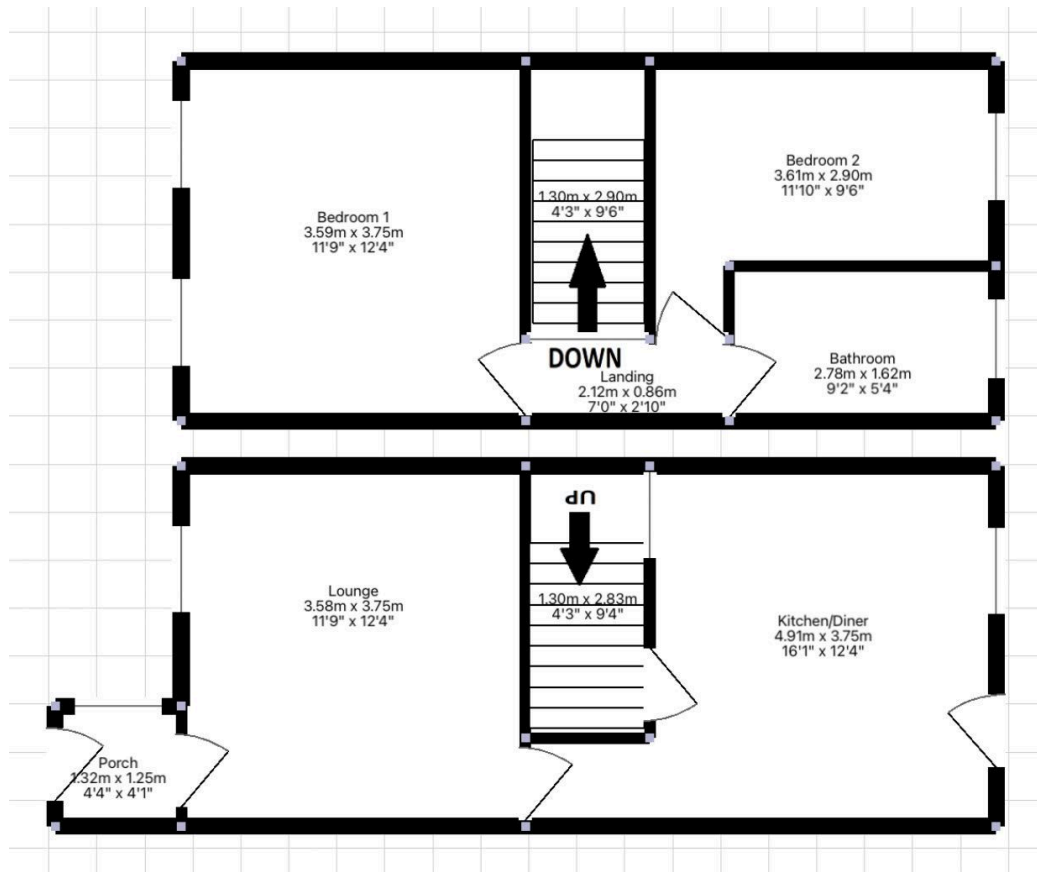

****Impeccably presented Two well-appointed bedroomed character cottage with stunning Cathedral and city views** | NO ONWARD CHAIN | Cosy sitting room with wood burner | Open-plan kitchen and dining area | Stylish, modern family shower room | Beautiful character period features throughout | Mains gas central heating | Landscaped, south-facing garden with sun terrace and leisure area | Rear courtyard | Private off-road parking | Incredible cathedral and cityscape views | Just a short stroll from the city centre.**