

Tyldesley Road, Atherton, M46 9AD
£995 PCM



BALMER & CO are delighted to offer TO RENT this two bedroom apartment situated in a converted church. Accommodation comprises in brief, communal entrance with secure intercom entry system, private hallway, open plan living room, fitted kitchen with appliances. two double bedrooms and bathroom. Outside are communal gardens with allocated parking.

Floor Plan

Church Court Total Approx. Floor Area 758 Sq.ft. (70.4 Sq.M.)

Surveyed and drawn by Lens Media for illustrative purposes only. Not to scale. Whilst every attempt was made to ensure the accuracy of the floor plan, all measurements are approximate and no responsibility is taken for any error.

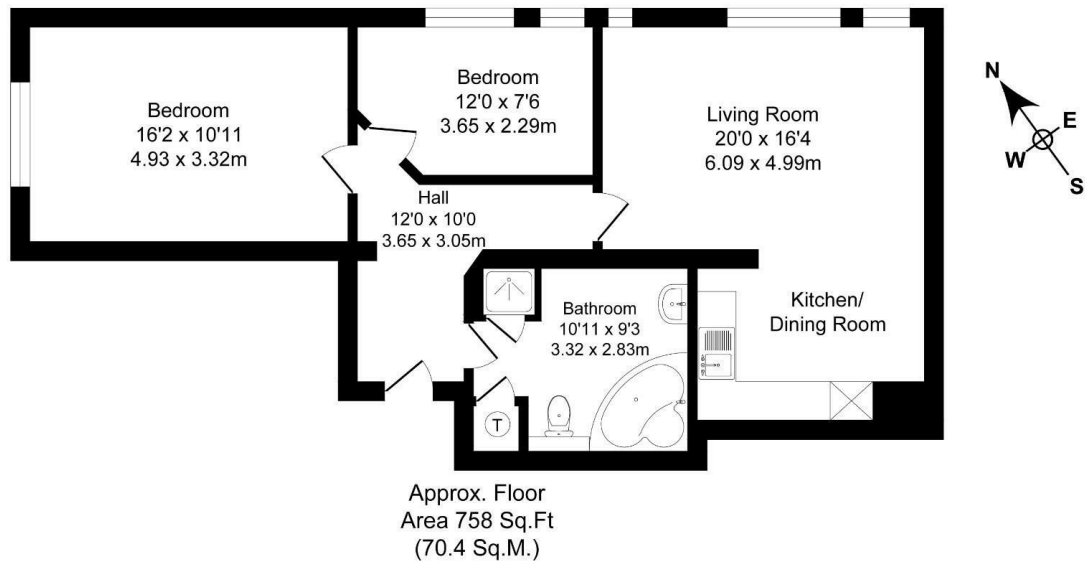

Area Map

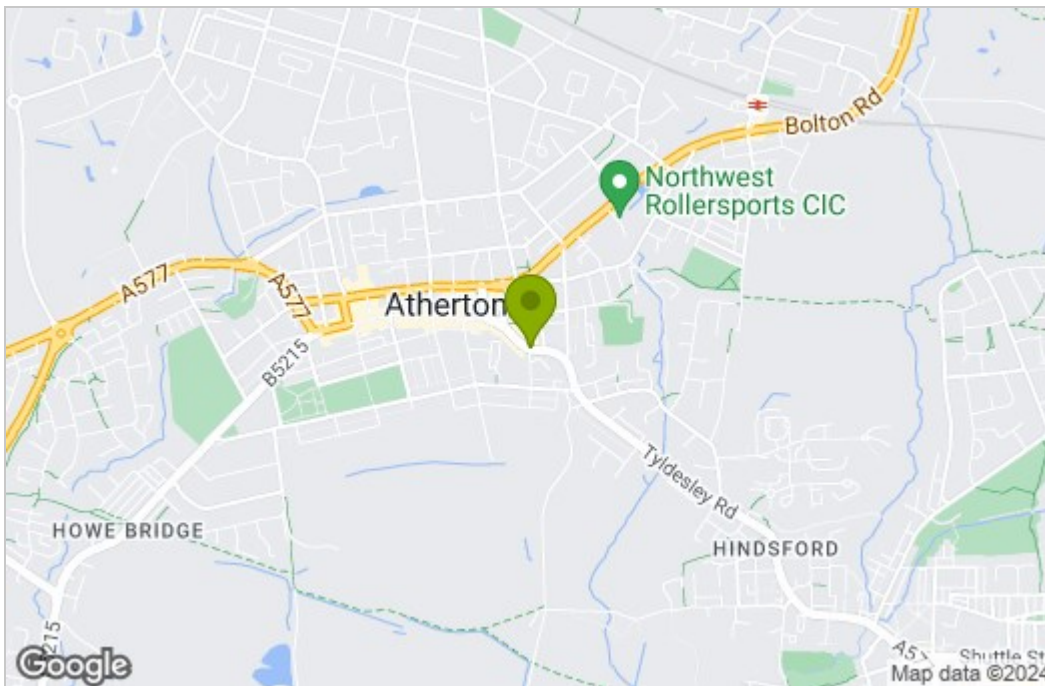

Energy Efficiency Graph

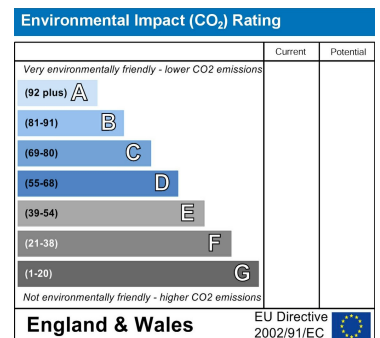
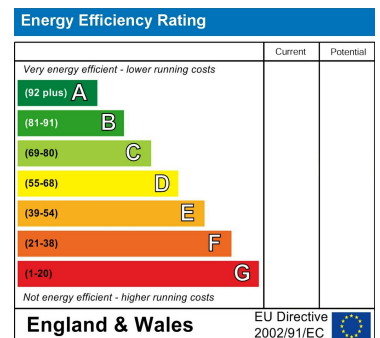

These particulars, whilst believed to be accurate are set out as a general outline only for guidance and do not constitute any part of an offer or contract. Intending purchasers should not rely on them as statements of representation of fact, but must satisfy themselves by inspection or otherwise as to their accuracy. No person in this firm's employment has the authority to make or give any representation or warranty in respect of the property.