

Priestfields, Leigh, WN7 2RG
£1,100 PCM

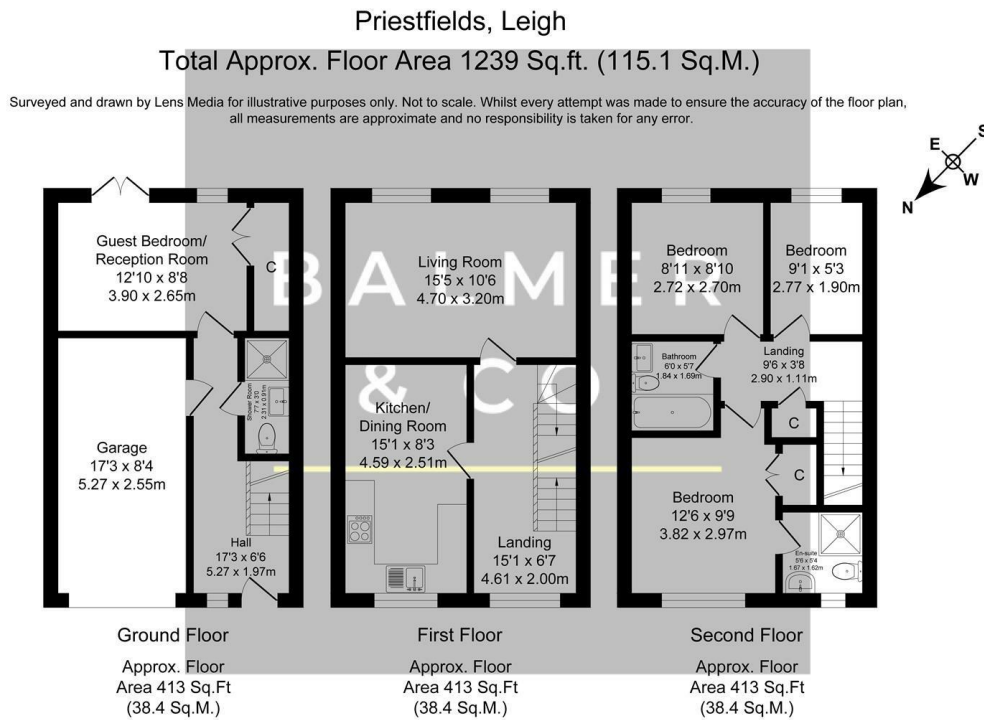

BALMER & CO are delighted to offer TO RENT this four bedroom town house. Ground floor accommodation comprises in brief, entrance hall, lounge/dining room, guest shower room and access to the integral garage. To the first floor is a good sized living room with separate modern fitted kitchen. To the second floor are three further bedrooms including master bedroom with en-sure shower room, and further family bathroom. Outside are landscaped rear gardens and driveway to front providing off road parking.

Floor Plan



Area Map

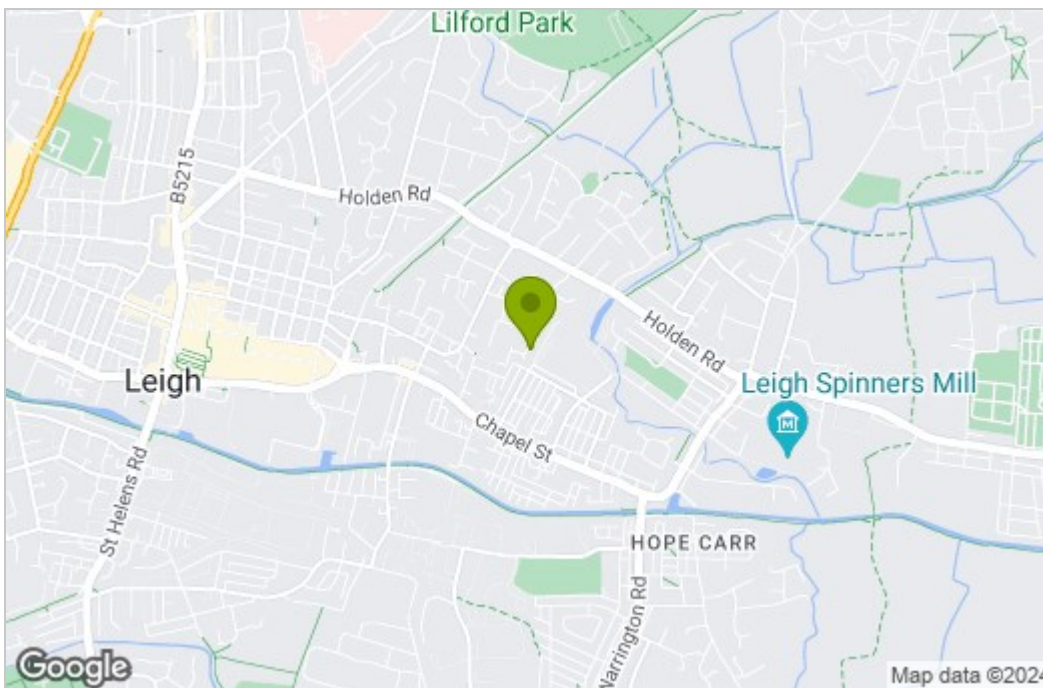

Energy Efficiency Graph

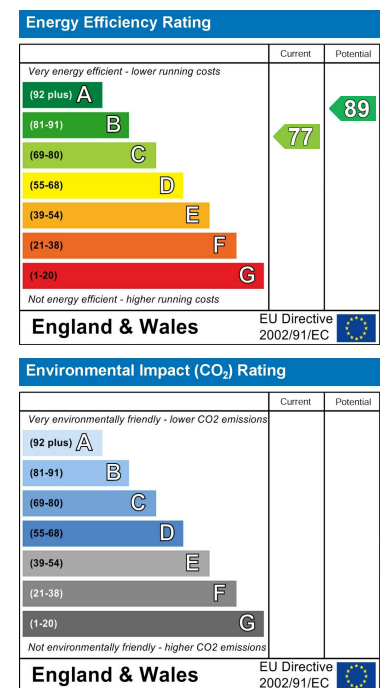

These particulars, whilst believed to be accurate are set out as a general outline only for guidance and do not constitute any part of an offer or contract. Intending purchasers should not rely on them as statements of representation of fact, but must satisfy themselves by inspection or otherwise as to their accuracy. No person in this firm's employment has the authority to make or give any representation or warranty in respect of the property.