

Bolton Road, Swinton, M27 8XB
£1,395 PCM



BALMER & CO are delighted to offer TO RENT this three bedroom semi detached property. Ground floor accommodation comprises in brief, entrance porch, good sized living room, and fitted kitchen. To the first floor are three bedrooms and bathroom. Outside are enclosed rear gardens with driveway to front providing off road parking.

Floor Plan

Bolton Road, Pendlebury Total Approx. Floor Area 750 Sq.ft. (69.7 Sq.M.)

Surveyed and drawn by Lens Media for illustrative purposes only. Not to scale. Whilst every attempt was made to ensure the accuracy of the floor plan, all measurements are approximate and no responsibility is taken for any error.

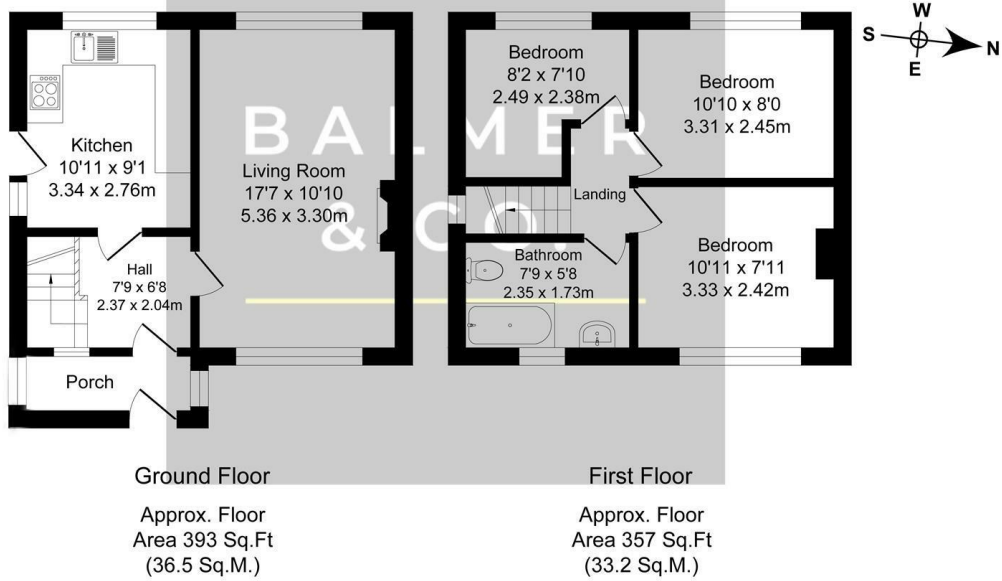

Area Map



Energy Efficiency Graph

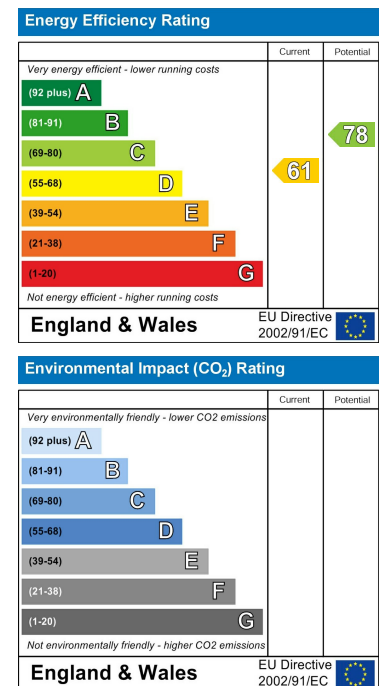

These particulars, whilst believed to be accurate are set out as a general outline only for guidance and do not constitute any part of an offer or contract. Intending purchasers should not rely on them as statements of representation of fact, but must satisfy themselves by inspection or otherwise as to their accuracy. No person in this firm's employment has the authority to make or give any representation or warranty in respect of the property.