



## 14 Mead Close, Stevenage, SG1 1QE

Guide price **£325,000**

Guide price £325,000 to £350,000

Located in Bedwell Stevenage, is this three bedroom, semi-detached property, with parking via a garage en bloc.

Step inside a welcoming entrance hall and make your way to the lounge. The lounge is bathed in natural light from a large front-facing window and offers ample space for a large sofa, perfect for hosting family and friends. Through to the kitchen/dining room featuring French doors opening out into the garden, seamlessly blending indoor and outdoor spaces. The kitchen has been finished with classic cream cabinets, wooden work surfaces, and has space for a dishwasher and fridge freezer. The dining area offers views out to the garden. Off the kitchen is an inner lobby with access to both the front and back of the house, as well as a large storage cupboard. This area offers potential for a kitchen expansion or the creation of a downstairs shower or utility room. Off the entrance hall is a W/C.



## Floor Plan

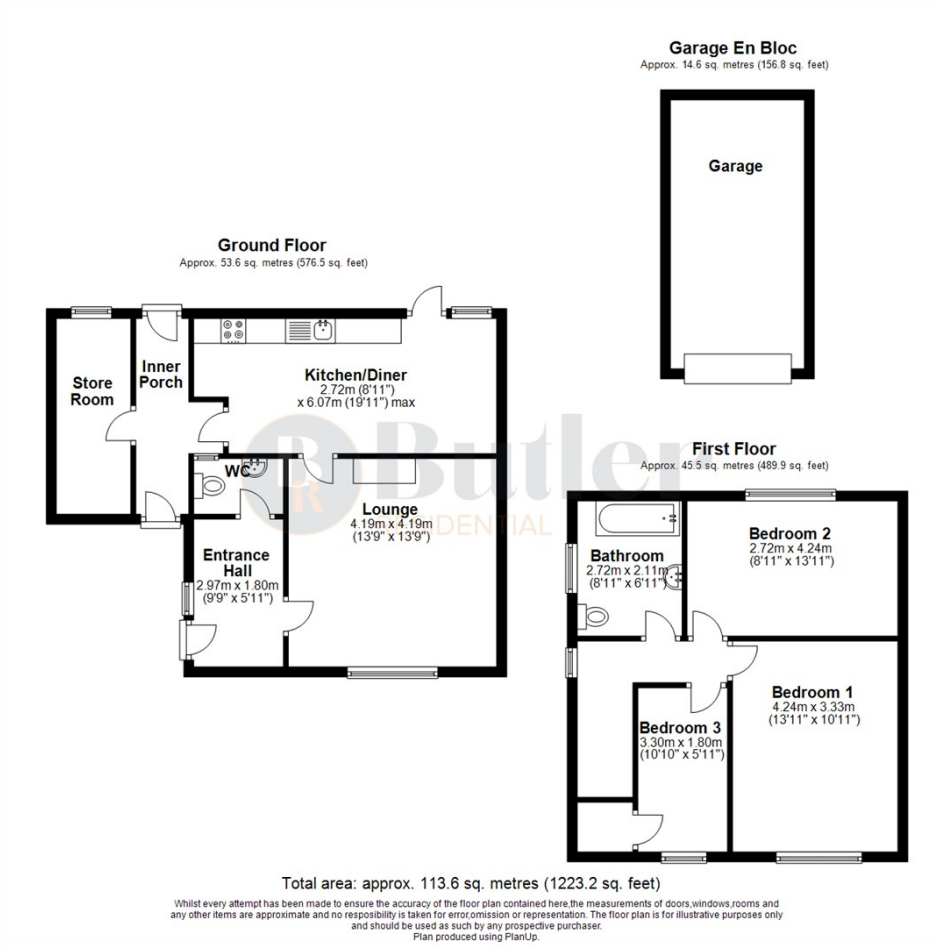

## Area Map

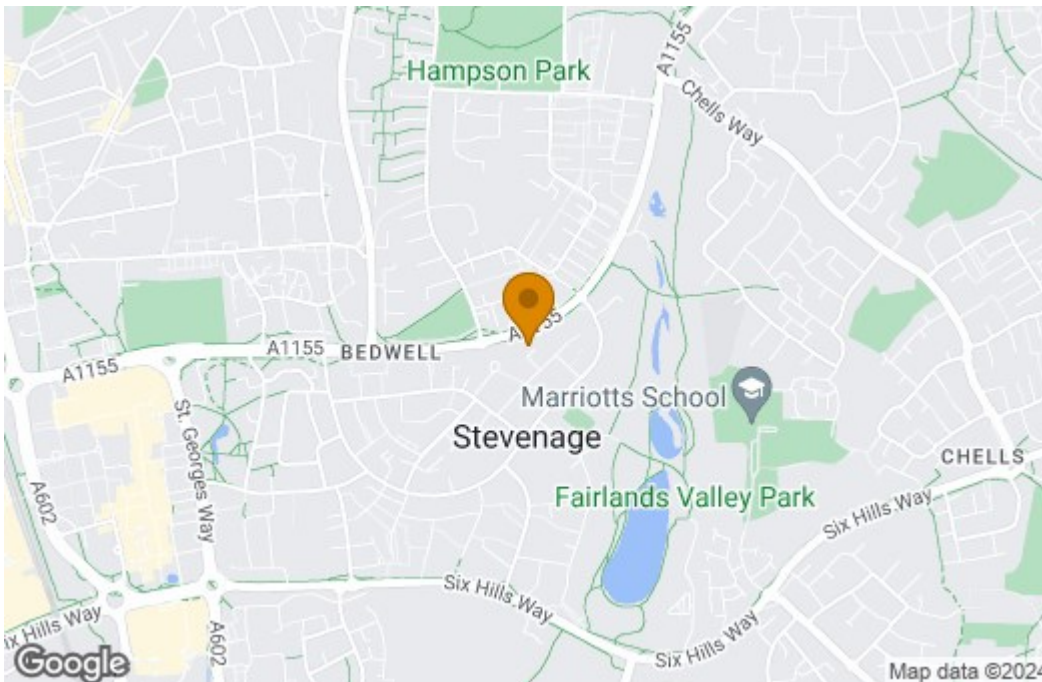

## Energy Efficiency Graph

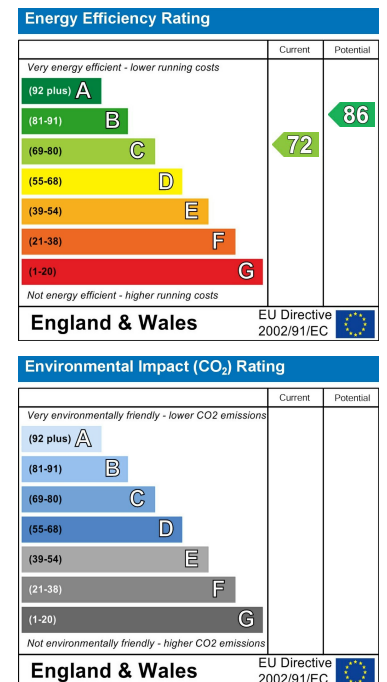

These particulars, whilst believed to be accurate are set out as a general outline only for guidance and do not constitute any part of an offer or contract. Intending purchasers should not rely on them as statements of representation of fact, but must satisfy themselves by inspection or otherwise as to their accuracy. No person in this firm's employment has the authority to make or give any representation or warranty in respect of the property.

**Address:** Suite 2, First Floor, Unit B, Balbir House Norton Green Road, Stevenage, SG1 2LP

**Tel:** 01438 584400

**Email:** hello@butlerresidential.co.uk