



NESBITT & SONS
ESTATE AGENTS



Four Acres Ingoldfield Lane, Fareham, PO17 6LF

Guide price £750,000

*** Guide Price - £750,000 to £800,000 ***

Nestled in the tranquil setting of Ingoldfield Lane, Newtown, Fareham, this remarkable four-bedroom detached bungalow offers a rare opportunity to embrace rural living while enjoying modern comforts. The property has been extensively modernised by the current owners, ensuring that it meets the highest specifications throughout.

As you step inside, you will be greeted by a bright and airy interior that seamlessly blends contemporary design with the charm of its countryside surroundings. The spacious layout provides ample room for family living, with well-proportioned bedrooms that promise restful nights and peaceful mornings.

One of the standout features of this home is the far-reaching countryside views that can be enjoyed from various vantage points within the property. These picturesque vistas create a serene backdrop, making it an ideal

Entrance Hallway



Utility Room 9'0 x 8'10 (2.74m x 2.69m)



Bedroom Four 11'7 x 7'9 (3.53m x 2.36m)



Shower Room



Study 7'9 x 5'1 (2.36m x 1.55m)



Bedroom Three

Bedroom Two

Master Bedroom 14'0 x 10'10 (4.27m x 3.30m)



Lounge 13'11 x 10'10 (4.24m x 3.30m)



Family Bathroom



Outside

Driveway

Front Garden



Rear Garden

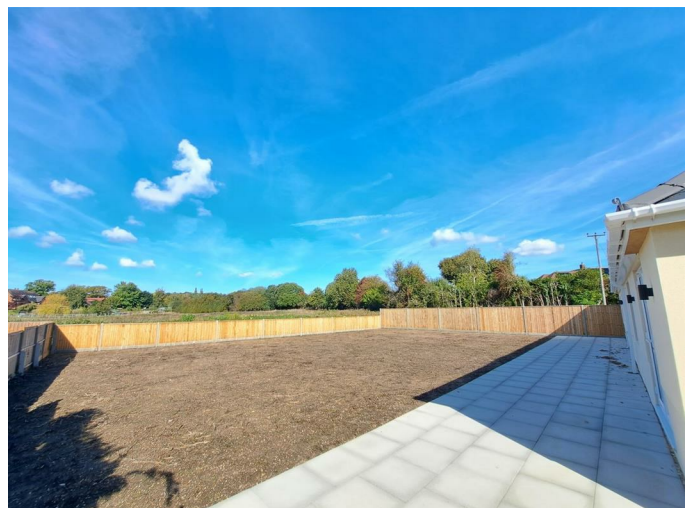

Kitchen 14'7 x 10'10 (4.45m x 3.30m)



LOCATION

Set in a rural position, with excellent local amenities and an abundance of local walkways and bridle

paths, suited to walkers, cyclists and equestrians alike. A comprehensive range of local amenities can be found in the pretty neighbouring village centres of Wickham and Bishops Waltham, both offer an excellent range of independent shops and cafés and local pubs. The Forest of Bere is just a short distance, and the M27 is also within easy reach.

Floor Plan

GROUND FLOOR

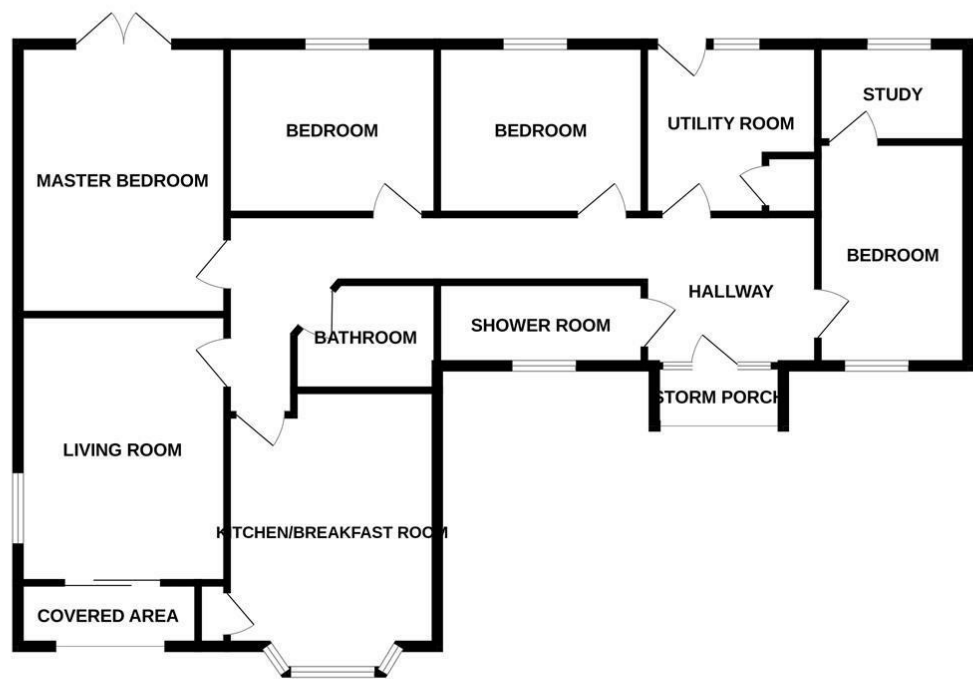

4 BEDROOM DETACHED BUNGALOW

Whilst every attempt has been made to ensure the accuracy of the floorplan contained here, measurements of doors, windows, rooms and any other items are approximate and no responsibility is taken for any error, omission or mis-statement. This plan is for illustrative purposes only and should be used as such by any prospective purchaser. The services, systems and appliances shown have not been tested and no guarantee as to their operability or efficiency can be given.
Made with Metropix ©2025

Area Map

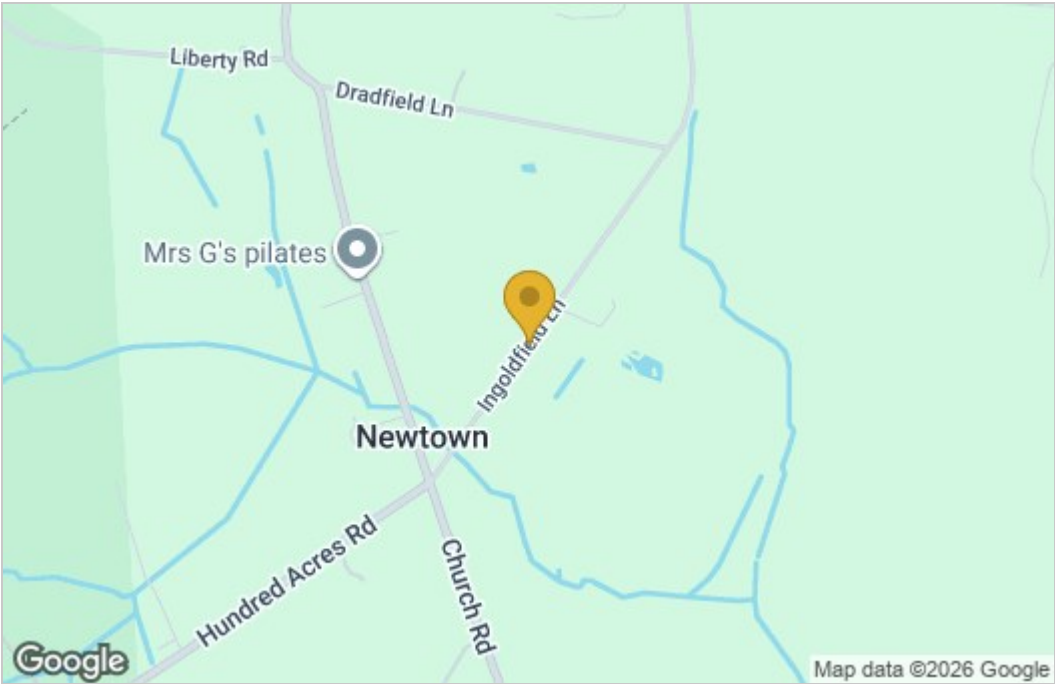

Energy Efficiency Graph

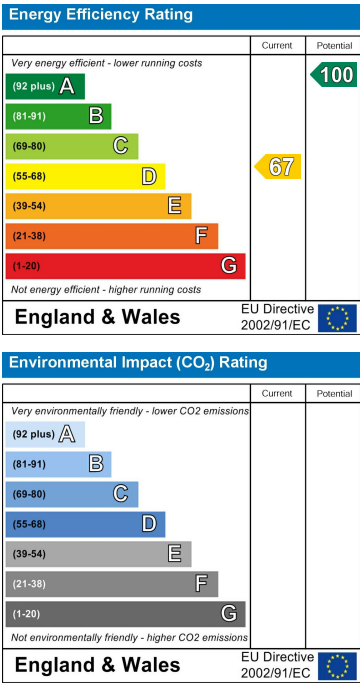

These particulars, whilst believed to be accurate are set out as a general outline only for guidance and do not constitute any part of an offer or contract. Intending purchasers should not rely on them as statements of representation of fact, but must satisfy themselves by inspection or otherwise as to their accuracy. No person in this firms employment has the authority to make or give any representation or warranty in respect of the property.