



**NESBITT & SONS**  
ESTATE AGENTS



## 68 Dartmouth Road, Portsmouth, PO3 5DU

### Offers in the region of £250,000

Situated on Dartmouth Road in the desirable area of Copnor, this charming mid-terrace house presents an excellent opportunity for first-time buyers. With three well-proportioned bedrooms, this property offers ample space for a growing family or those seeking extra room for guests or a home office.

The heart of the home is the inviting kitchen, which features double doors that open onto a lovely enclosed garden. This outdoor space is perfect for enjoying sunny days, hosting barbecues, or simply relaxing in a private setting. The garden provides a wonderful extension of the living area, ideal for both entertaining and unwinding.

The property is situated within the catchment area for Admiral Lord Nelson School, making it an attractive choice for families with children. The local amenities and transport links further enhance the appeal of this location, ensuring that you are well-connected to the wider community.

This mid-terrace house is not just a property; it is a place where memories can be made. With its combination of space, comfort, and a fantastic garden, it is an ideal first-time buy for those looking to establish themselves in a vibrant and welcoming neighbourhood. Do not miss the chance to make this delightful house your new home.



## Entrance Hallway

Lounge 14'2 into bay x 9'11 (4.32m into bay x 3.02m)



Dining Room 11'4 x 10'7 into bay (3.45m x 3.23m into bay)



Kitchen 11'4 x 8'11 (3.45m x 2.72m)



## Landing



## Bedroom One 13'2 x 11'10 (4.01m x 3.61m)



## Bedroom Two 11'4 x 8'11 (3.45m x 2.72m)



## Bedroom Three 11'8 x 8'11 (3.56m x 2.72m)



## Bathroom



## Garden



Floor Plan

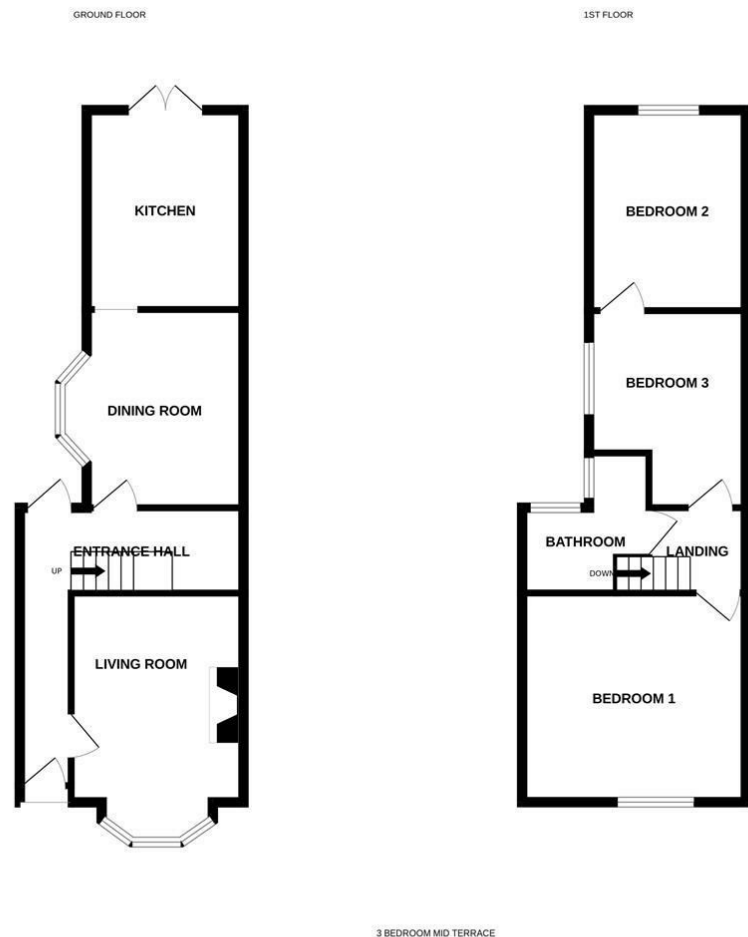

Whilst every attempt has been made to ensure the accuracy of the floorplan contained here, measurements of doors, windows, rooms and any other items are approximate and no responsibility is taken for any error, omission or mis-statement. This plan is for illustrative purposes only and should be used as such by any prospective purchaser. The services, systems and appliances shown have not been tested and no guarantee as to their operability or efficiency can be given.  
Made with Metropix C2025

Area Map

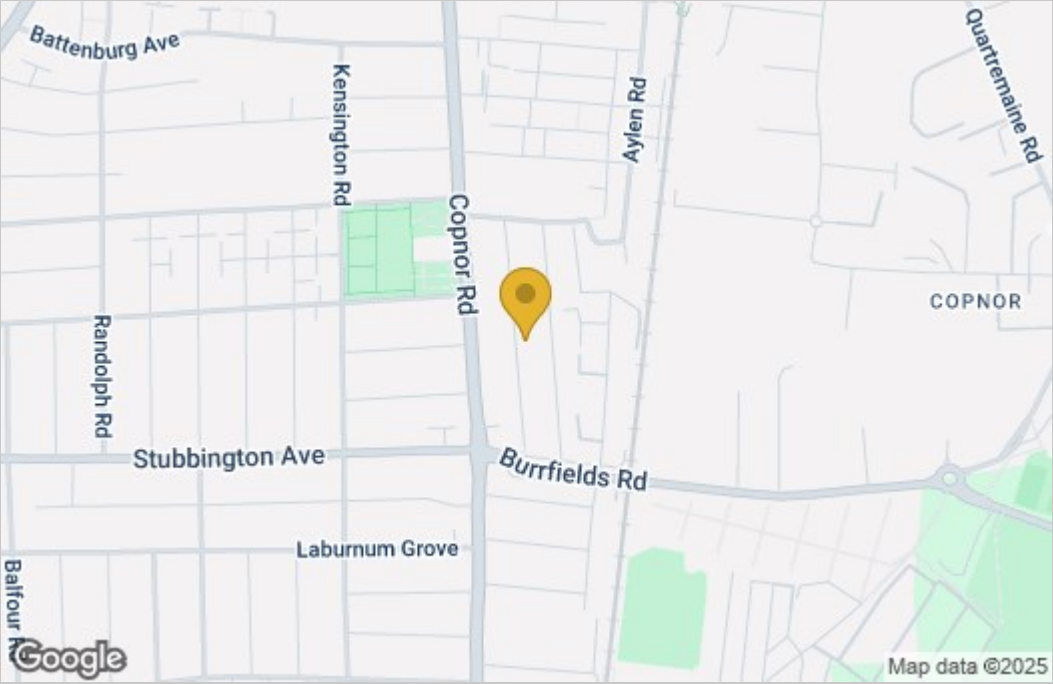

Energy Efficiency Graph

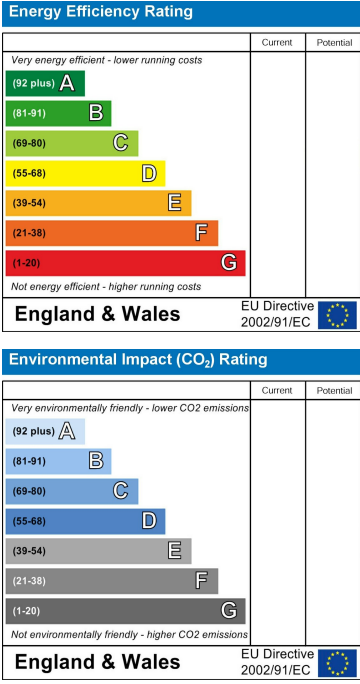

These particulars, whilst believed to be accurate are set out as a general outline only for guidance and do not constitute any part of an offer or contract. Intending purchasers should not rely on them as statements of representation of fact, but must satisfy themselves by inspection or otherwise as to their accuracy. No person in this firms employment has the authority to make or give any representation or warranty in respect of the property.