



NESBITT & SONS
ESTATE AGENTS



Flat 4 Calthorpe House 4 Searle Drive, Gosport, PO12 4WG
£175,000

This STUNNING ground floor apartment is situated in a much requested location in Priddy's Hard which is a short walk away from the picturesque shoreline and the iconic Millennium Bridge.

The property has been extensively modernised by the current owner with the internal accommodation briefly comprising of - entrance hallway, modern bathroom suite, two bedrooms and a beautiful open plan lounge/kitchen,diner.

Viewing is strongly recommended to fully appreciate the wonderful and historic location on offer here.

Communal Entrance

Entrance Hallway



Bedroom One 11'6 x 9'4 (3.51m x 2.84m)



Bedroom Two 9'4 x 7'5 (2.84m x 2.26m)



Bathroom 7'3 x 6'7 (2.21m x 2.01m)



Open Plan Kitchen/Diner/Lounge 16'4 x 14'5 (4.98m x 4.39m)



Outside

Allocated Parking Space

Floor Plan

GROUND FLOOR

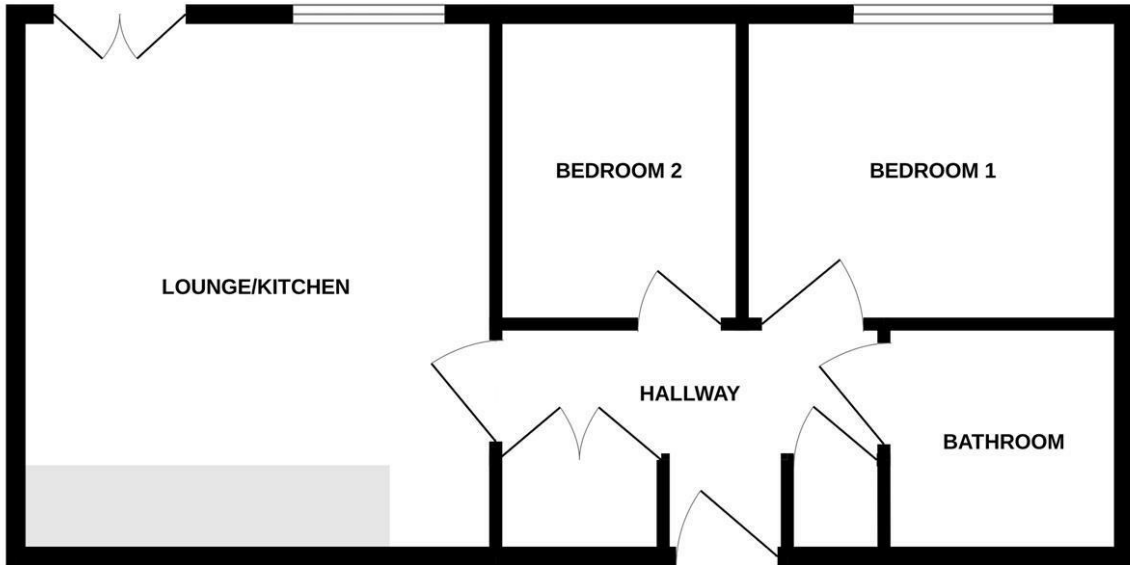

Whilst every attempt has been made to ensure the accuracy of the floorplan contained here, measurements of doors, windows, rooms and any other items are approximate and no responsibility is taken for any error, omission or mis-statement. This plan is for illustrative purposes only and should be used as such by any prospective purchaser. The services, systems and appliances shown have not been tested and no guarantee as to their operability or efficiency can be given.
Made with Metropix ©2024

Area Map

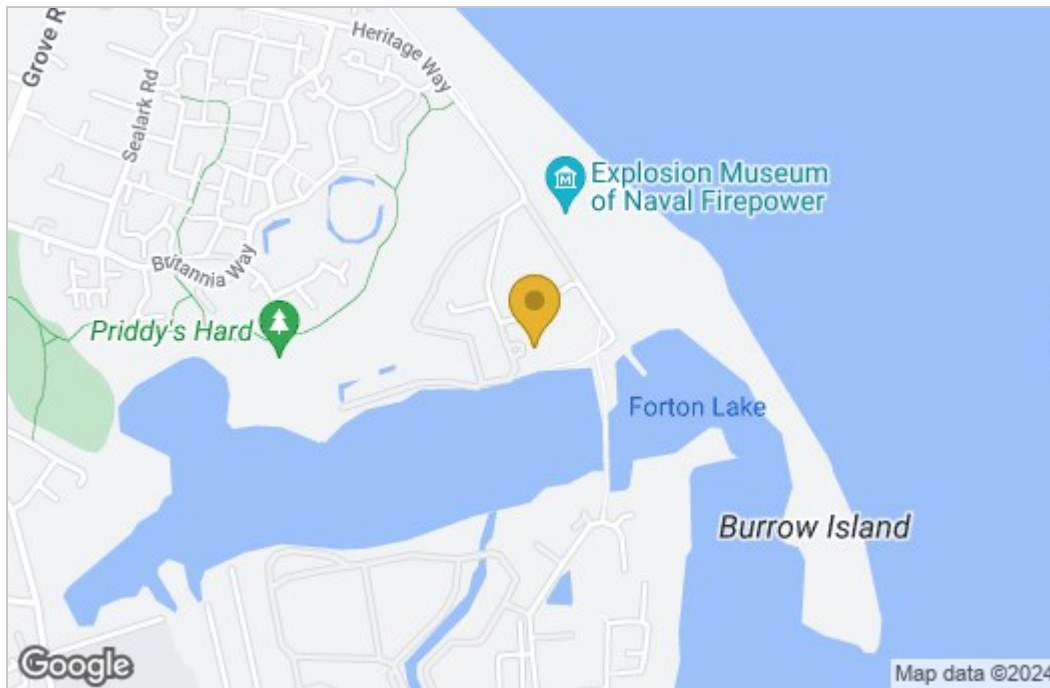

Energy Efficiency Graph

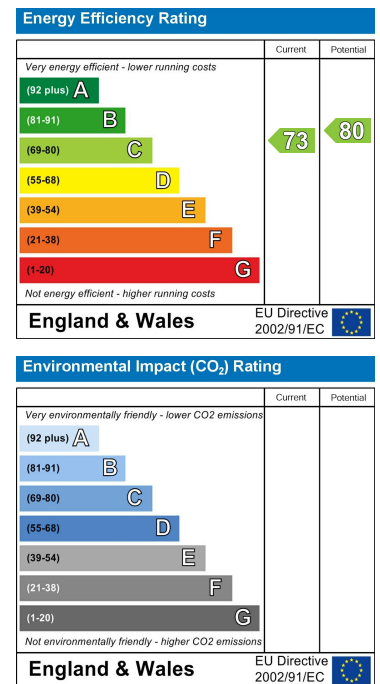

These particulars, whilst believed to be accurate are set out as a general outline only for guidance and do not constitute any part of an offer or contract. Intending purchasers should not rely on them as statements of representation of fact, but must satisfy themselves by inspection or otherwise as to their accuracy. No person in this firm's employment has the authority to make or give any representation or warranty in respect of the property.