

ALLDAY  
& MILLER

The Rise, Hillingdon, UB10 0JL  
£765,000

4 1 2 C





## The Rise, Hillingdon, UB10 0JL

**£765,000**

- Three/Four Bedrooms
- Prime Hillingdon Village Location
- Warren Built 1930's Home
- Ground Floor W.C.
- Great Potential For Further Extension
- Extended
- Semi Detached
- Large 90ft Rear Garden
- Spacious Driveway
- Through Lounge With Solid Parquet Floors



## Description

This charming house comprises of an inviting reception/ dining room, a downstairs bedroom and a convenient WC and a modern fitted kitchen.

Rising to the first floor, you will discover three well proportioned bedrooms, two of which are enhanced by fitted wardrobes, offering plenty of storage space. The family bathroom completes this level.

Outside, the property boasts a front drive, providing off-street parking. The rear garden is a delightful private space, ideal for dining and entertainment.

## Situation

The Rise just a short distance to a number of local amenities including local shops, bus/road links, Brunel University, Hillingdon Hospital, Hillingdon golf and cricket club, Stockley Park and a number of schools including Bishopshalt senior school. Uxbridge town centre with its variety of shops, bars, restaurants and Metropolitan/Piccadilly line train station is located just under a mile away. The A40/M40 and M4 are a short drive away offering access to Heathrow, London and the Home Counties.





## Floor Plans

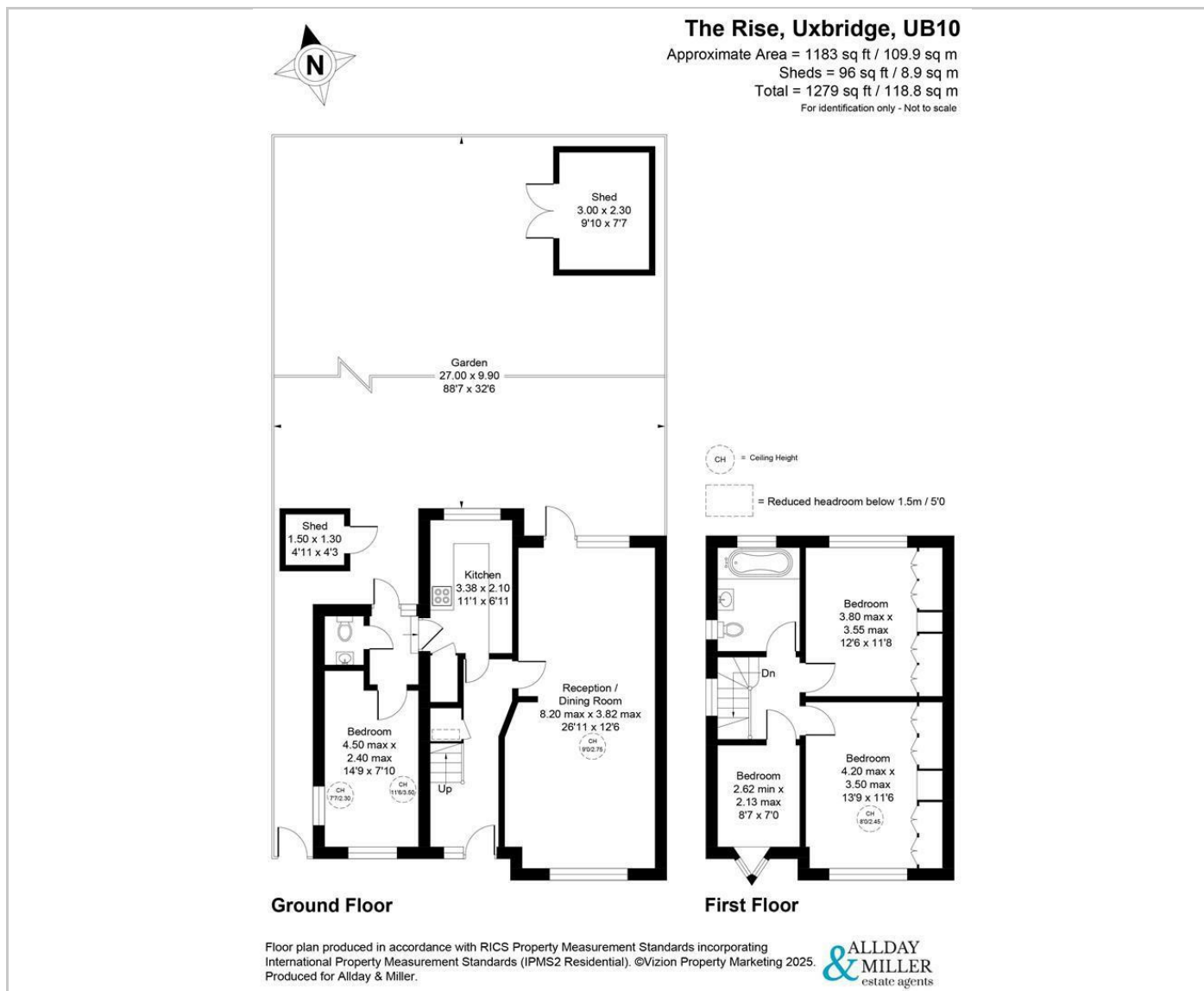

## Area Map

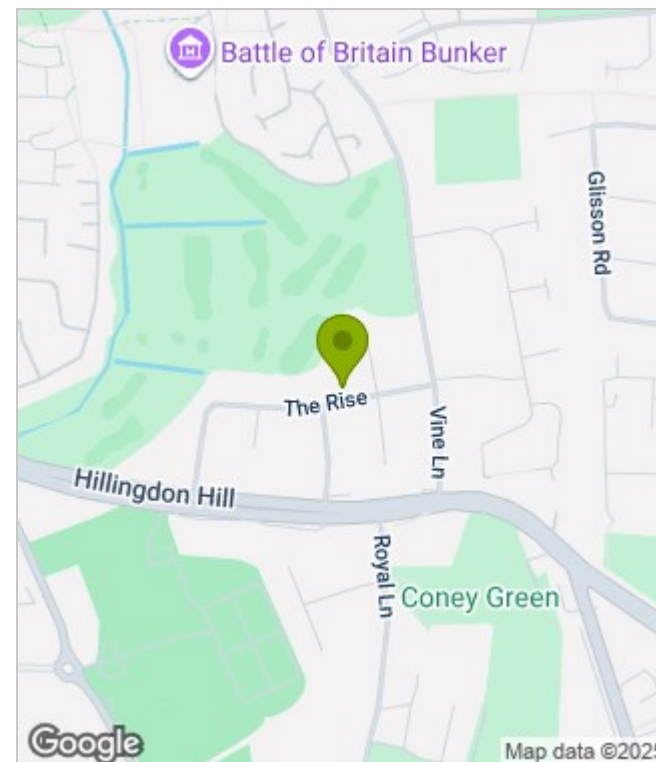

## Energy Performance Graph

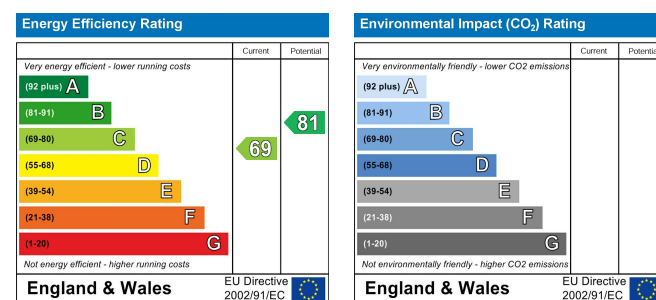

These particulars, whilst believed to be accurate are set out as a general outline only for guidance and do not constitute any part of an offer or contract. Intending purchasers should not rely on them as statements of representation of fact, but must satisfy themselves by inspection or otherwise as to their accuracy. No person in this firm's employment has the authority to make or give any representation or warranty in respect of the property.